





# Gepäckbrücke YAMAHA XT 600

GPB.06.239.100

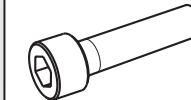

<p><b>1</b> Gepäckbrücke Carrier</p>  <p>GPB.06.239.001</p> <p>Anzahl/ Pcs. 1</p>	<p><b>4</b> Gummischeibe Rubberelement</p>  <p>Da=25 Di=13 h=3</p> <p>Anzahl/ Pcs. 4</p>
<p><b>2</b> Distanzbuchse Distance</p>  <p>Da=13 Di=8,4 h=10</p> <p>Anzahl/ Pcs. 1</p>	<p><b>5</b> Unterlegscheibe Washer</p>  <p>A 8,4 DIN 125</p> <p>Anzahl/ Pcs. 4</p>
<p><b>3</b> Distanzbuchse Distance</p>  <p>Da=13 Di=8,4 h=7</p> <p>Anzahl/ Pcs. 1</p>	<p><b>6</b> Zylinderschraube mit Innensechskant Hexagon Socket Screw</p>  <p>M8 x 50 DIN 912</p> <p>Anzahl/ Pcs. 4</p>

nur auf linker Seite montieren  
just to mount on left side

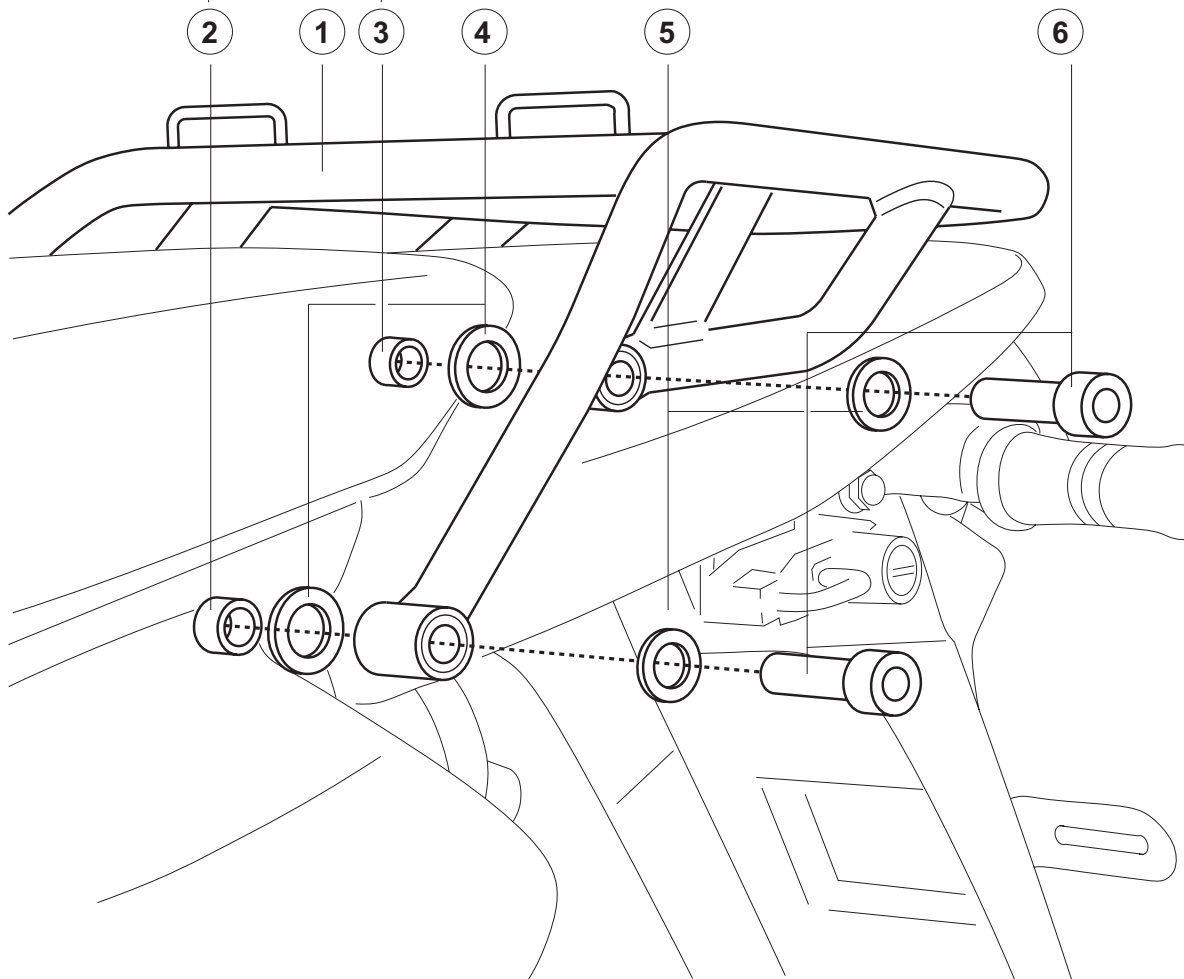

SW-MOTECH  
GmbH&Co.KG  
Auf der Neustadt 16  
35282 Rauschenberg

tel ++49(0) 6425 820280  
fax ++49(0) 6425 820281

[www.mo-tech.de](http://www.mo-tech.de)