

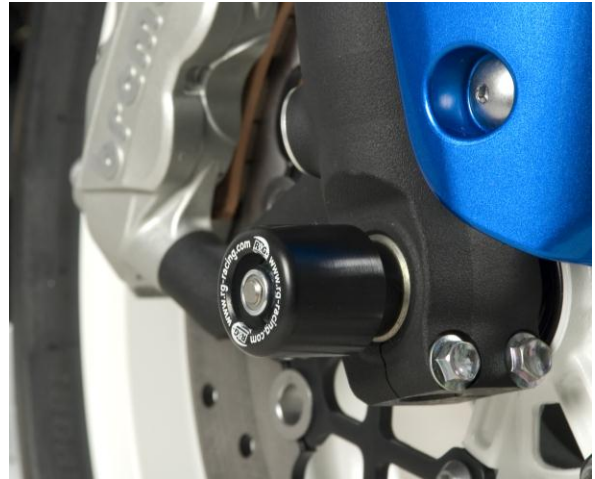

FITTING INSTRUCTIONS FOR FP0101 FORK-PROTECTORS
SUZUKI GSX-R600 2011



THIS KIT CONTAINS THE ITEMS PICTURED AND LABELLED BELOW.
DO NOT PROCEED UNTIL YOU ARE SURE ALL PARTS ARE PRESENT.

Please note that the way the kit is packed does not necessarily represent the way of mounting to the bike.

THE PARTS SHOWN MAY BE REPRESENTATIVE ONLY (FOR CLARITY OF INSTRUCTIONS ONLY)

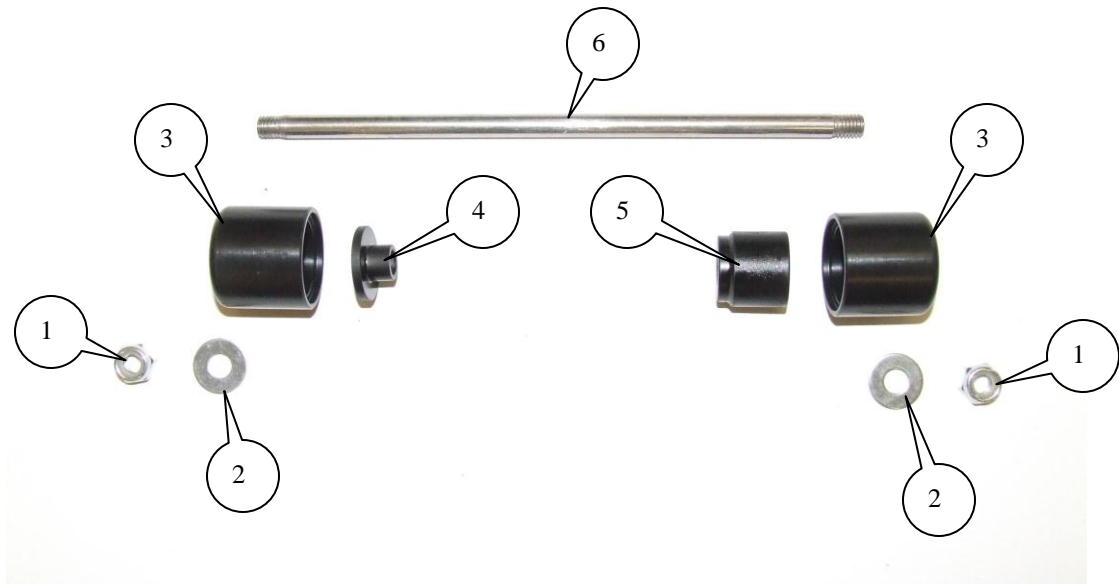



LEGEND

- ITEM 1 = M8 NYLOC NUTS (x2).
ITEM 2 = M8 WASHERS (19mm OUTSIDE DIAMETER) (x2).
ITEM 3 = CRASH PROTECTORS (B0445 M) (x2).
ITEM 4 = LEFT-HAND SPACER (S0432) (x1).
ITEM 5 = RIGHT-HAND SPACER (S0433) (x1).
ITEM 6 = SPINDLE BAR (SB0009) (x1) (315mm LONG)

Please note that in cases where kits are packed with rubber washers holding the components onto the bolt – *the rubber washers should be thrown away!*

TOOLS REQUIRED

- TWO 13mm A/F SOCKETS AND WRENCHES.

FITTING INSTRUCTIONS

- PLACE SMALLER SPACER (S0432) INTO LEFT-HAND FRONT SPINDLE.
- PLACE LARGER SPACER (S0433) INTO RIGHT-HAND FRONT SPINDLE.
- FEED SPINDLE-BAR (SB009) THROUGH SPACERS IN FRONT SPINDLE.
- FIT BOTH CRASH-PROTECTORS OVER EITHER END OF SPINDLE BAR.
- FIT WASHERS AND NYLOC NUTS ONTO EITHER END OF SPINDLE BAR.
- TIGHTEN UNTIL BOTH NUTS ARE ENGAGED IN NYLON AND EQUAL AMOUNTS PROTRUDE FROM EITHER SIDE. DO NOT OVER-TIGHTEN—THE NYLOC NUTS WILL HOLD IT TIGHT.

ISSUE 1 02/03/2011 (NSY)

CONSUMER NOTICE

The catalogue description and any exhibition of samples are only broad indications of the Products and R&G may make design changes which do not diminish their performance or visual appeal and supplying them in such state shall conform to the order. The Buyer acknowledges no representation or warranty (other than as to title) has been given or will apply to the Products other than those in R&G's order or confirmation and the Buyer confirms it has chosen the Products as being of merchantable quality and suitable for its particular purposes. Where R&G fits the Products or undertakes other services it shall exercise reasonable skill and care and rectify any fault free of charge unless the workmanship has been disturbed. The Buyer is responsible for ensuring that the warranty on the motorcycle is not affected by the fitting of the Products. On return of any defective Products R&G shall at its option either supply a replacement or refund the purchase money but shall not be liable if the Products have been modified or used or maintained otherwise than in accordance with R&G's or manufacturer's instructions and good engineering practice or if the defect arises from accident or neglect. Other than identified above and subject to R&G not limiting its liability for causing death and personal injury, it shall not be liable for indirect or consequential loss and otherwise its liability shall be limited to the amounts paid by the Buyer for the Products or the fitting or service concerned. These terms do not affect the Buyer's statutory rights.

R&G RACING RETURNS POLICY (NON-FAULTY GOODS)

Returns must be pre-authorized (if not pre-authorized the return will be rejected). Goods may only be returned direct to us if they were purchased direct from us (customer must prove if necessary). Otherwise to be returned to original vendor. Goods must be in re-sellable condition, in the opinion of R&G Racing. All returns are subject to a 25% restocking and handling fee (25% of the gross value exc. P&P – at the prevailing price at time of purchase). The customer must pay any and all carriage charges. No returns of discontinued products, unless within 14 days of purchase. This policy does not affect your statutory rights and does not refer to faulty goods.

R&G Racing

Unit 1, Shelley's Lane, East Worldham, Alton, Hampshire, GU34 3AQ

Tel: +44 (0)1420 89007 Fax: +44 (0)1420 87301 www.rg-racing.com Email: info@rg-racing.com



FRANCE
INSTRUCTIONS DE MONTAGE DE LA PROTECTION DE FOURCHE
FP0101 SUZUKI GSX-R600 2011

LA PRESENTATION DES PIECES R&G DANS L'EMBALLAGE N'EST PAS TOUJOURS IDENTIQUE AU SENS DE MONTAGE.

Merci de noter que dans le cas où les protections sont assemblées avec une bague en caoutchouc, merci de bien vouloir le retirer lors du montage des pièces sur la moto, Ne pas commencer le montage des pièces s'il manque une ou plusieurs pièces.

LEGENDE

- ART 1 = ECROUS M8 (x2).
- ART 2 = RONDELLES M8 (Diam Ext 19mm) (x2).
- ART 3 = TAMPONS DE PROTECTION (B0445 M) (x2).
- ART 4 = ENTRETOISE COTE GAUCHE (S0432) (x1).
- ART 5 = ENTRETOISE COTE DROIT (S0433) (x1).
- ART 6 = AXE (SB0009) (x1) (315mm LONG)

OUTILS NECESSAIRES

- 2 clefs de 13 mm.

INSTRUCTIONS

- Placez les entretoises sur la moto.
La plus petite (S0432) dans le côté gauche de l'axe de roue avant.
La plus grande (S0433) dans le côté droit de l'axe de roue avant.
- Glissez l'axe R&G à travers l'axe de roue avant et à travers les 2 entretoises.
- Placez les tampons de protection sur l'axe R&G contre les entretoises.
- Glissez une rondelle contre les tampons.
- Placez ensuite un écrou de chaque côté de l'axe.
- Vissez à la main les écrous le plus possible et terminez le serrage à l'aide des deux clefs de 13 mm. Ne pas serrez trop fortement, la protection sera maintenue grâce aux écrous autobloquants.
- Vérifiez régulièrement le serrage des écrous.