

PARAMANOS PARA - HANDPROTECTOR FOR - HANDSCHUTZ FÜR BMW G650GS '11-

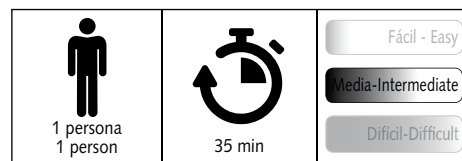

Ref.: 8937

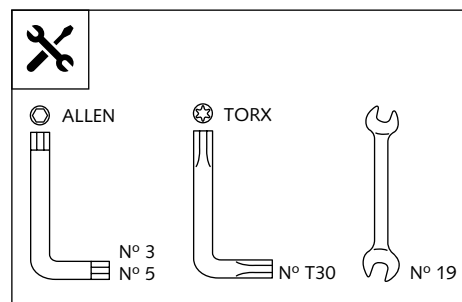

ID.	PIEZA / PART	DESCRIPCIÓN	DESCRIPTION	QTY.
1		Paramanos derecho	Right handguard	1
2		Pieza derecha anclaje manillar Ø26.5 (se suministra montada)	Ø26.5 right handlebar anchoring part (supplied mounted with handguard)	1
3		Paramanos izquierdo	Left handguard	1
4		Pieza izquierda anclaje manillar Ø26.5 (se suministra montada)	Ø26.5 left handlebar anchoring part (supplied mounted with handguard)	1
5		Soporte metálico derecho (R)	(R) Right metal support	1
6		Soporte metálico izquierdo (L)	(L) Left metal support	1
7		Tornillo Allen M6X50 DIN912	M6X50 DIN912 Allen screw	2
8		Arandela de goma Øint 4,5 Øext 11x2 (se suministra montada con las piezas 1-2-3-4)	Øinner 4,5 Øouter 11x2 rubber washer (supplied already mounted on items 1-2-3-4)	4
9		Tornillo Allen M5x11 Ø11 ISO 7380	M5x11 Ø11 ISO 7380 Allen screw	6
10		Arandela de Nylon M5X1 (se suministra montada con las piezas 1-2-3-4)	M5X1 Nylon washer (supplied already mounted on items 1-2-3-4)	6
11		Tuerca grafilada M5 (se suministra montada con las piezas 1-2-3-4)	M5 Special nut (supplied already mounted on items 1-2-3-4)	4
12		Arandela de goma Øint 4,5 Øext 14x4	Øinner 4,5 Øouter 14x4 Rubber washer	2
13		Casquillo de coleteaje Øint 6,5 Øext 33x12mm	Øinner 6,5 Øouter 33x12 customized spacer	2
14		Junta tórica Ø25x3	Ø25x3 O-Ring	2
15		Tapón tornillo M5 ISO 7380	M5 ISO 7380 Allen screw cap	6
16		Kit adhesivos	Stickers set	1

PARAMANOS PARA - HANDPROTECTOR FOR - HANDSCHUTZ FÜR
BMW G650GS '11-

INSTRUCCIONES DE MONTAJE - MOUNTING INSTRUCTIONS - MONTAGEANLEITUNG

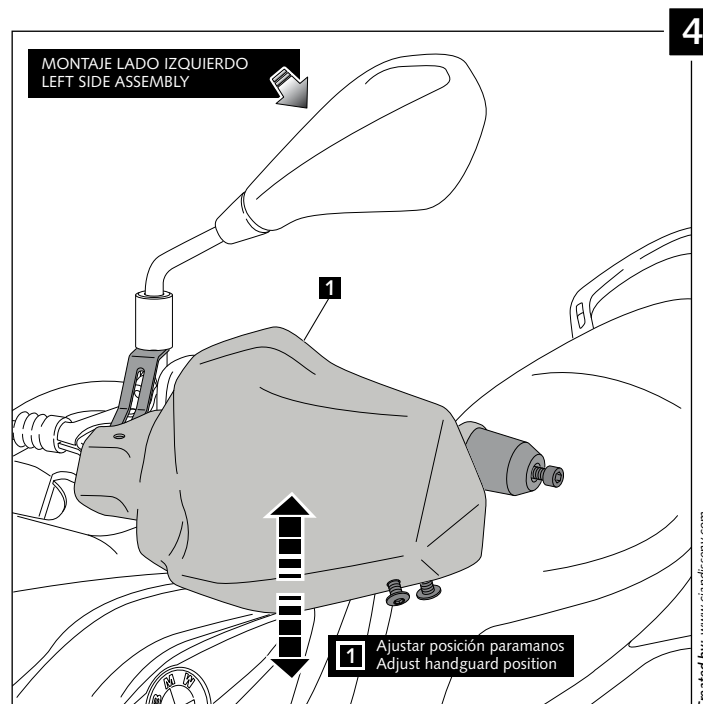
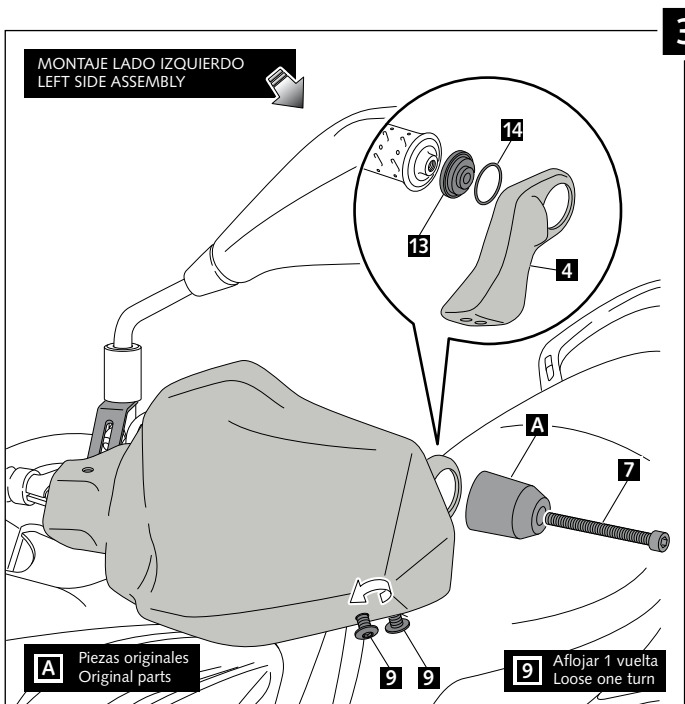
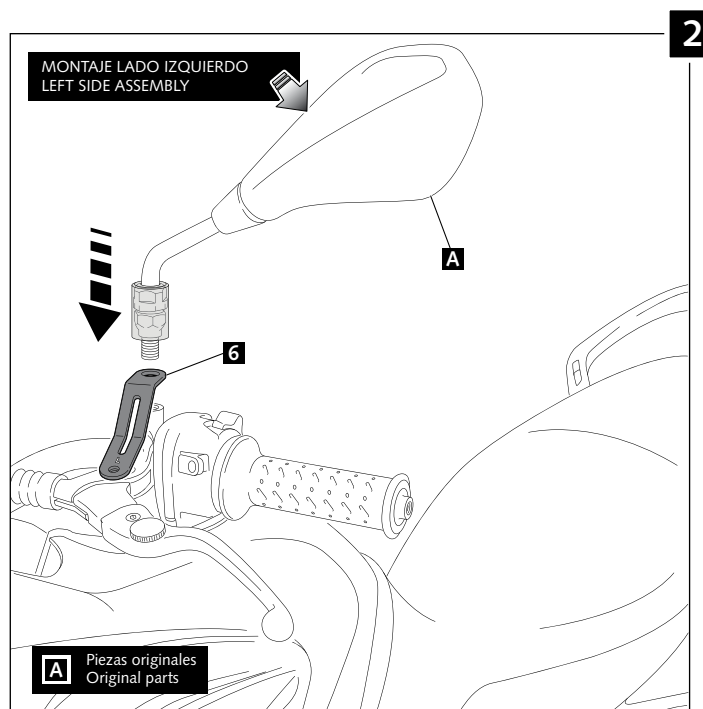
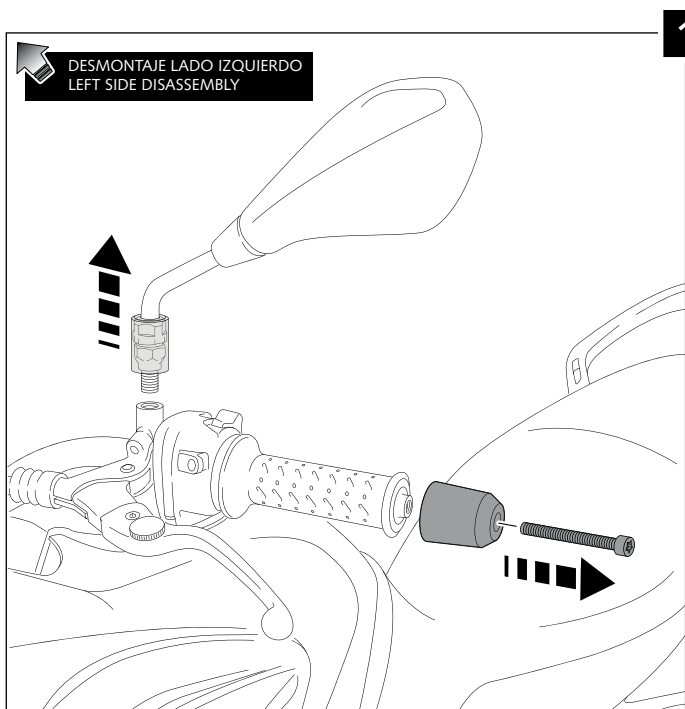

PARAMANOS PARA - HANDPROTECTOR FOR - HANDSCHUTZ FÜR BMW G650GS '11-

INSTRUCCIONES DE MONTAJE - MOUNTING INSTRUCTIONS - MONTAGEANLEITUNG

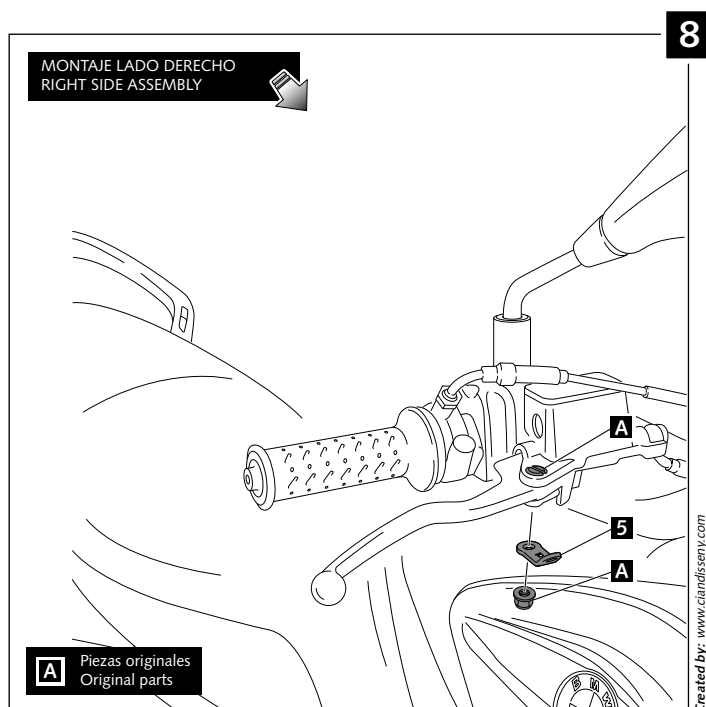
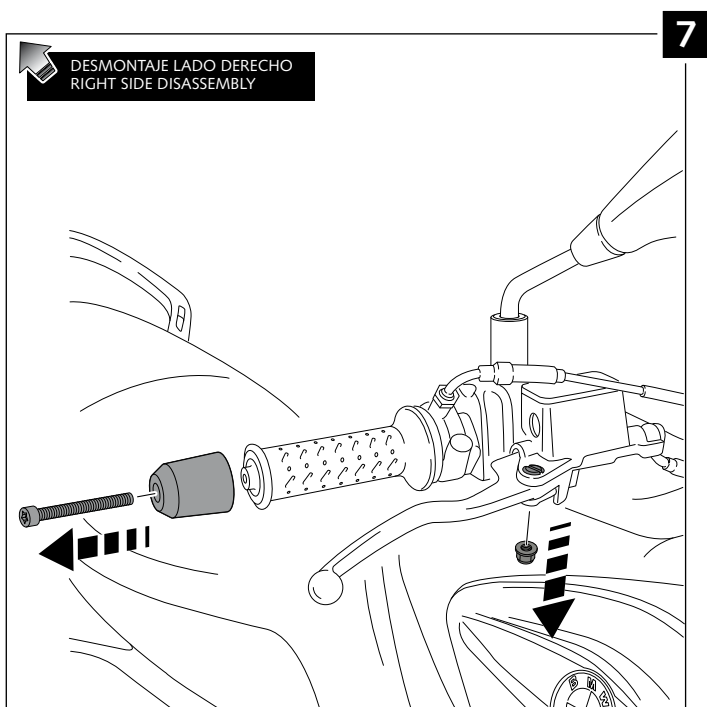
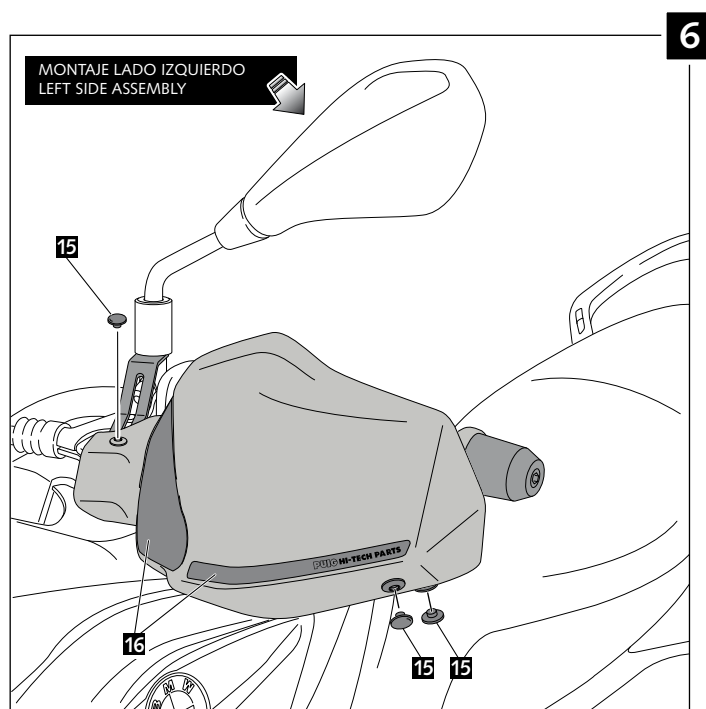
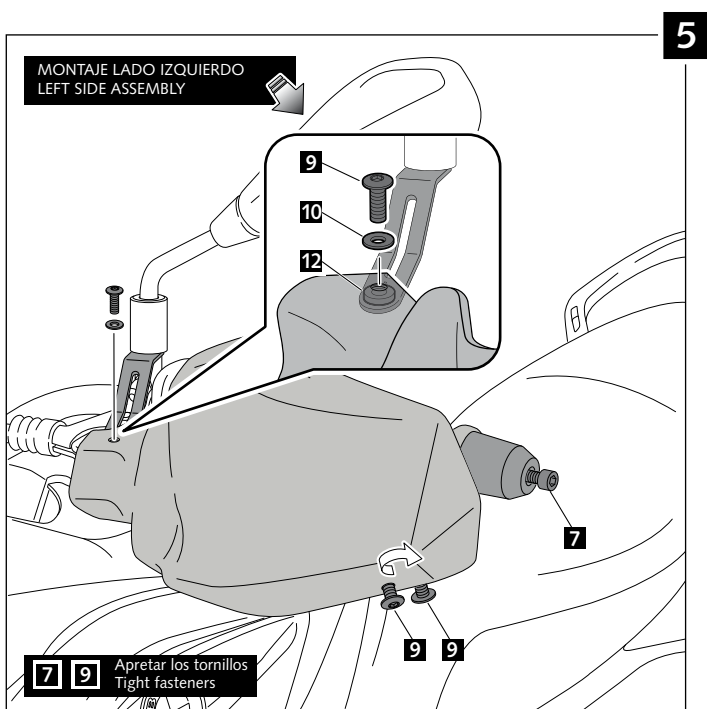

PARAMANOS PARA - HANDPROTECTOR FOR - HANDSCHUTZ FÜR
BMW G650GS '11-

INSTRUCCIONES DE MONTAJE - MOUNTING INSTRUCTIONS - MONTAGEANLEITUNG

