

INSTALLATION INSTRUCTIONS

Honda CBR1100XX

1997-2007

P/N: HB01025

***IMPORTANT:
PLEASE GIVE CUSTOMER ENCLOSED INFORMATION!***



Thank you for your purchase of our HeliBars®. They are designed to increase your long distance comfort and improve the handling of your sport motorcycle, and we feel confident you will enjoy them.

Your HeliBars are designed to fit your motorcycle with little to no modifications needed to your stock cables and hydraulic lines. In order to achieve this fit, we do not simply increase the height at the fork tube/triple clamp area. If we were to mirror the angle of your stock handlebars, the HeliBars would not fit and clear your stock equipment, and lock to lock steering clearance would be impossible.

If you hold up the HeliBars and compare it to your stock handlebar, the difference may not be readily evident. One test we can suggest is to take your stock handlebar, and the corresponding HeliBars, and set them both on a flat surface. You can see the angle difference. Then install the left HeliBars, following the instructions. Walk around the front of your bike and look through the windshield. You should see a noticeable difference between your stock handlebar and the HeliBars. Finish the installation, and try them out. We think you'll like them!

HeliBars INSTALLATION

**IMPROPER INSTALLATION COULD RESULT IN SERIOUS INJURY OR DEATH.
HAVE A QUALIFIED MECHANIC INSTALL YOUR HeliBars.**

IF WE HAVE NOT INCLUDED SPECIFIC INSTRUCTIONS FOR YOUR MOTORCYCLE, THEN THE INSTALLATION IS SIMPLY A REVERSAL OF THE DISASSEMBLY PROCESS. **NOTE THE LOCATION OF LINES AND CABLES. BE SURE TO CLEAN THE FORK TUBES BEFORE INSTALLATION!!

!! CAUTION !! MAKE SURE THE HeliBars ARE FULLY SEATED. TIGHTEN BAR END DAMPER WEIGHTS FIRMLY. AFTER INSTALLATION, MOVE BARS LOCK TO LOCK AND CHECK CLEARANCE OF: 1.CABLES 2. HYDRAULIC LINES 3.WIRES 4.FAIRING 5.FUEL TANK. TORQUE ALL HARDWARE TO MANUFACTURER'S SPECIFICATIONS.

IF YOU HAVE INSTALLATION QUESTIONS, PLEASE CALL 1-800-859-4642.

HELI MODIFIED, INC. ASSUMES NO LIABILITY FOR ANY INJURY OR LOSS OF PROPERTY WHICH MAY RESULT FROM IMPROPER INSTALLATION OR USE OF ANY HeliBars.



WARRANTY / RETURN POLICY

We make every effort to build a quality product so you can fully enjoy your riding experience. Thank you for your order.

HeliBars® may be returned for defects in materials and workmanship within one year from the date of shipment to the original purchaser, in which event the purchaser may receive a replacement set of HeliBars.

If within thirty (30) days of the shipping date you are not satisfied for any reason, you can return the HeliBars. Return policy is valid for original purchaser only. If HeliBars are purchased from a vendor other than Heli Modified, Inc., customer must contact vendor where purchased regarding returns. Refund will be extended to original purchaser only. There are no other warranties which extend beyond this.

Conditions of this 30 day return policy:

1. Bars must not be used as a tie down point. (See attached 'Trailer Instructions').
2. Bars cannot be damaged, dented, or altered in any way.
3. Bars cannot be overtorqued.
4. Refund will be for product purchase price only, and credited to original purchaser only.
5. Product must be returned with all original equipment, documents and in original packaging. There must be no physical damage caused by the customer or by carrier.
6. A Return Authorization Number must be obtained from us before you return the product.

We reserve the right to charge a re-stocking fee of up to 25% if the above criteria are not met.

THERE ARE NO FURTHER EXPRESS OR IMPLIED WARRANTIES INCLUDING, BUT NOT LIMITED TO, IMPLIED WARRANTIES OF MERCHANTABILITY OR FITNESS FOR A PARTICULAR PURPOSE. By accepting this product, the consumer agrees to arbitrate and litigate any controversy in the State of Maine, and under the laws of the State of Maine.

HELI MODIFIED INC. ASSUMES NO LIABILITY FOR ANY INJURY OR LOSS OF PROPERTY WHICH RESULT FROM IMPROPER INSTALLATION OR USE OF ANY HELI BARS. ALL HELI MODIFIED, INC. PRODUCTS SHOULD BE INSTALLED BY A QUALIFIED MECHANIC. IMPROPER INSTALLATION MAY CAUSE DEATH OR INJURY.

Ride Safe and Enjoy!





1997-2007 Honda CBR1100XX Part # HB01025
Installation Instructions
1 5/8" taller ~ 1" more rearward ~ 1 1/2" Wider at 27"

**WARNING: IMPROPER INSTALLATION COULD RESULT IN SERIOUS INJURY OR DEATH.
HAVE A QUALIFIED MECHANIC INSTALL YOUR HELIBARS®.**

Please note that your HeliBars are clearly marked with an L & R on the bottom of the clamping lug to differentiate between the left and right bar.

1. Before stock bars are removed, it is necessary to rotate the clutch and front brake hydraulic lines forward at the master cylinders. To do this, you must first remove the aluminum tabs that positively locate the hydraulic lines at the banjo fittings. This can be accomplished by the careful use of a hand-held hacksaw blade, or a Dremel tool with a small cut-off blade. Take your time on the clutch master cylinder, only the forward tab need be removed. Only remove enough of the tab to allow the banjo fitting to rotate past its location.
2. After the tabs are removed, loosen the banjo bolts just enough to rotate the hydraulic line forward 3/8 inch, measured at the lower end of the steel banjo fitting. **!!REMEMBER TO RETIGHTEN!!**
3. Installation is simply a reversal of the disassembly process. Remove the factory circlip from the top of the fork tube (above the stock clip-ons.) They will not be re-used. (Be sure the fork tubes are cleaned before installation.)
4. Remove the damper units from the stock bars. Carefully place the factory clip on bar tube in a vise with soft jaws and a rag. Reinstall the damper weight and tighten. Hold onto the damper weight with one hand. While pulling out and twisting, depress the two tabs one at a time, until they move past their locating holes. Continue pulling and twisting until the damper unit comes out. Repeat procedure on the other stock bar. Clean the damper rubbers and damper units. Reinstall the units into the HeliBar. We recommend that you use a bit of rubbing alcohol as a lubricant to reinstall the units. With the damper weight still attached to the damper unit, carefully start the first rubber bushings into the HeliBar. Push and twist until the second set of bushings are ready to install. Align the two tabs with the two holes in the HeliBar. Press them into the HeliBar making sure the entire edge of the outer bushing is entering the tube, and press in until the tab enters the two holes. Pull

back out until the bars are against the rear edge of the holes.

CAUTION: If the damper units are installed too deeply, the damper weight will interfere with the throttle housing.

5. After installation, but before torquing, move bars lock to lock and check clearance of cables, hydraulic lines, wires, fairings, and fuel tank. Adjust bars for the best comfort and be sure to leave enough clearance for your hands when the bars are moved all the way to the left and right steering stops. Mirror left and right HeliBars by going to full right steering stop, measure from the center of the damper weight screw to the fuel tank. Adjust left side to obtain the same measurement.

6. Torque the two 8mm socket head cap screws to 16ft. lbs. (Using 6mm hex dr.)

!! CAUTION !! TO KEEP THE BARS FROM ROTATING, IT IS ABSOLUTELY IMPERATIVE THAT THE PINCH BOLTS BE TORQUED TO 16 FT. LBS. DO NOT OVERTIGHTEN! OVERTIGHTENED HARDWARE CAN LOSE INTEGRITY.

!! CAUTION!! BARS MUST BE TORQUED TO SPECIFIED VALUES. THEY MUST NOT BE OVER TORQUED. OVERTIGHTENED HARDWARE CAN LOSE INTEGRITY.

For questions regarding installation please call 1-800-859-4642.

HELI MODIFIED, INC. ASSUMES NO LIABILITY FOR ANY INJURY OR LOSS OF PROPERTY WHICH MAY RESULT IN IMPROPER USE OF ANY HELI BARS.



Diagram shows a stock CBR1000RR Bar Assembly. The damper assembly is made up of Numbers 8, 10, 11 and 12. The damper assembly must be removed and used in your HeliBars.

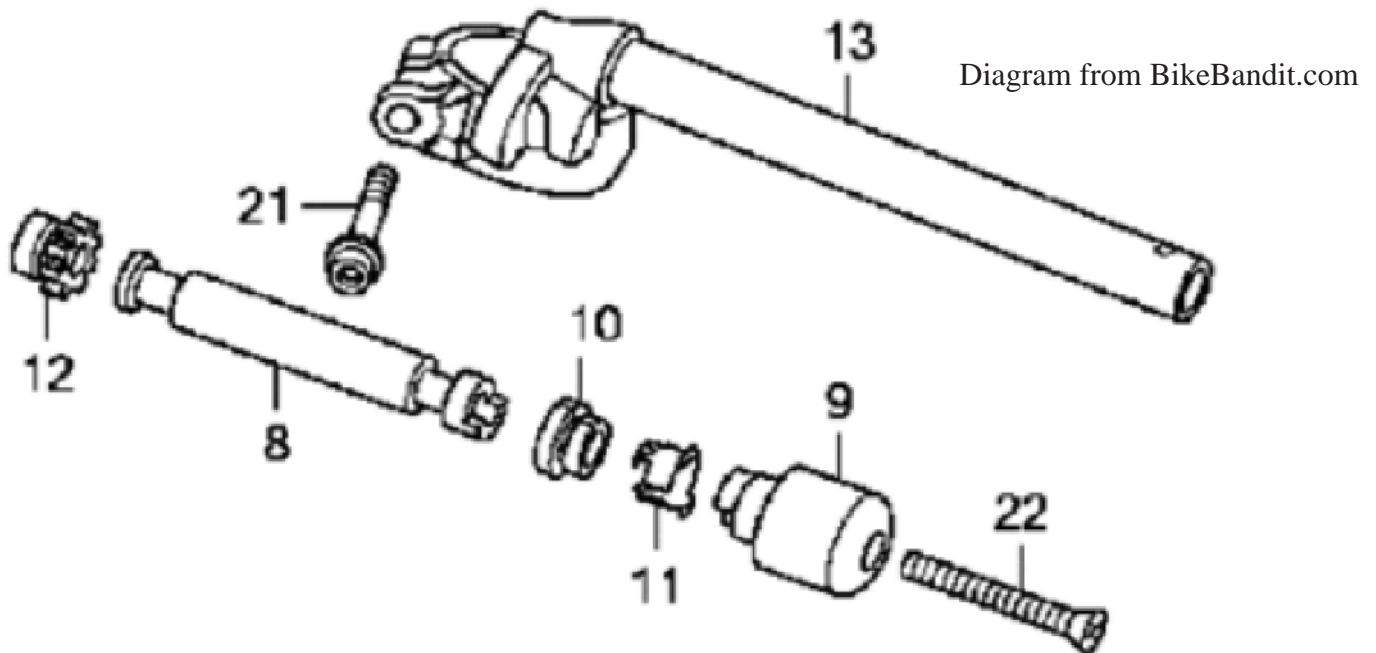

Removing Damper Units from Stock Handlebar(s)

We recommend that you use some rubbing alcohol to help release the rubber bushings from the inside of the tube. Run some alcohol into the control locking pinhole and into the bar end, and distribute in all directions.

Carefully place the bar in a vise with soft jaws and a rag. Reinstall the damper weight and tighten, making sure the ridge on the weight is properly engaged with the corresponding ridge on the damper unit. Hold onto the weight with one hand. While pulling out and twisting, depress the two retaining tabs on either side one at a time until they move past their locating holes. Continue pulling and twisting until the damper comes out (Note: there is an "o" ring on the inner end of the damper shaft that can be rubbed off inside the tube when pulling). Just shake it out. Repeat this procedure for the other side.

Clean the damper rubbers and shafts, and reinstall into the Heli Bars. Use a bit of rubbing alcohol as a lubricant to ease installation. With the damper weight still attached, carefully start the first rubber bushing into the bar. Push and twist until the set of two bushings is ready to go in. Align the tabs on the retainer ring with the locating holes in the Heli Bar. Continue pushing in, making sure that the outer edge of the last bushing enters the tube evenly. Press in until the tabs enter the two holes. If necessary, pull back out a bit until the tabs are against the rear edges of the holes.

CAUTION: If the right-hand unit is installed too deeply, the damper weight will interfere with throttle operation. The threaded end of the damper unit will be about flush with the tube end, but the ridge that engages the weight will protrude.

Once each unit is installed, remove the damper weight.



IMPORTANT INFORMATION ABOUT POWDER COATED HELIBARS

HeliBars® are finished with a polyester powder coating from Morton Powder Coating Company (www.mortonpowder.com) The polyester is recommended for outdoor use because of it's excellent UV resistant quality; if we were to use an epoxy it would tend to fade and chalk pretty quickly when exposed to sunlight and UV rays.

Care must be taken during installation because the finish can be scratched by the sharp surfaces of the controls and master cylinder clamps. When mounting the master cylinders to bars, do not let them move around the bars with the caps loose. Mount them in the proper position and hand tighten the screws until final adjustments are made; in this way you will lessen the possibility of scratching.

NOTE: Powder coat finish is not indestructible, there are chemicals which may react negatively when applied to finish. Brake fluid may cause deterioration of the finish. We do not recommend the use of acetone or similar chemicals for cleaning purposes. We would recommend the use of an over-the-counter adhesive remover (such as Goo Gone) for the removal of any extraneous material. Please read labels directions for any cleaning/polishing product before use. If you have any questions regarding the use of any over-counter-products with the HeliBars, please call us before applying them to the powder coated finish.

If care is taken during installation, your HeliBars will continue to look as good as when they were new. They will look great for years to come with a bit of wax and careful cleaning. Thank you for your purchase, ride safe and enjoy!

Sincerely,

Harry Eddy, President



Trailing with HeliBars®

HeliBars clip ons and handlebars must not be used as the primary holding points for tie downs while trailering. *As with your stock bars* applying extreme force to the ends of the bars can bend the bars or rotate them on their mounts.

Use a wheel chock and pull the machine down and forward using soft ties or similar, attached to the lower triple clamp.

Bars should only be used as secondary attachment points to steady the motorcycle from lateral sway.

Failure to follow these guidelines can cause damage to the bars and the motorcycle, and may also void our warranty.

