



Custom Dynamics® Dual Color Plasma Rods™ Installation Instructions

We thank you for purchasing Custom Dynamics® Dual Color Plasma Rods™ LED directional lighting! Our products utilize the latest technology and high quality components to ensure you the brightest, most reliable LED's on the market. We offer one of the best warranty programs in the industry and we back our products with excellent customer support, if you have questions before or during installation of this product please call Custom Dynamics® at 1(800) 382-1388.

Package Includes:

- Plasma Rods (pair)
- Dual Converter
- 3M Tape (installed)
- 3M Promoter
- Posi-Taps (8)

Instructions for installing Dual Color Plasma Rods™

1. Select location for mounting plasma rod.
2. Clean surface with 3M Promoter pad, allow to dry.
3. Mount Plasma Rod with supplied 3M tape.
4. Connect Black wire to good ground.
5. Connect Yellow wire to appropriate turn signal wire.
6. Connect to Blue wire to constant running light wire.
7. Connect the Red Wire to the brake wire.
8. Check operation of Plasma Rod in all modes.

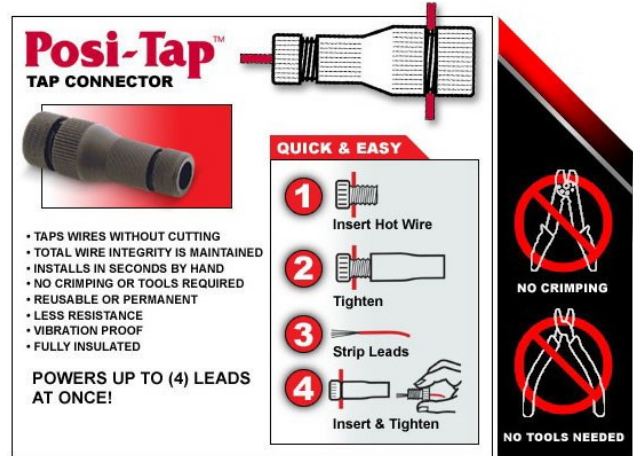

Note: If you are using the Dual Color Plasma Rods™ as your primary rear signal lights and removing the stock turn signals, you may experience a fast flash as if a bulb is out. If this occurs, a load equalizer or our Slim Line Signal Stabilizer is recommended. Contact us for details.

