



VStream®+

VStream® Windscreen Patent No. 7,387,328



INSTALLATION INSTRUCTIONS
VStream® Windscreen for Yamaha® MT-07

- N20340 VStream, Dark Tint
- N20341 VStream, Light Tint
- N20342 VStream, Clear

Scan QR Code to watch the installation video.



Thank you for purchasing a National Cycle product. Read these instructions carefully and thoroughly before beginning work. Dealers, if installing this windshield for a customer, please give them this manual upon completion. It contains information needed to properly maintain and use this product.

Description:	VStream® Windscreen	Model:	2021-Current Yamaha® MT-07
Part Number:	N20340/N20341/N20342	Installation Time:	20 min. Difficulty Level: Simple



ATTENTION: Special notes and cautionary measures which can prevent damage to the accessory or vehicle.



NOTE: Tips for facilitation of operation, control and adjustment, as well as maintenance work.

PACKAGE CONTENTS

ITEM	PART NO.	DESCRIPTION	QTY.
A	N20340/41/42	VStream Windscreen	1
BAG#1405			
B	34-345606-000	Headlight Bushing, Delrin Plastic, Black	2
C	75-762036-000	Rubber Washer, .625 O.D.	2

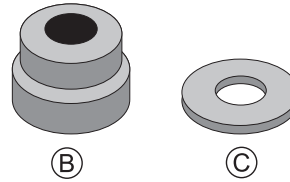

TOOLS REQUIRED

- 4mm Hex Wrench
- 5mm Hex Wrench



Step 1



PREPARATION

Place motorcycle securely on its sidestand.



Cover your motorcycle's gas tank and front fender with a blanket or tarp to prevent possible scratches during installation.

INSTALLATION

Step 1

Begin by removing the four OEM mounting bolts on the headlight cowl with a 4mm hex wrench.

Step 2

Next, remove the two OEM mounting bolts on the upper left and right side with a 5mm hex wrench.



Step 2



Step 3

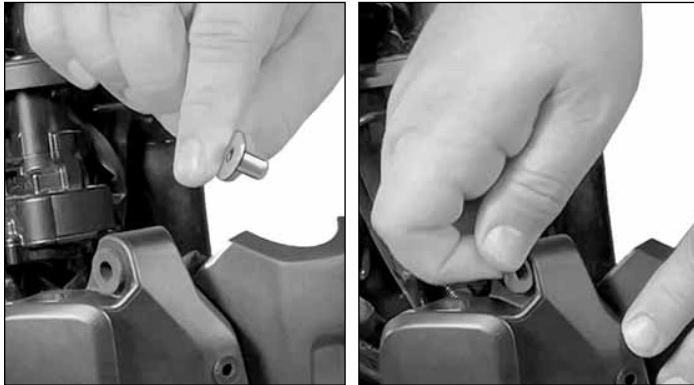

Step 4

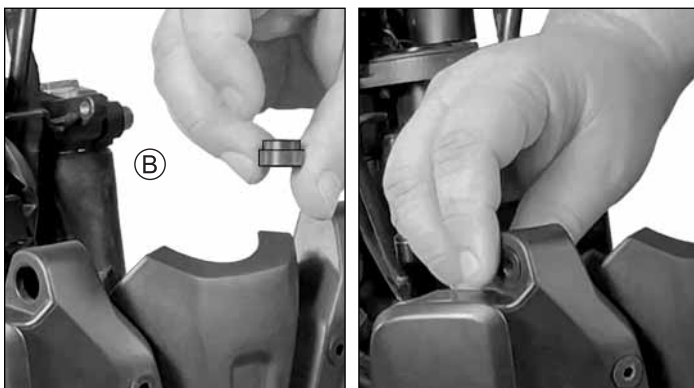

Step 5



Step 6

INSTALLATION; CONT'D

Step 3

Once the mounting screws are removed, pivot the entire headlight cowl assembly forward and down until it rests.

Step 4

Remove the OEM aluminum bushings on both sides, and then remove the OEM rubber grommets.

Step 5

Replace the OEM rubber grommets with the two Delrin Plastic Headlight Bushings (B) included with your new windscreen.

Insert them from the inside of the cowling as shown, and press them into place.

Step 6

Pivot the entire headlight cowl assembly up and back into place.

Step 7

Replace the OEM upper mounting bolts and tighten with a 5mm hex wrench.



Step 7

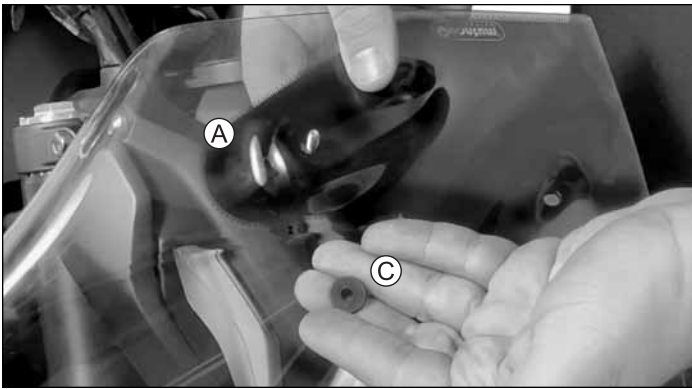

Step 8



Step 9



Step 10

INSTALLATION; CONT'D

Step 8

Insert two of the OEM mounting bolts (removed in Step 1) through the top front mounting holes of your VStream Windscreen, and hold in place.

On the back of the Windscreen, place two two Rubber Washers (C) of the mounting bolts.

 *Be careful that these do not fall loose during assembly.*

Step 9

Align the Windscreen with its two mounting bolts into the top two Wellnuts of the headlight cowl assembly. Use a 4mm hex wrench to thread them into place, but not yet fully tightened.

 *If this is not the first time the OEM mounting bolts have been removed, inspect the health of the Wellnuts. Be careful not to push them inside of the headlight cowl assembly.*

Step 10

Insert the bottom two mounting bolts through the Windscreen and into the bottom two Wellnuts of the headlight cowl assembly.

Now tighten all four mounting bolts firmly and securely.

 *These mounting bolts need not be over-torqued.*

***Your VStream® Windscreen installation is now complete.
Enjoy the ride!***



CLEANING AND MAINTENANCE

To clean the screen, wash with a clean soft cloth and plenty of warm water and, if necessary, a non-abrasive soap such as dishwashing liquid. Flannel or soft chamois make good cleaning cloths. Paint, glue residue or grease removal: Moisten cotton wad with naphtha or turpentine followed by a wash as above.

National Cycle Shield Wash™ (N1401-01) makes a good daily cleaner and comes with a handy travel-size bottle. Shield Wash is safe for all windshields and helmet visors

Do not clean polycarbonate in hot sun or high temperatures. Do not clean the screen with household glass cleaners. Do not allow brake fluid, alcohol, or strong solvents to contact the screen.

RAIN REPELLENT

Do not use rain protective products made for glass. We recommend National Cycle's RainZip® (N1410-01) to keep your wind-screen clear in rainy weather.



Register Your Windshield Online at www.nationalcycle.com

National Cycle 3-Year Limited Warranty

National Cycle hereby warrants to the original registered owner of a National Cycle polycarbonate windshield for a period of three years from the date of purchase against breakage. This limited warranty is expressly limited to the replacement of the polycarbonate windscreen. This limited warranty does not include scratches, coating failure, cosmetic wear and tear, replacement of hardware, or any consequential damages or expenses including labor cost of installation, removal and/or replacement, inconvenience, inbound freight expenses or damage to any other component of the motorcycle or any other accessories. Certain chemicals, generally known as acidic hydrocarbons, are known to cause polycarbonate damage and will not be covered under this limited warranty. Please refer to the cleaning instructions supplied with all National Cycle windshields.

Visit www.nationalcycle.com for further details, or call 708-343-0400 or e-mail info@nationalcycle.com.

WARNING

Never ride your motorcycle with loose accessory mounting hardware. Check the hardware for tightness regularly.

Today's motorcycles are built with enough frame rigidity to withstand the moderate loads imposed on them by the foreseeable addition of an accessory(ies). If an accessory(ies) adversely affects your motorcycle's stability, immediately remove the accessory(ies). Do not ride a motorcycle that exhibits unsafe handling traits.

Have experienced service personnel correct any problem before riding with the accessory(ies) installed. For further questions concerning handling problems associated with an accessory(ies), contact your dealer, motorcycle manufacturer, or accessory manufacturer.

Sunlight reflected off the inside curvature of the windscreen can, at certain times of day, cause extreme heat buildup on the motorcycle's instruments and possibly even melt them. Exercise care in parking to avoid this. Park your motorcycle facing the sun or place an opaque object over this area.