



**EVOTECH**®  
P E R F O R M A N C E

[www.evotech-performance.com](http://www.evotech-performance.com)

Triumph Tiger 1200  
Handguard Installation Instruction



- Ⓐ 1 x Mounting Bracket Clamp ( 1 x L/H & 1 x R/H)
- Ⓑ 1 x Hanguard ( 1 x L/H & 1 x R/H)
- Ⓒ 1 x Mounting Bracket ( 1 x L/H & 1 x R/H)
- Ⓓ 2 x Bar End Outer
- Ⓔ 2 x Bar End Inner
- Ⓕ 2 x Bar End Inner (Middle)
- Ⓖ 2 x M6 x 60 Caphead
- Ⓗ 4 x M6 x 20 Caphead
- Ⓘ 4 x M6 x 16 Black Button Head Bolt
- Ⓝ 4 x M6 Washer

**EPTechnology**®  
P E R F O R M A N C E

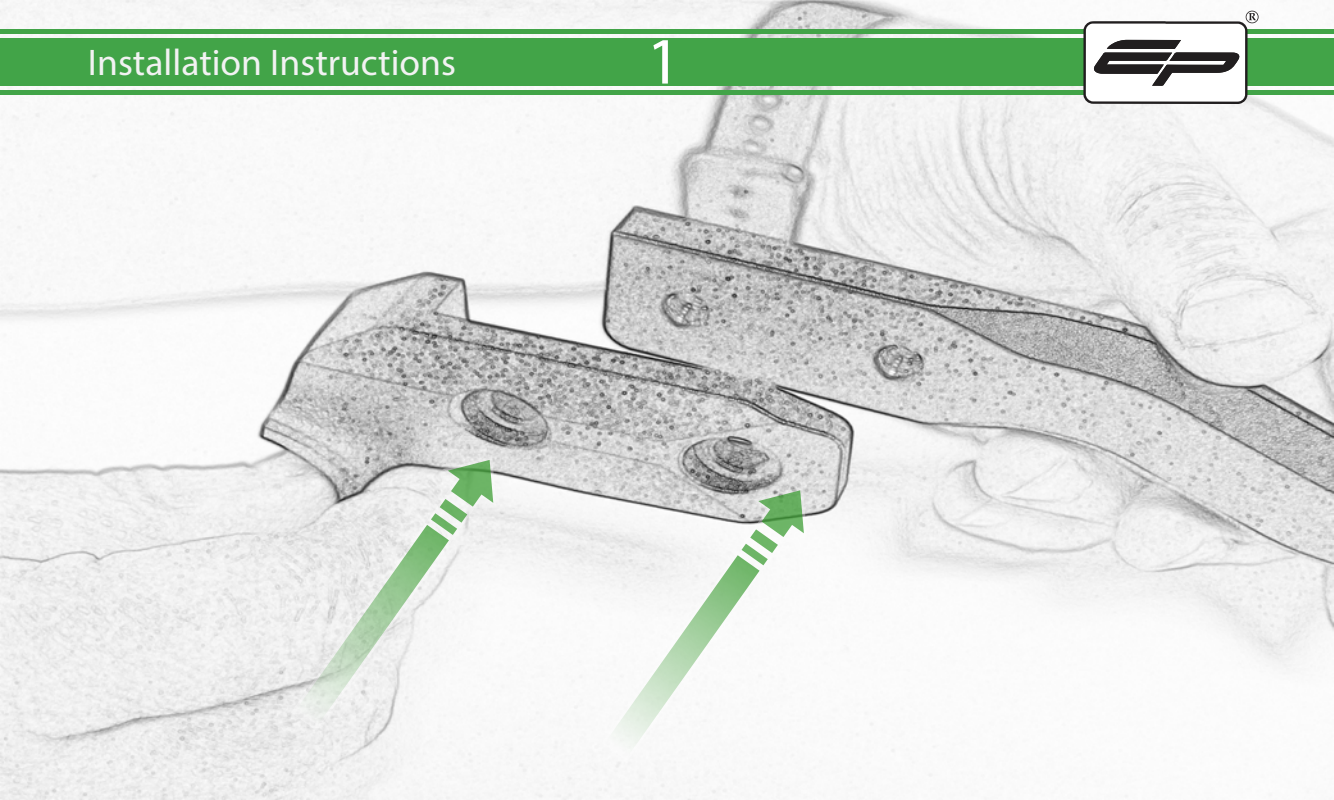

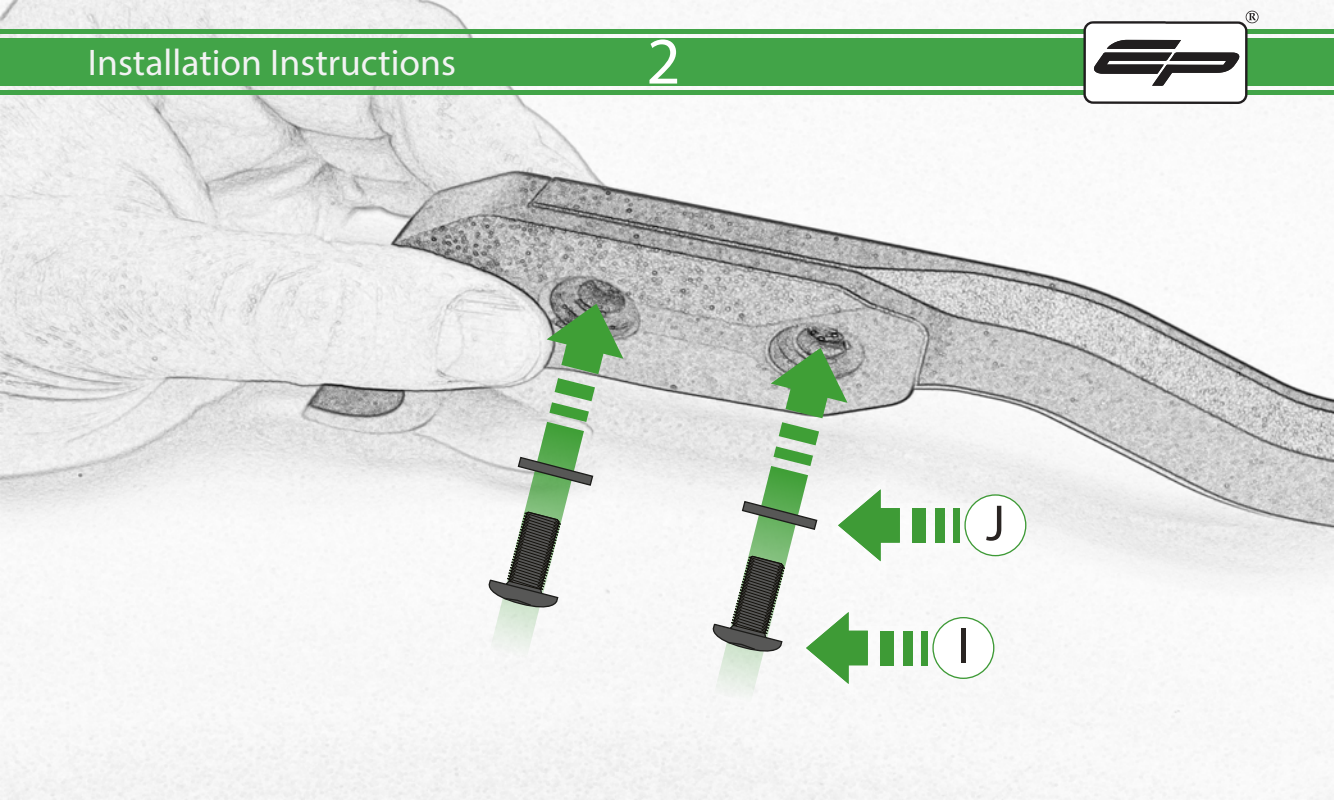



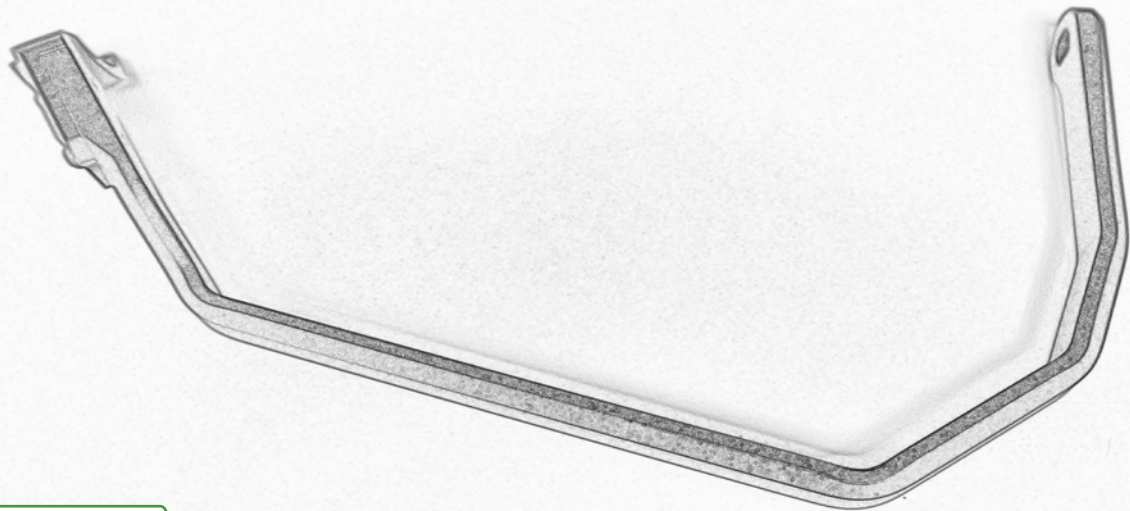

Pre  
Assembly

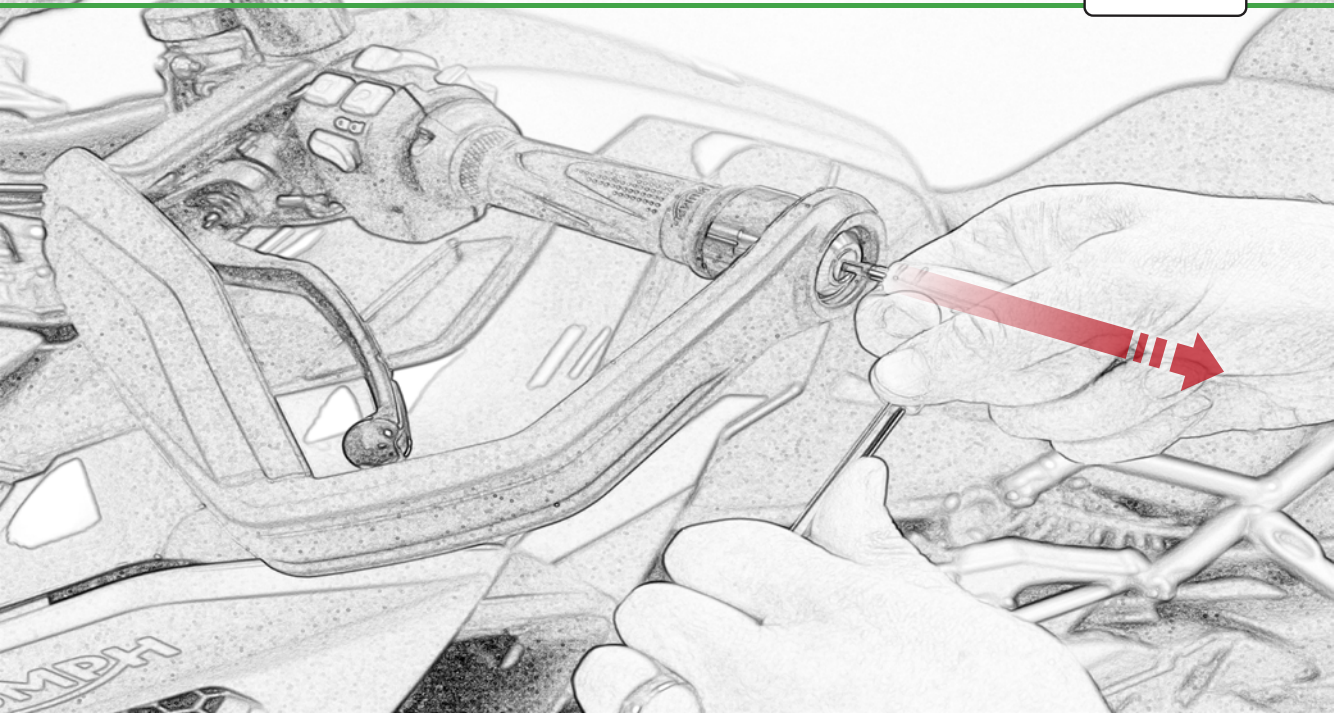

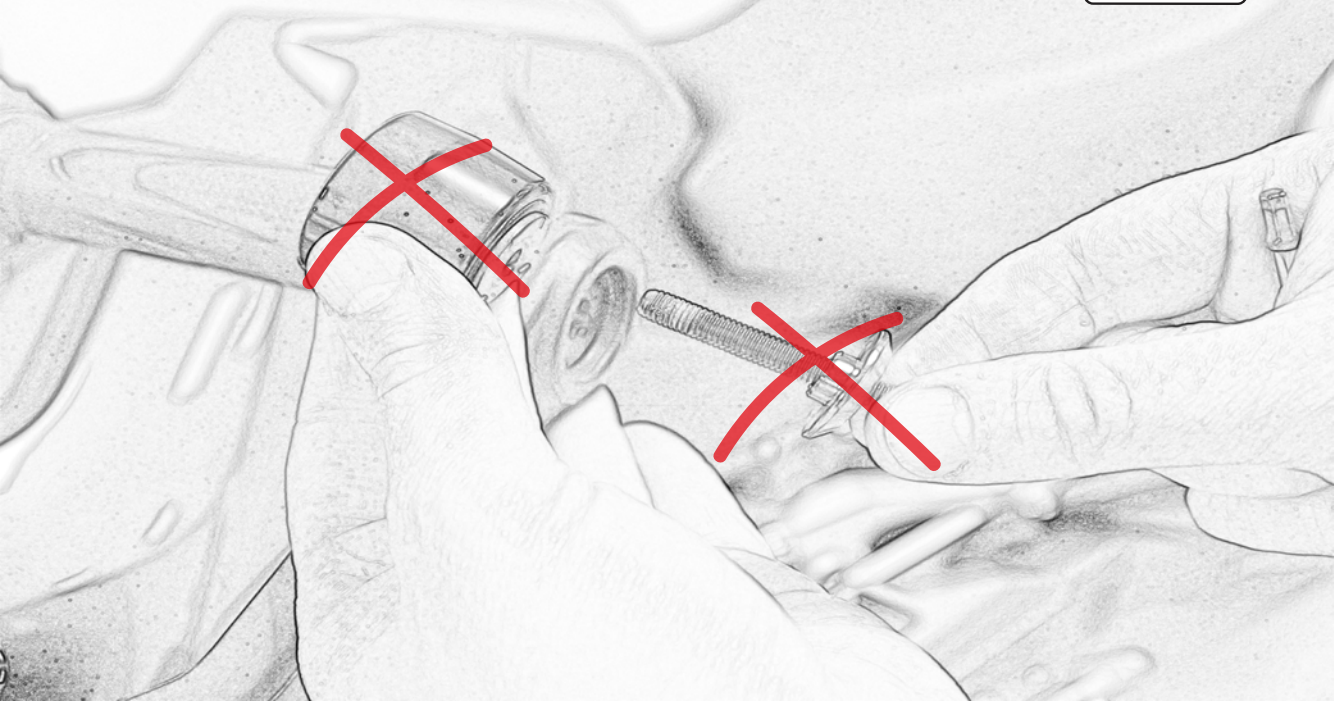

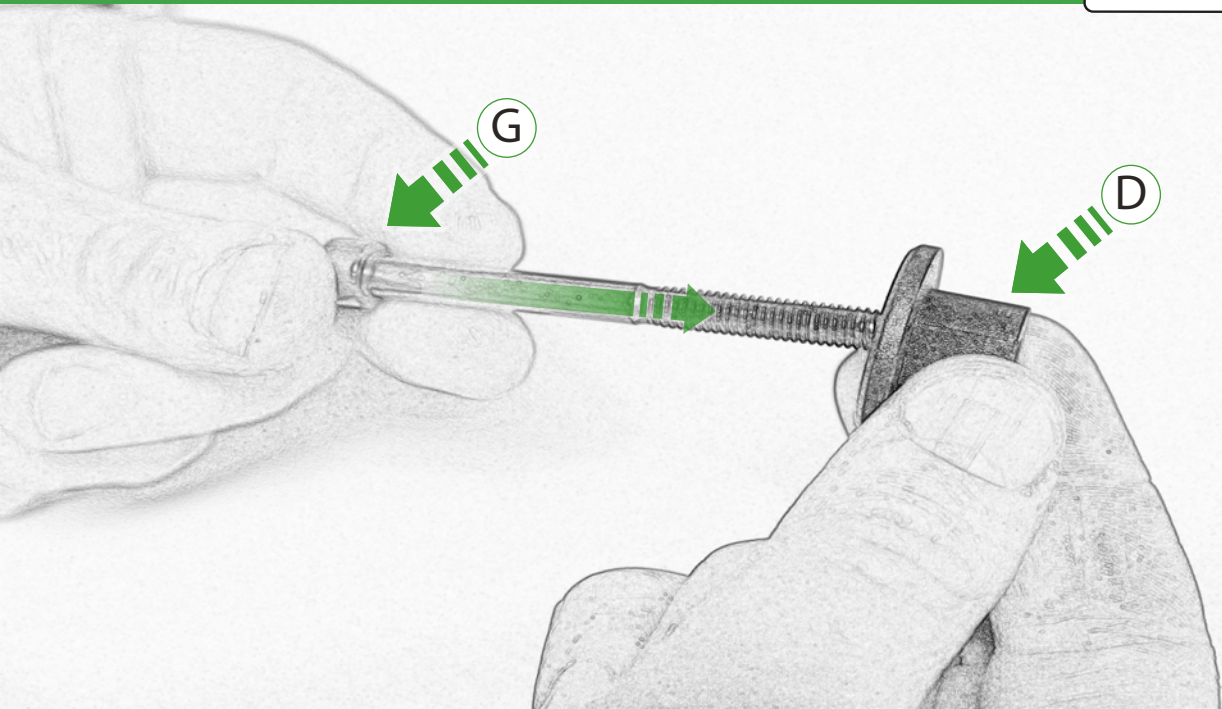

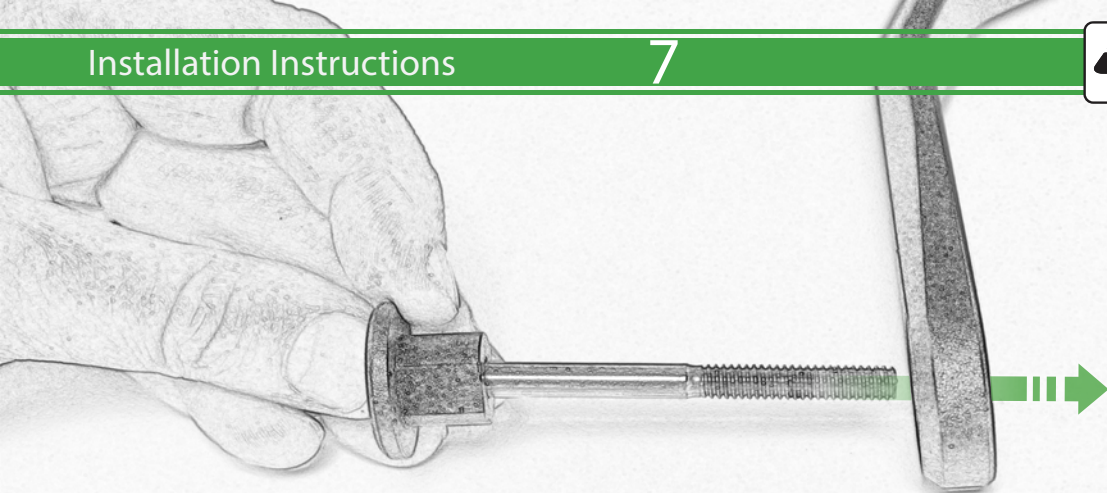



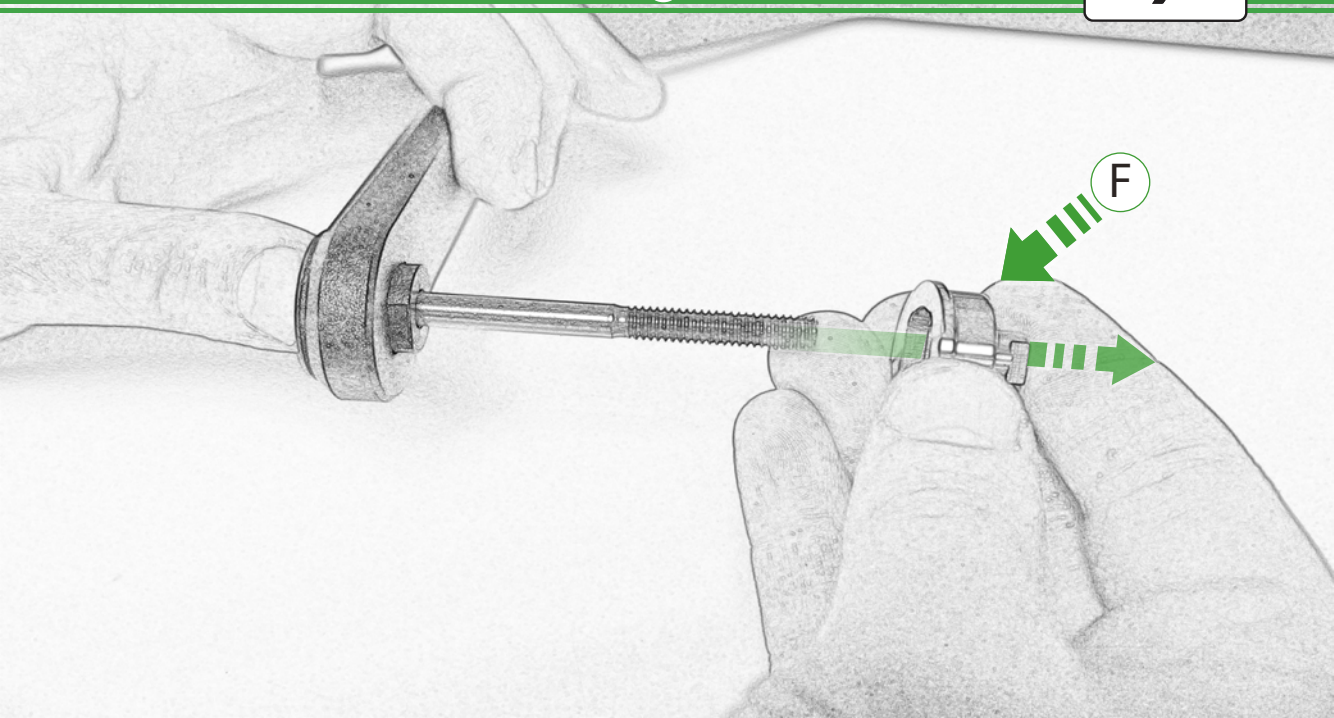

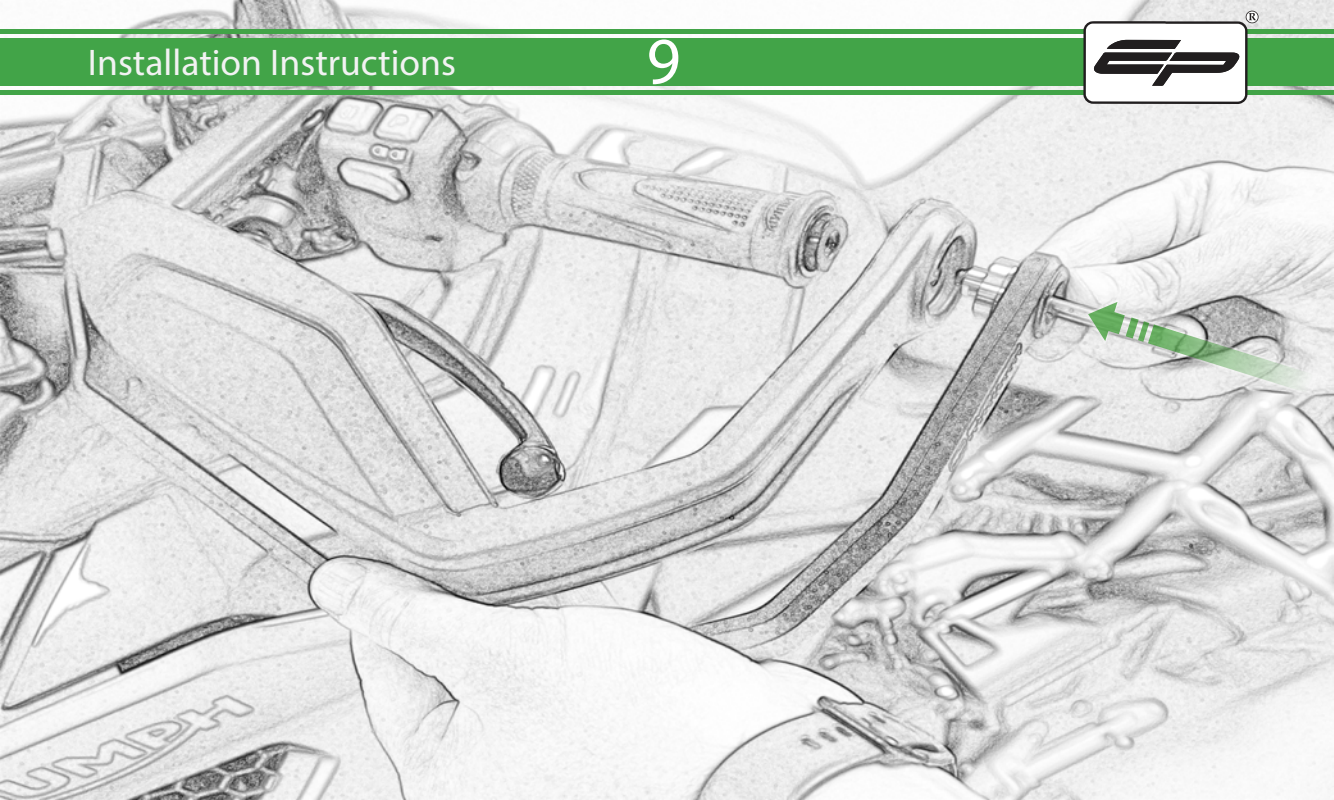

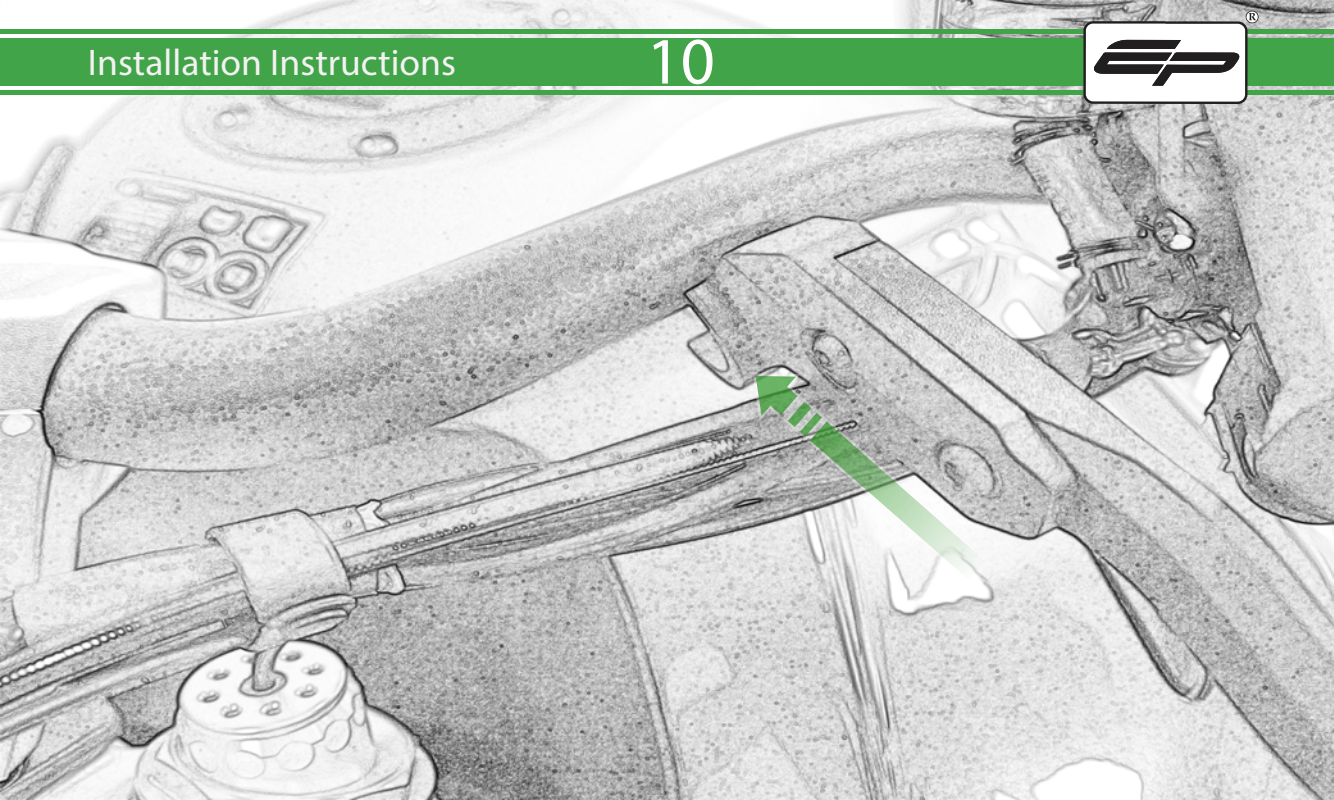



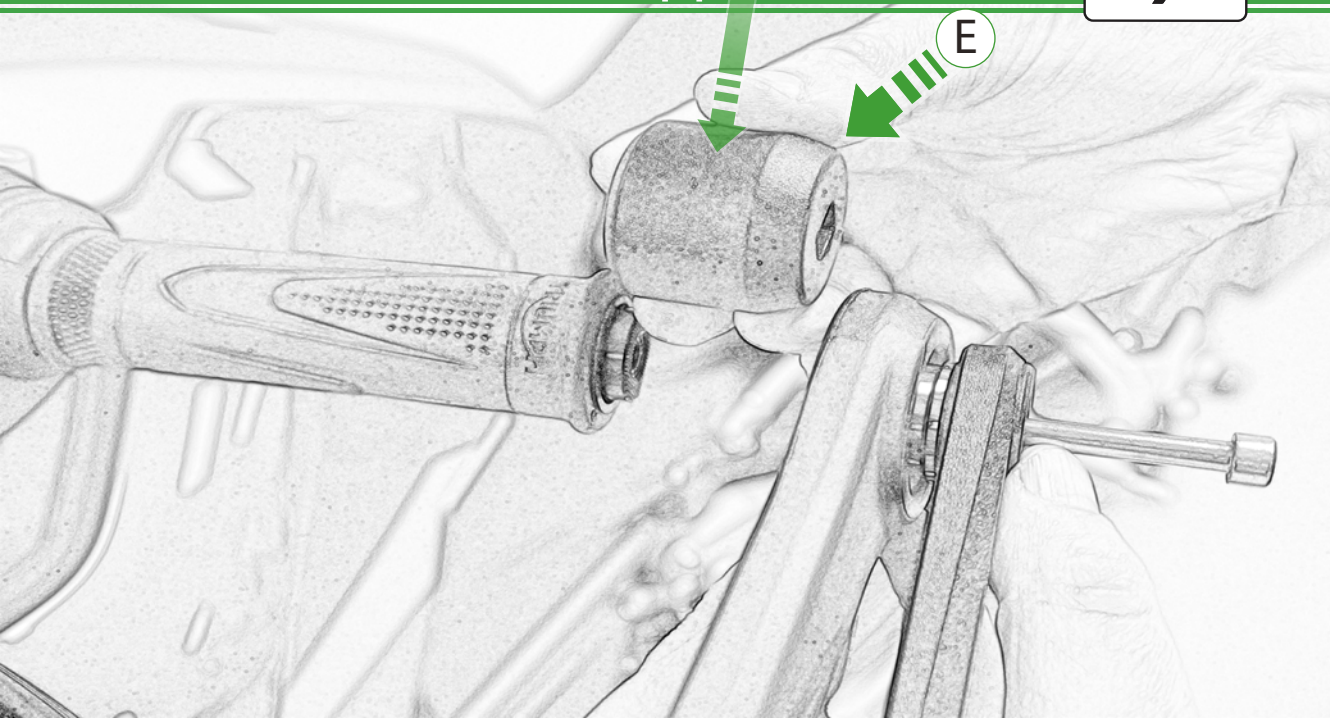

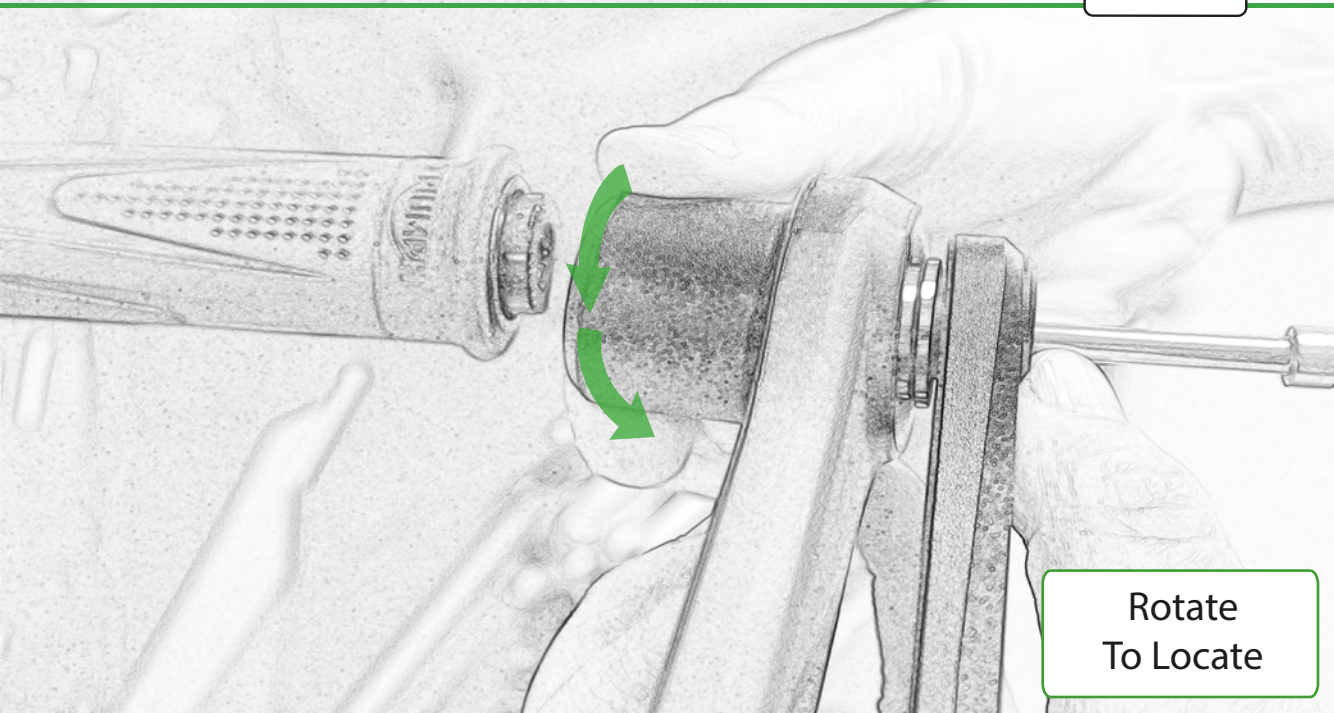

Rotate  
To Locate



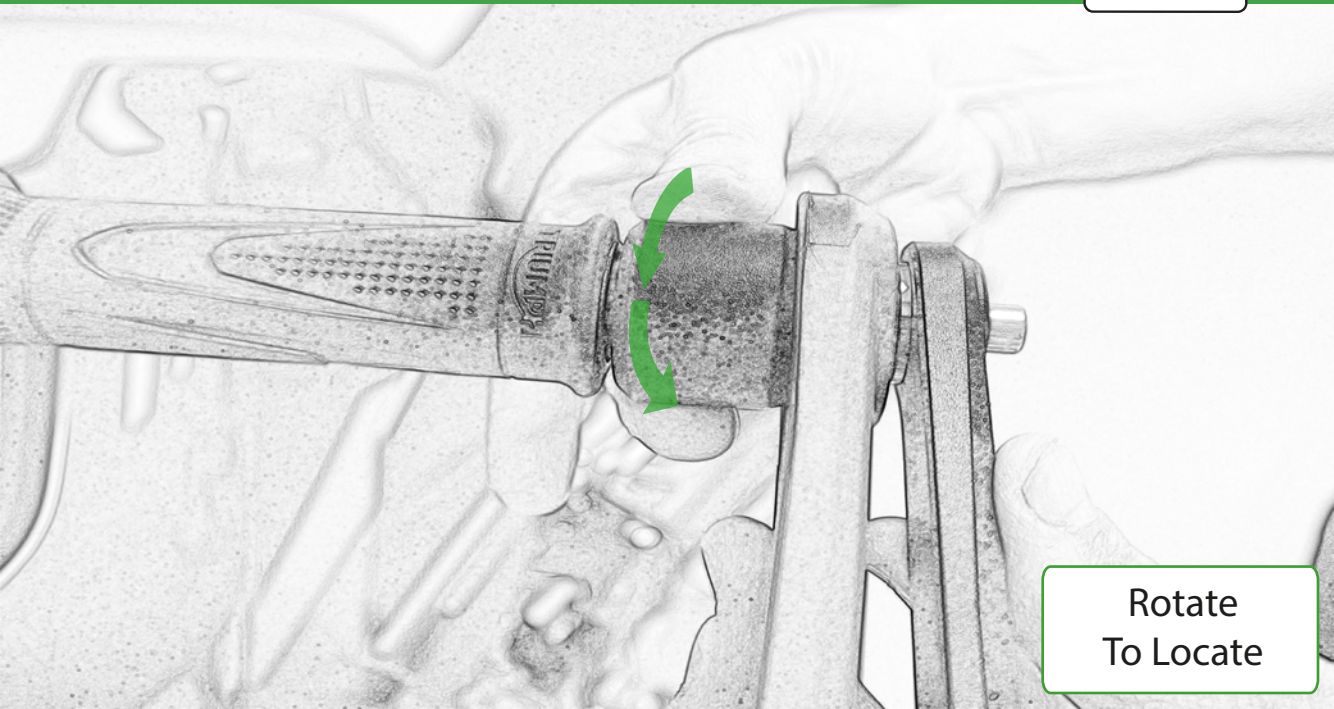

Rotate  
To Locate



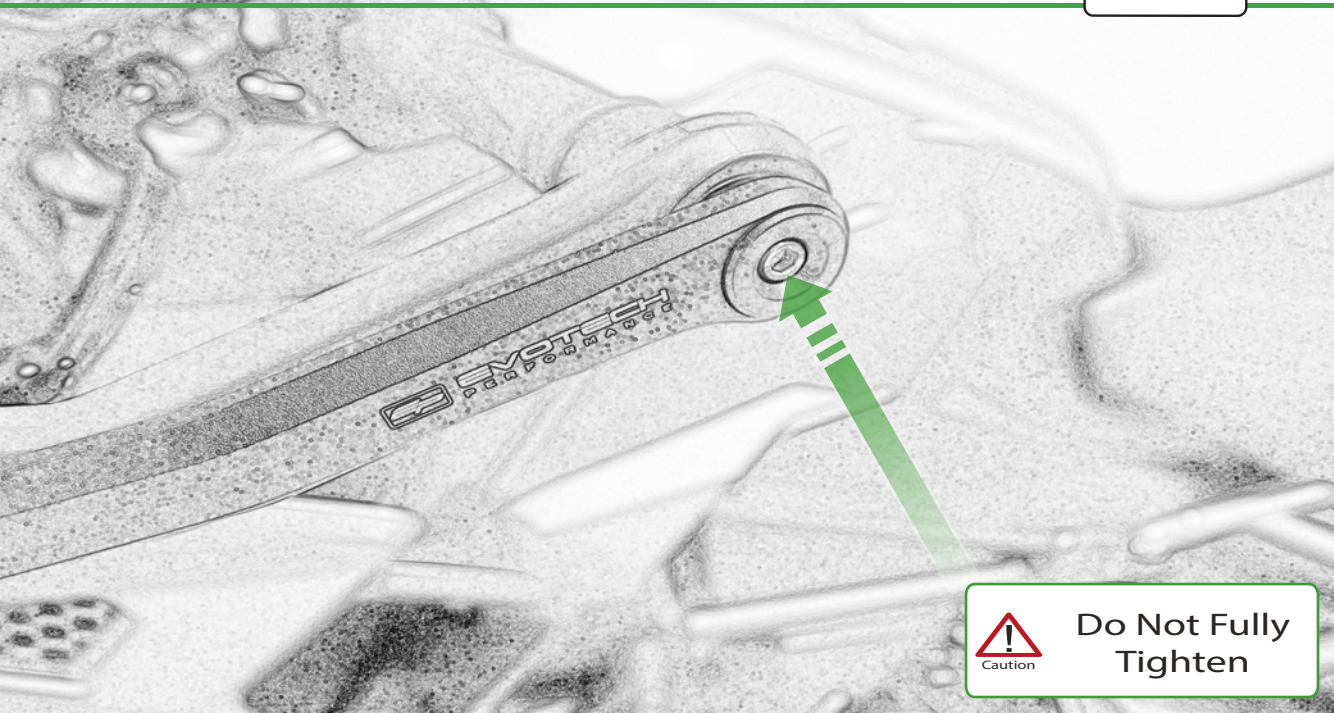

Caution

Do Not Fully Tighten



Notch Must  
Face Outwards

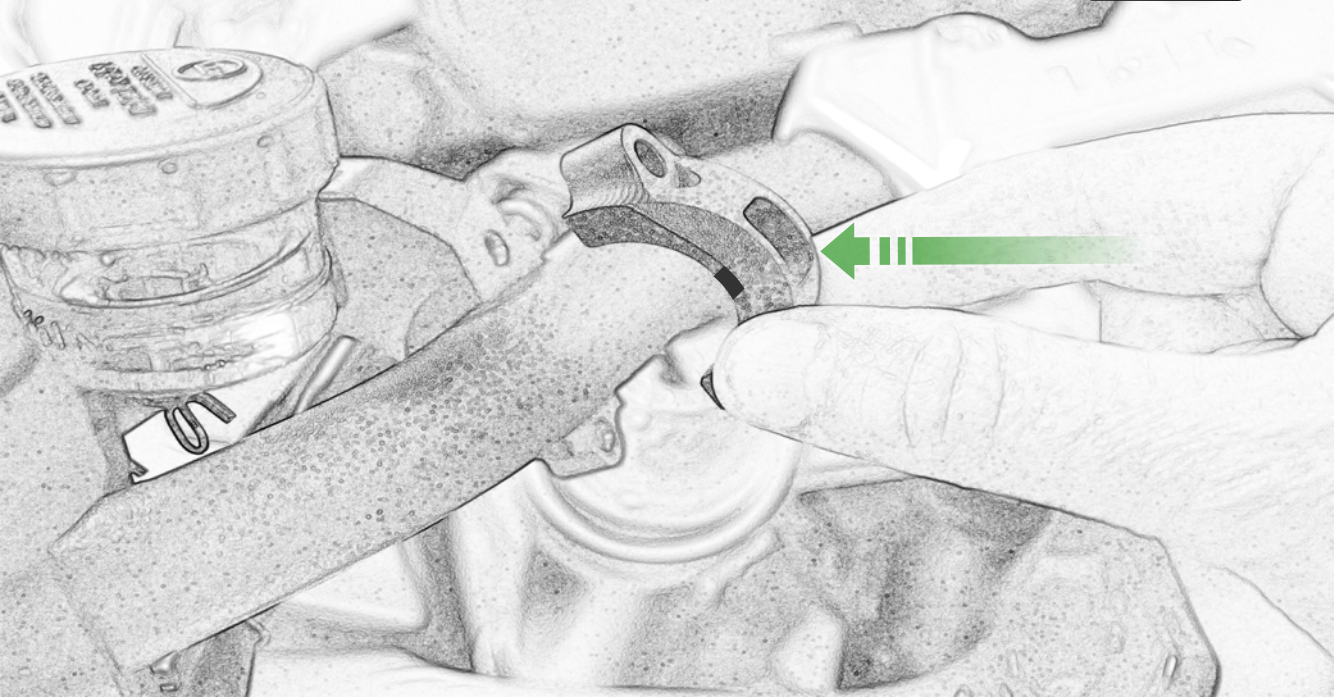

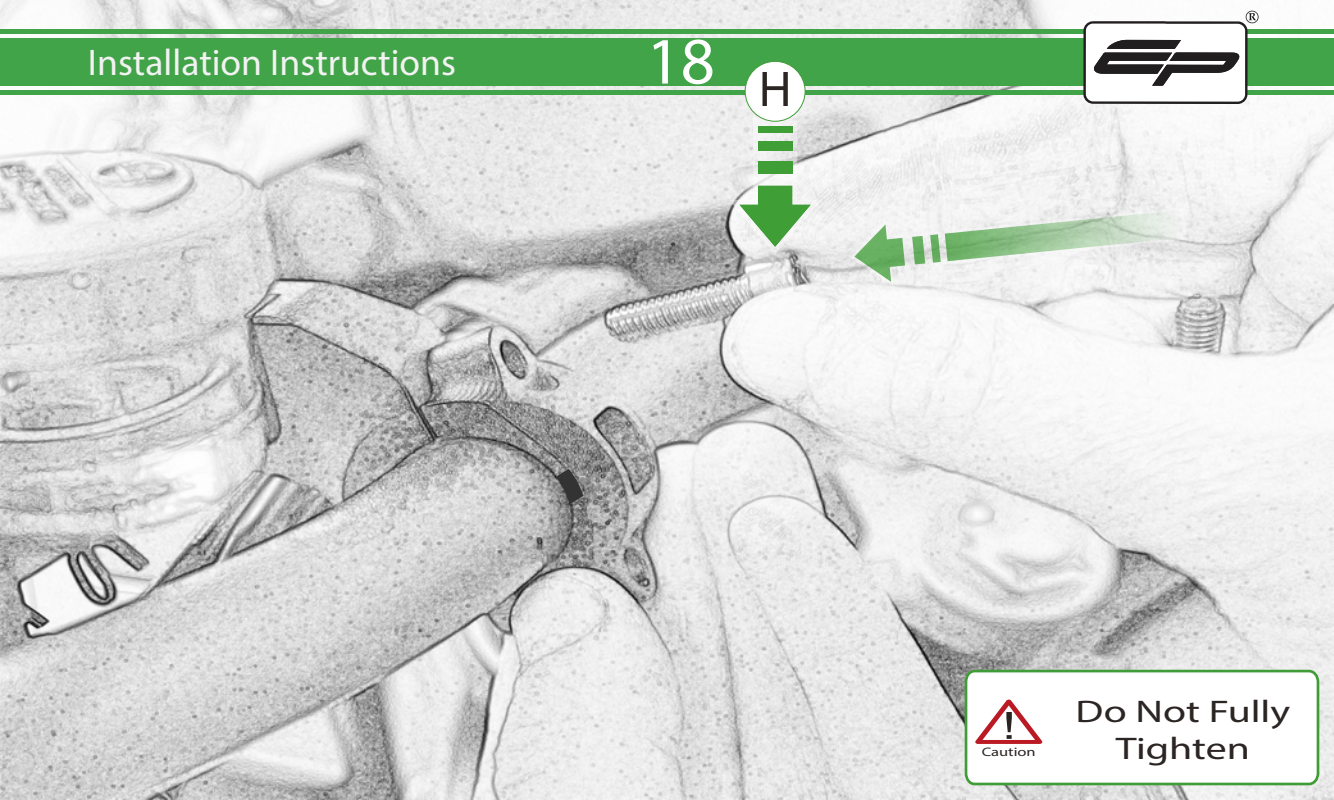

Do Not Fully Tighten



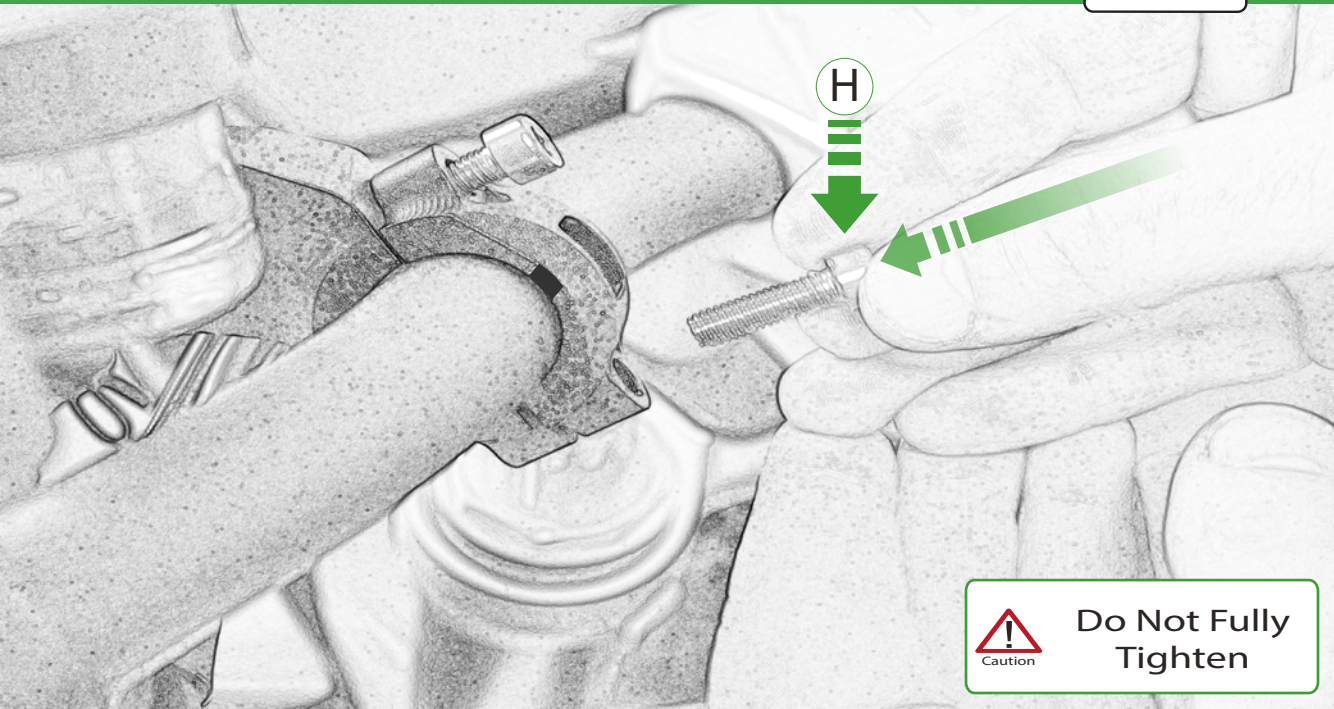

Do Not Fully Tighten

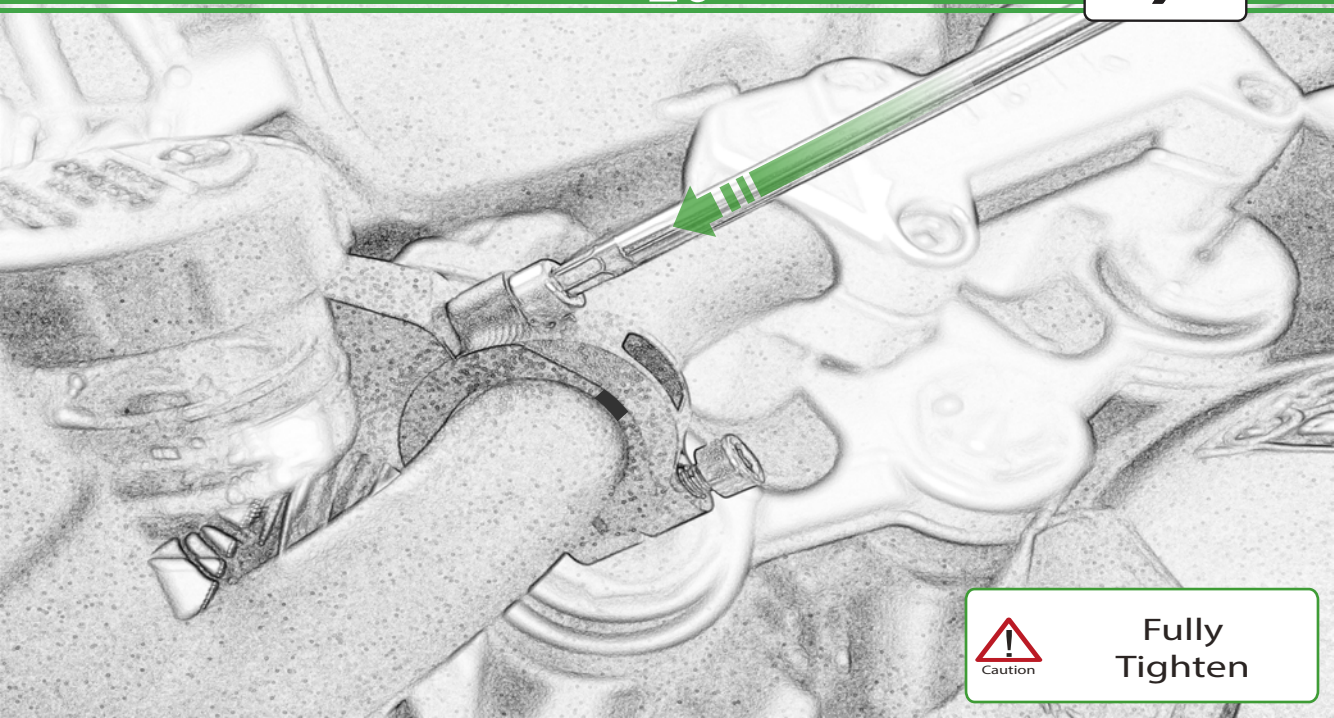

Fully  
Tighten



Fully  
Tighten

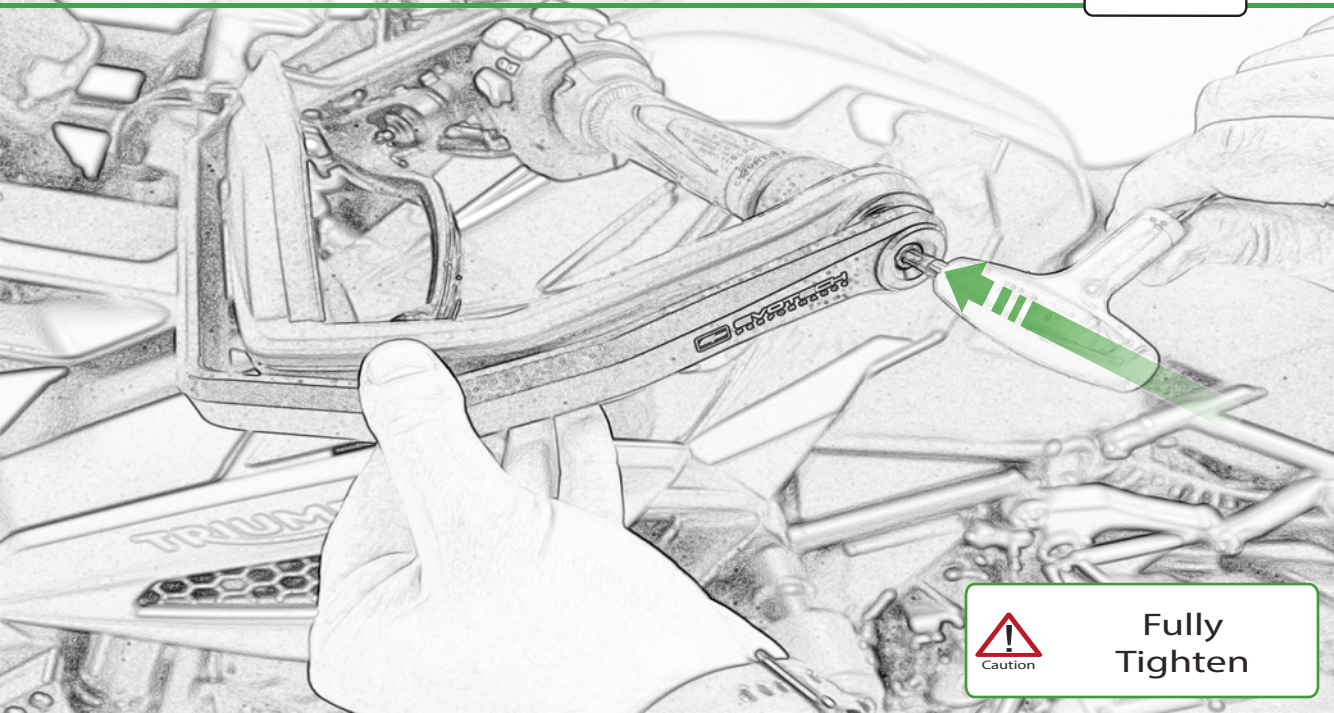

Fully  
Tighten



EVOTECH<sup>®</sup>  
P E R F O R M A N C E



 **ESSENTIAL CHECKS** 

It is recommended that periodic inspections are made to ensure that all bolts are tightened to the specified torque settings.

Should the bike be involved in an accident a thorough inspection should be made and any components that have taken an impact, no matter how small, be replaced

P E R F O R M A N C E





**EVOTECH**®  
P E R F O R M A N C E

[www.evotech-performance.com](http://www.evotech-performance.com)