

**EVOTECH**®  
P E R F O R M A N C E

[www.evotech-performance.com](http://www.evotech-performance.com)

Ducati Monster  
Engine Guard Instructions



## Kit Contents PRN015685

- Ⓐ 1 x Inner Grill
- Ⓑ 2 x M4 Flange Nut
- Ⓒ 2 x M6 x 12 Caphead Bolt
- Ⓓ 5 x M6 x 16 Button Head Bolts
- Ⓔ 5 x Grommet
- Ⓕ 5 x Top Hat Nut

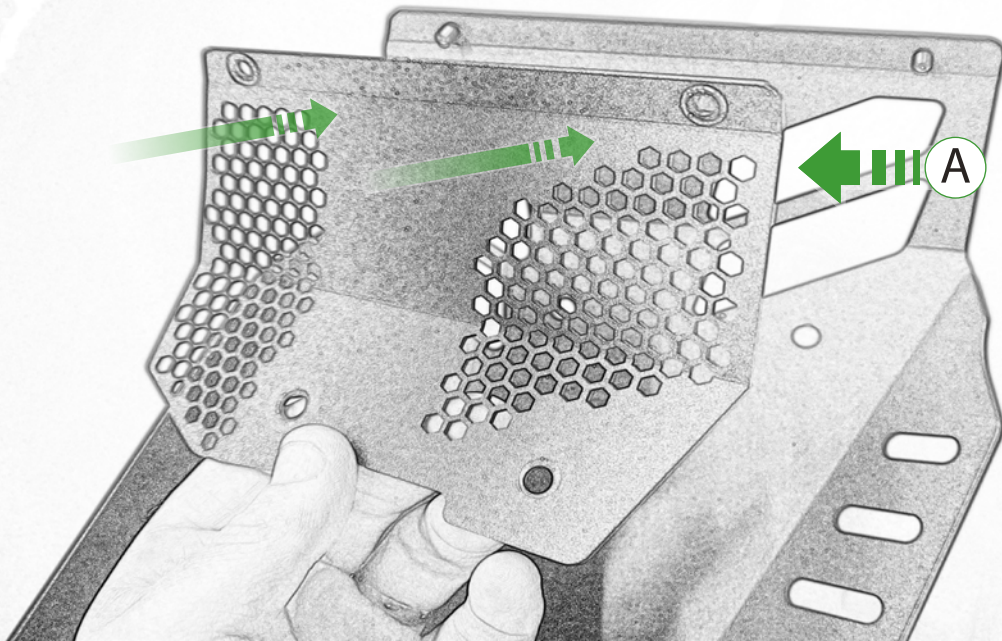

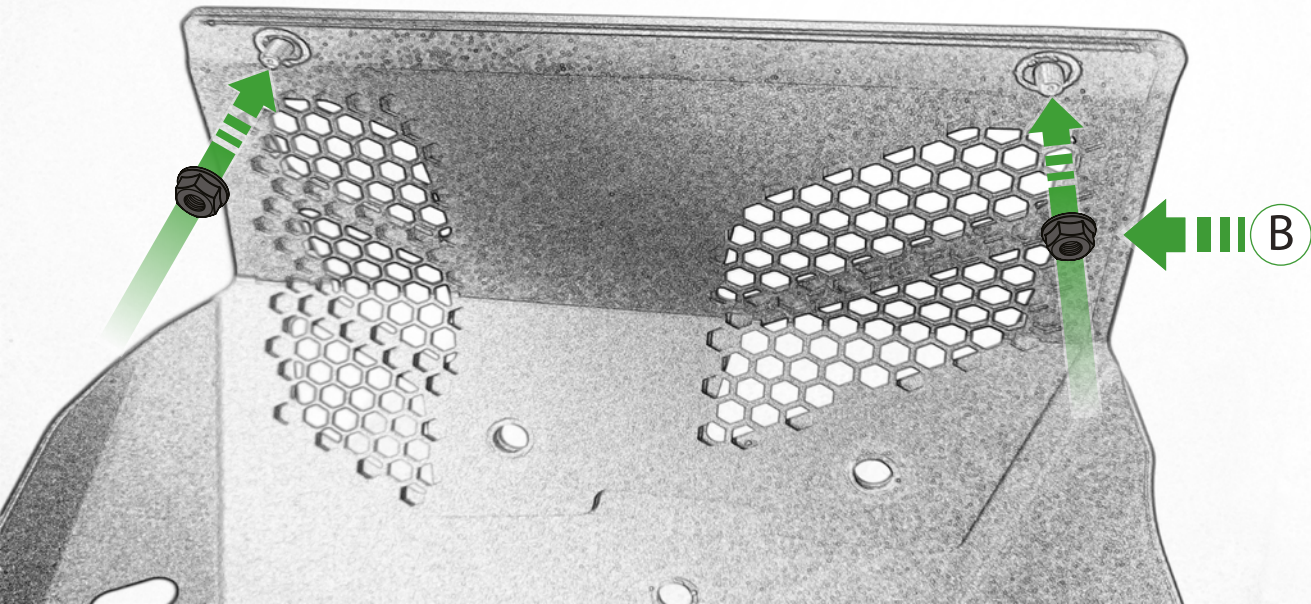

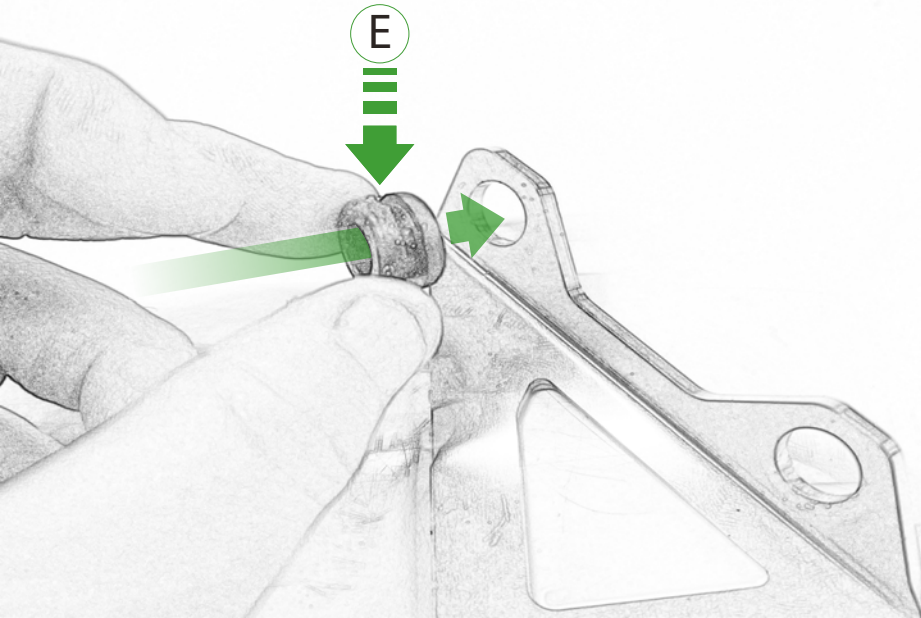

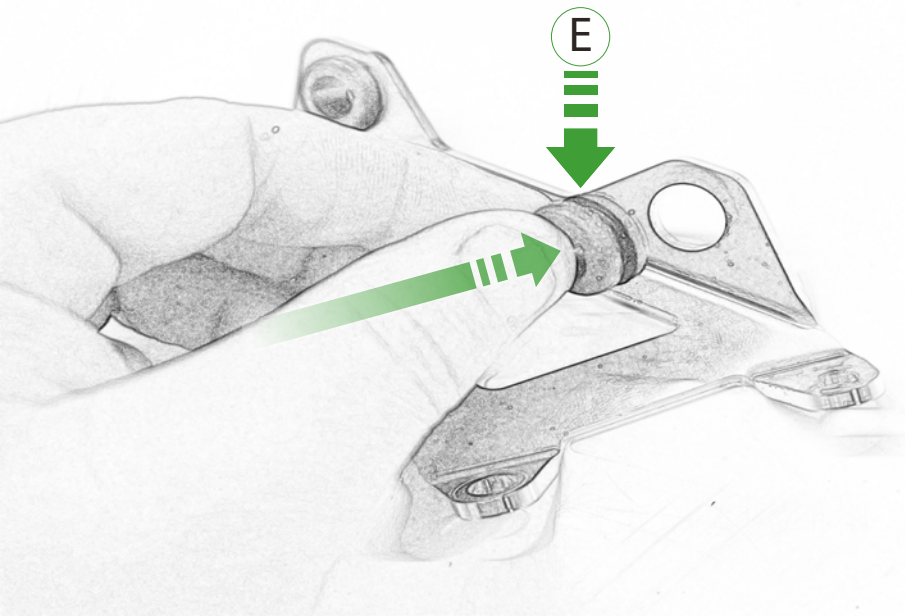

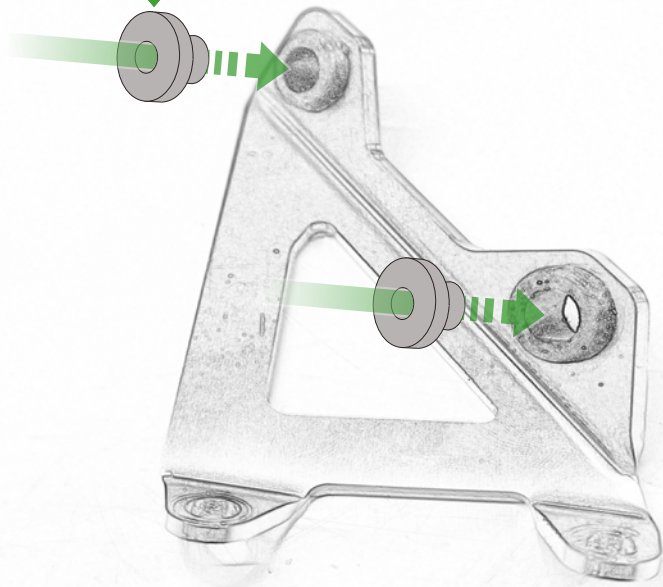

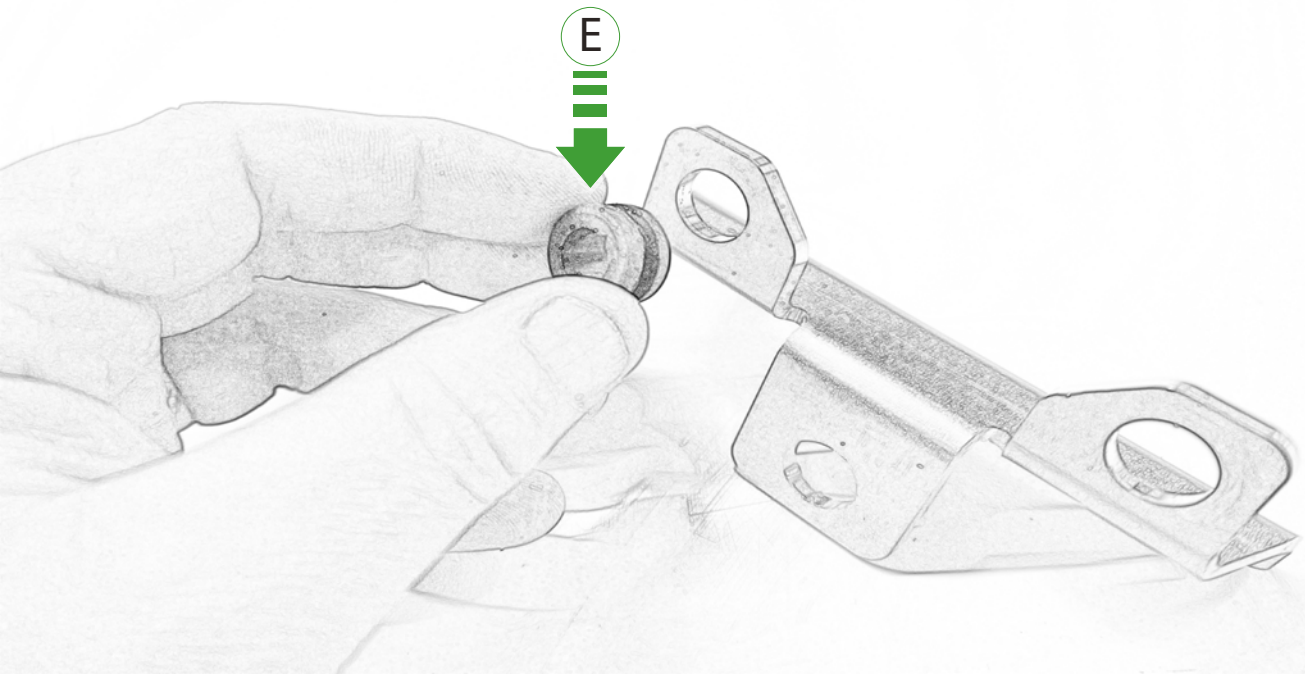



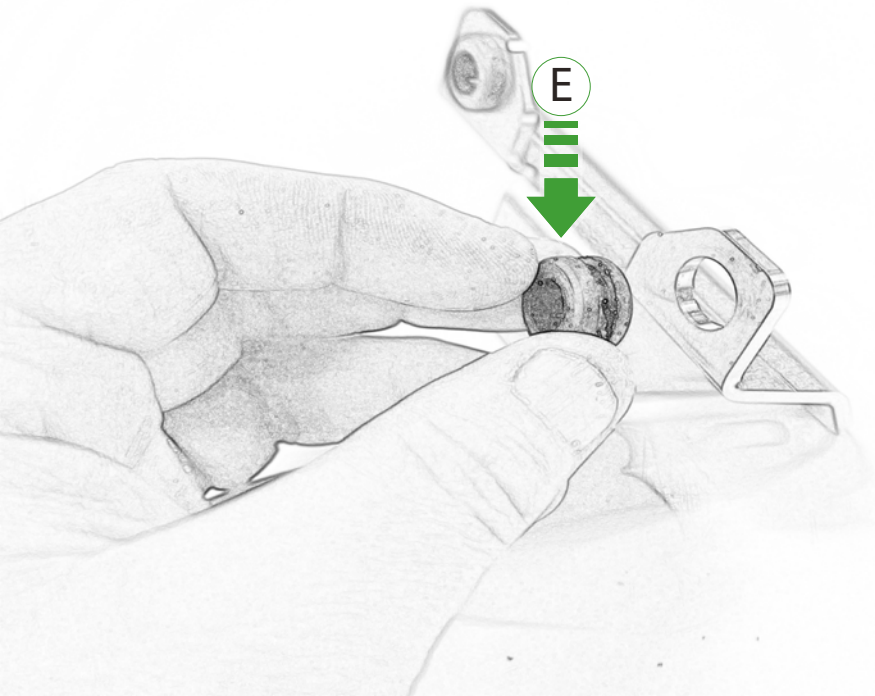

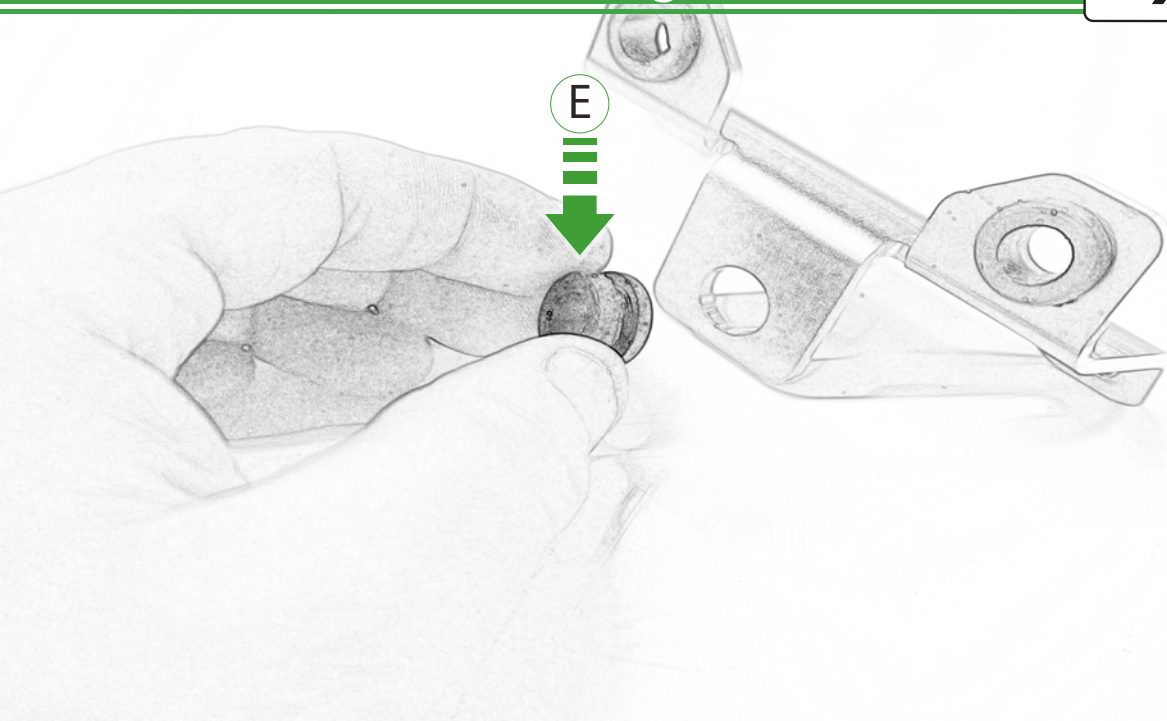

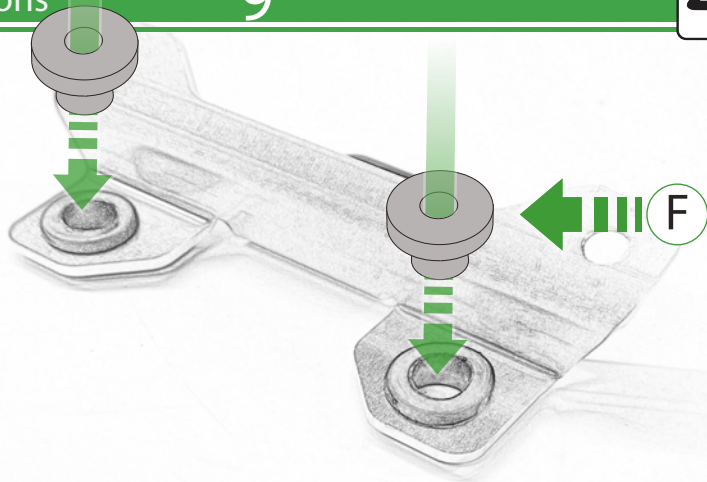

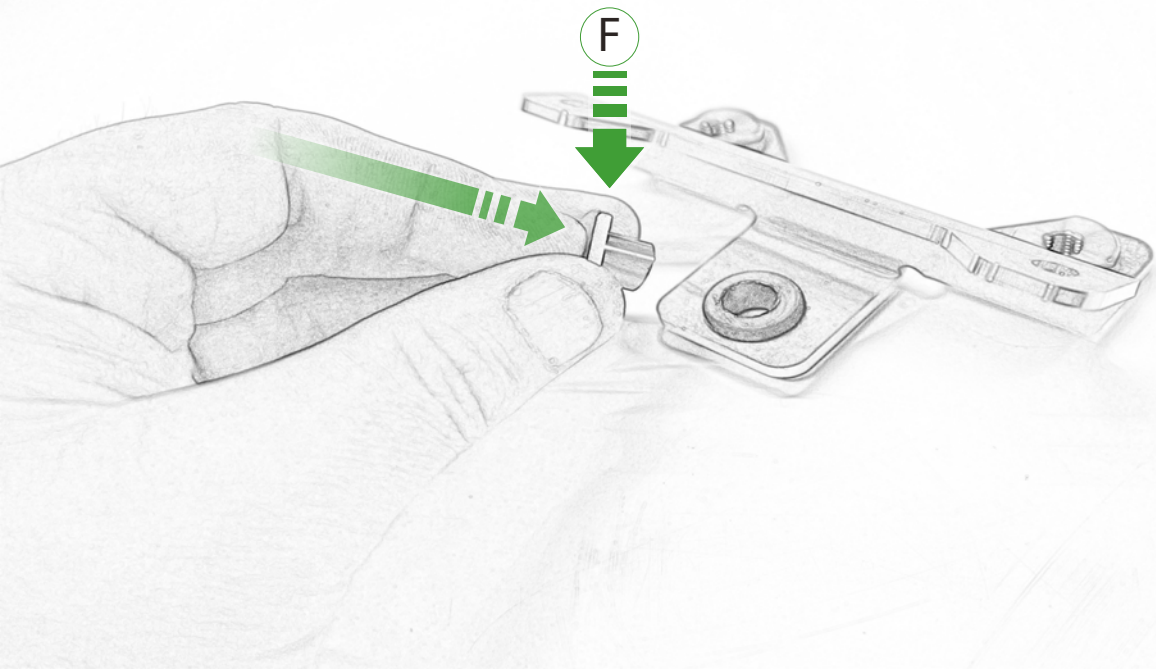

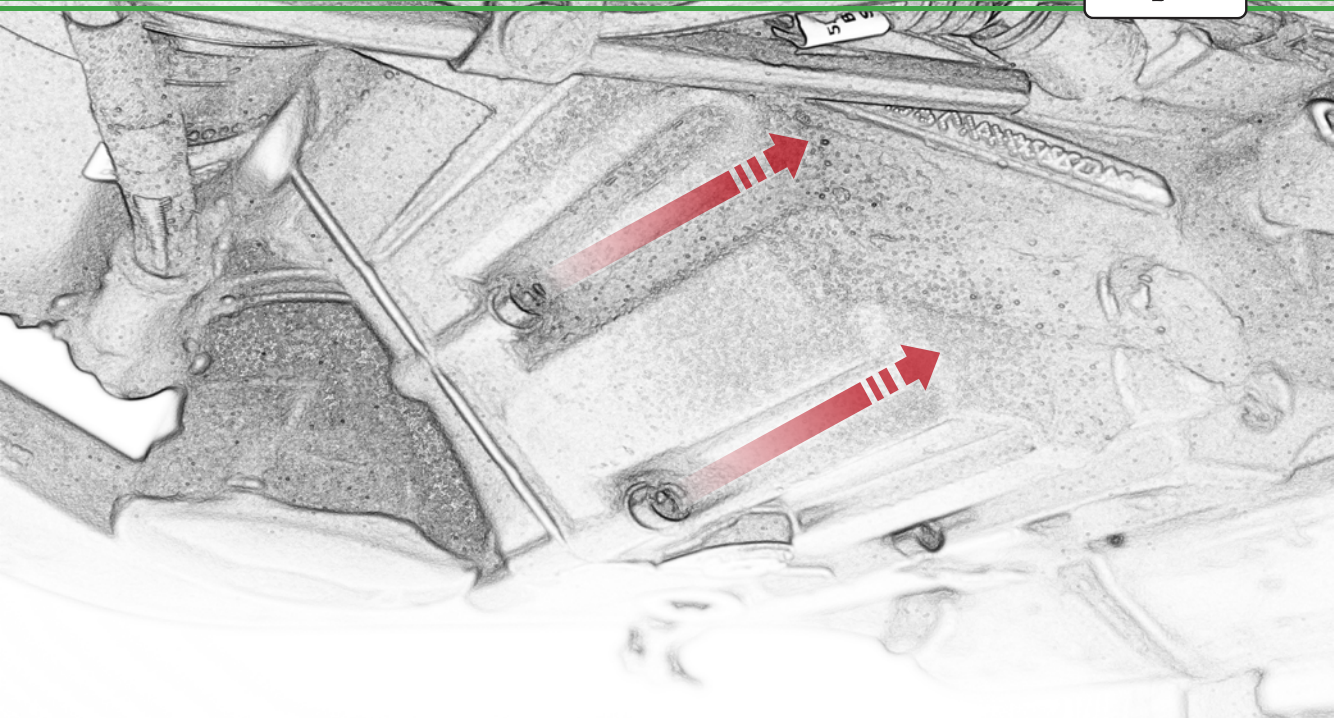

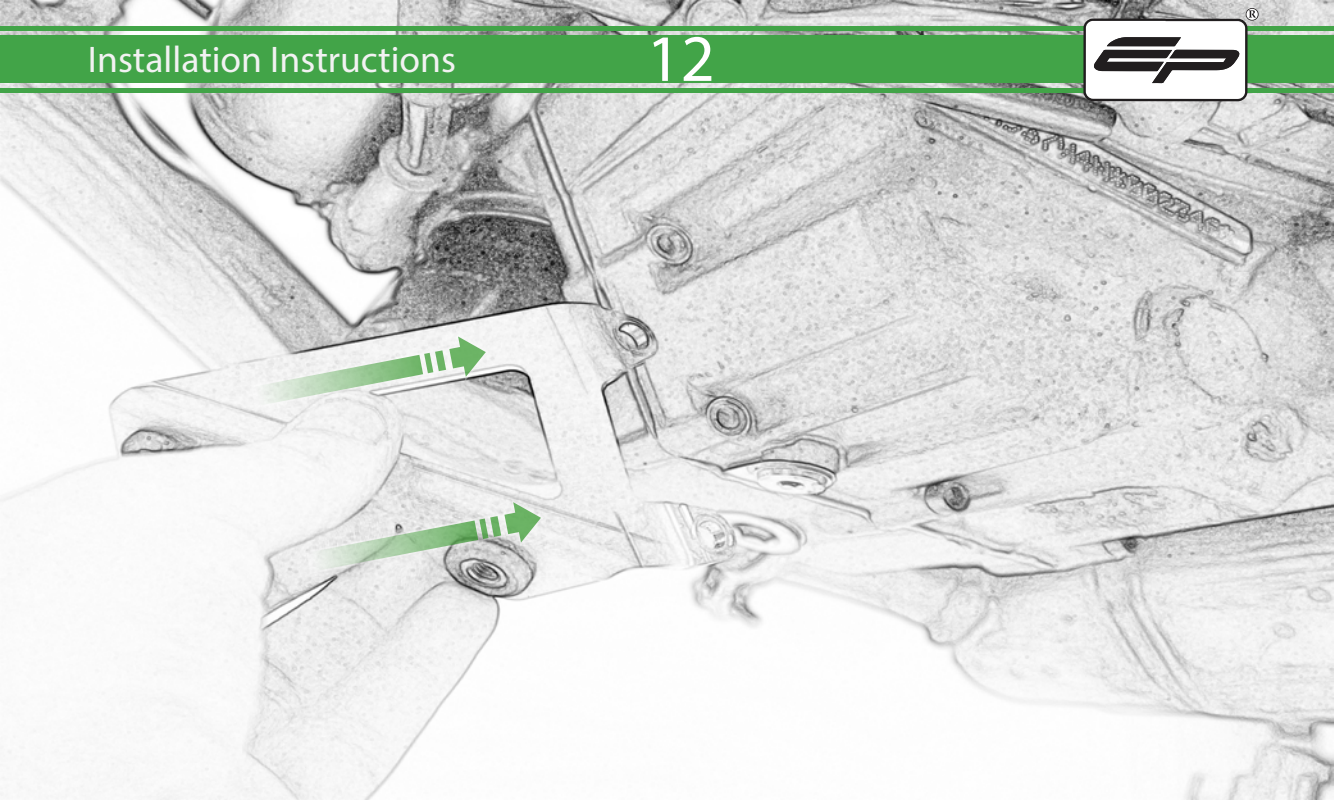

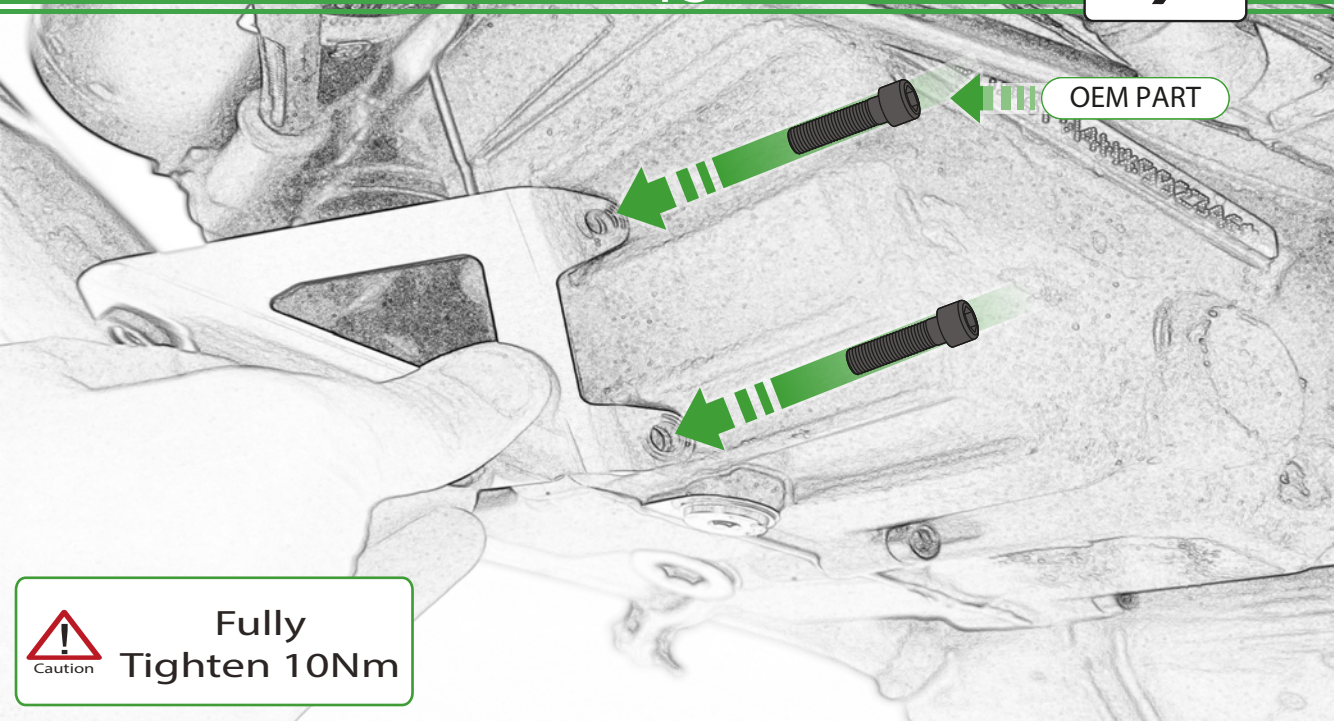

OEM PART



Caution

Fully  
Tighten 10Nm





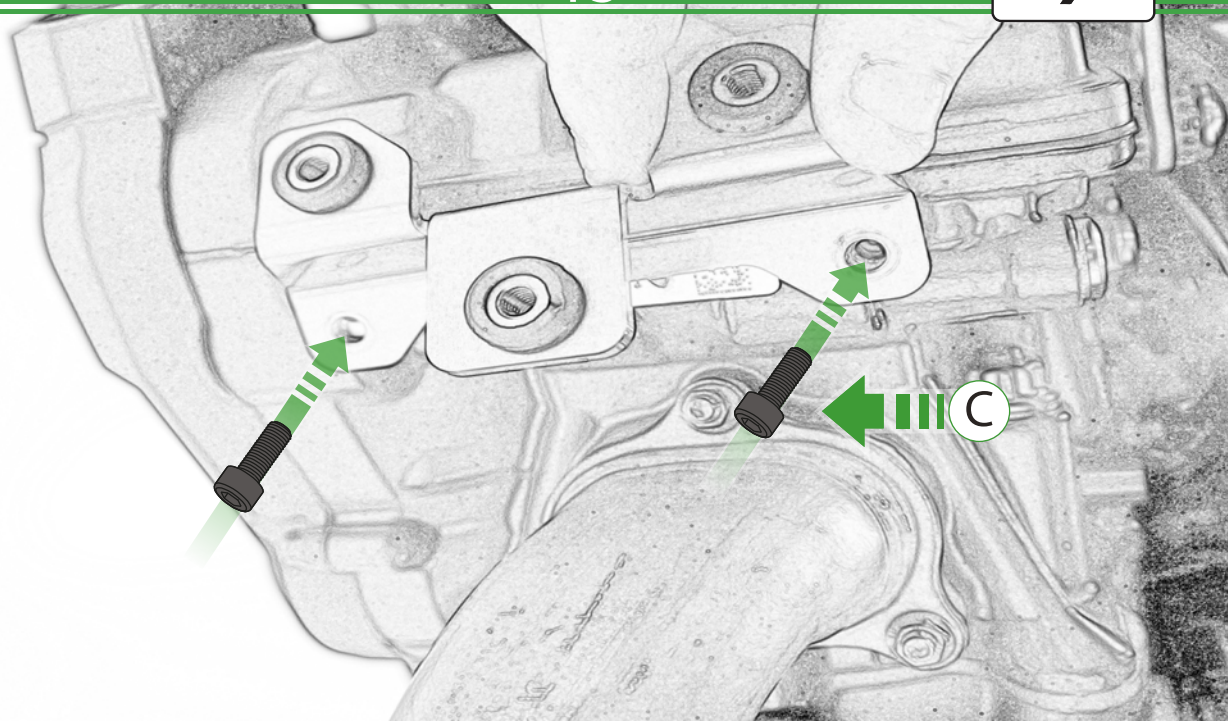

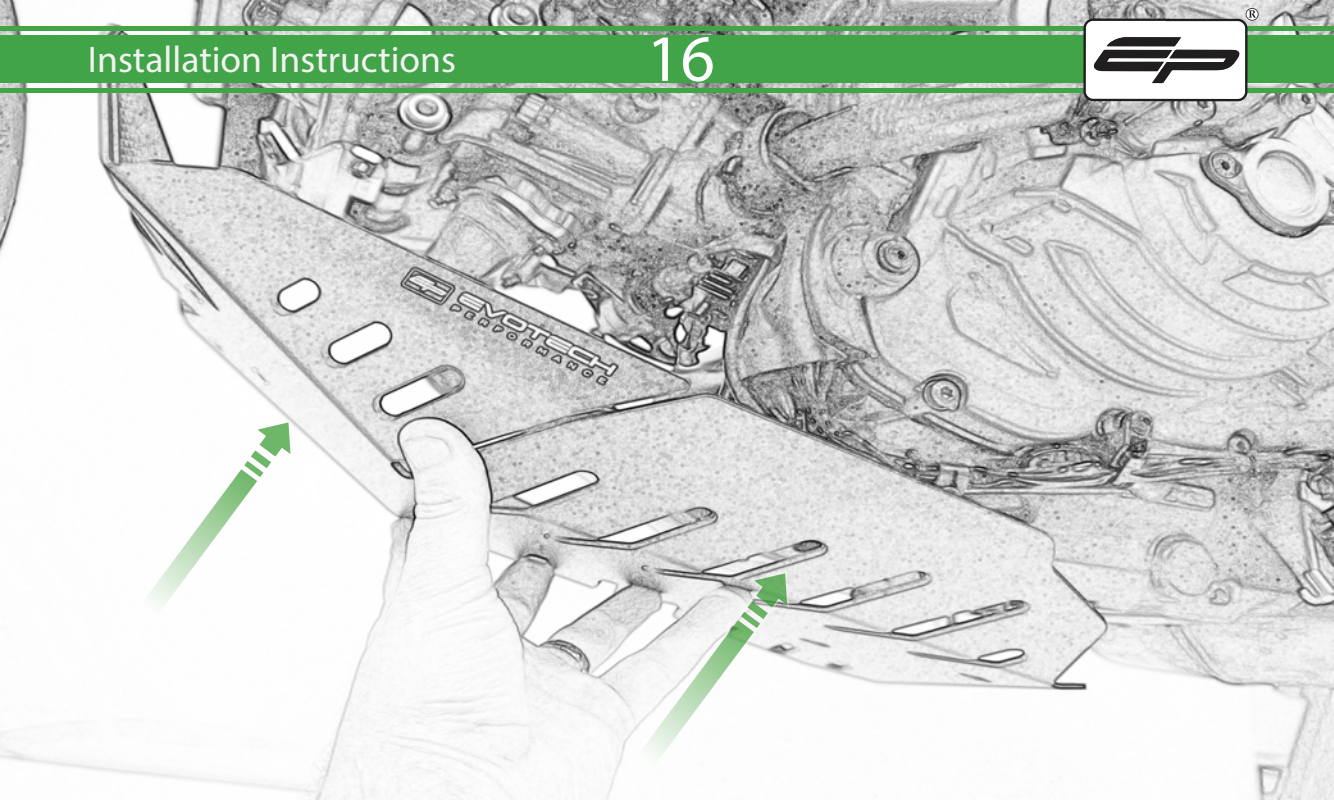

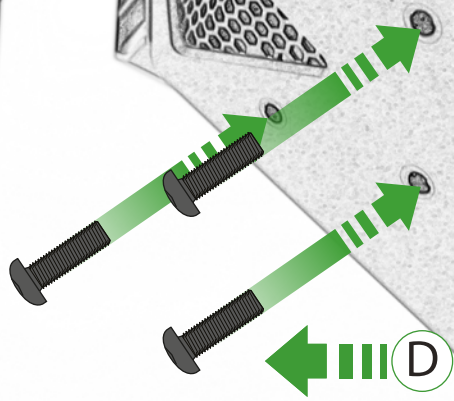

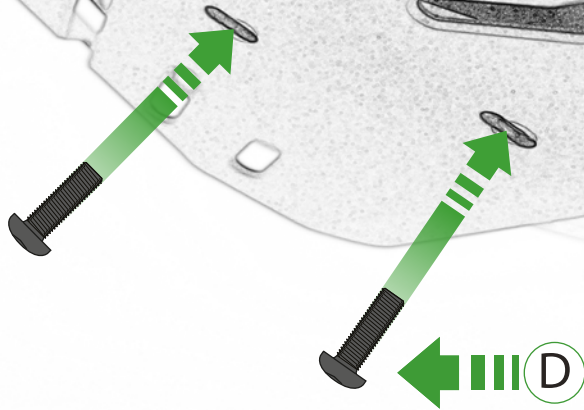



## ESSENTIAL CHECKS

It is recommended that periodic inspections are made to ensure that all bolts are tightened to the specified torque settings.

Should the bike be involved in an accident a thorough inspection should be made and any components that have taken an impact, no matter how small, be replaced



**EVOTECH**®  
P E R F O R M A N C E

[www.evotech-performance.com](http://www.evotech-performance.com)