



EVOTECH®
P E R F O R M A N C E

www.evotech-performance.com

Kawasaki Z H2 Exhaust Hanger

Installation Instructions



Kit Contents PRN014986

- (A) 1 x Spacer
- (B) 1 x Rubber Grommet
- (C) 1 x M8 Flange Nut
- (D) 1 x M8 x 25mm Button Head Bolt
- (E) 2 x M8 x 20mm Button Head Bolt

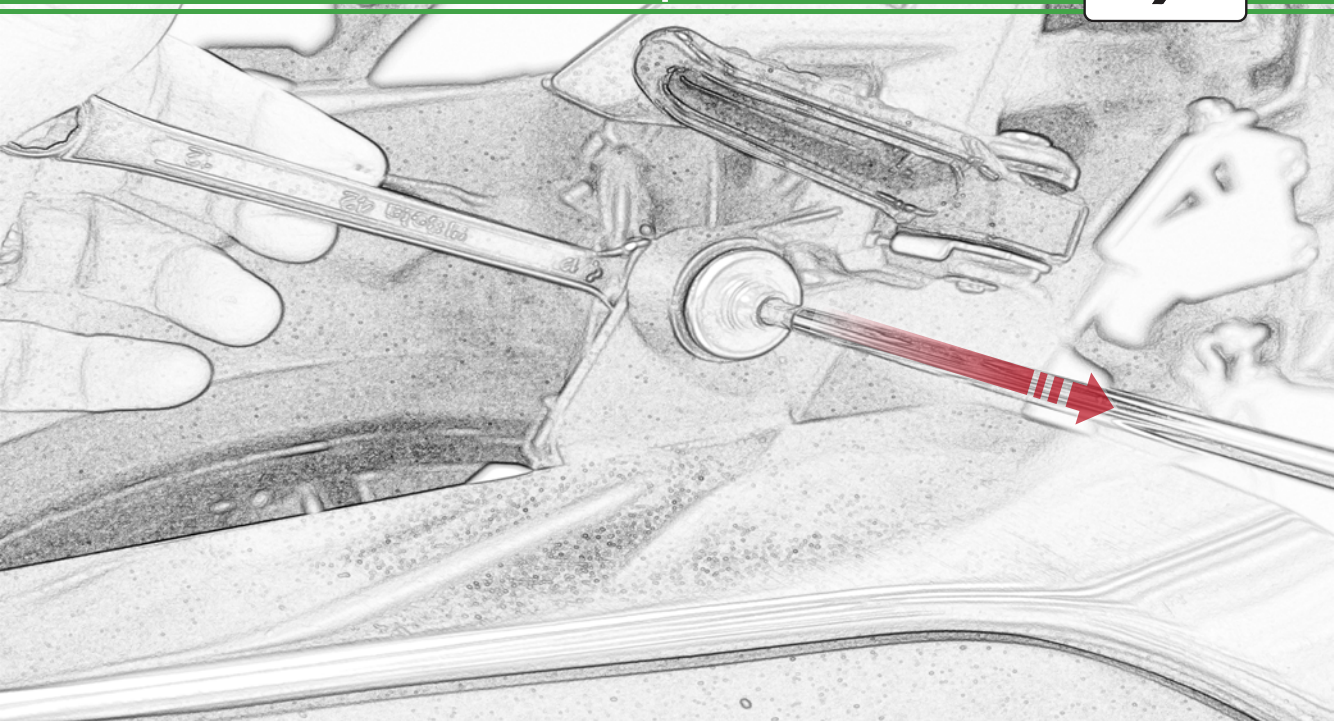

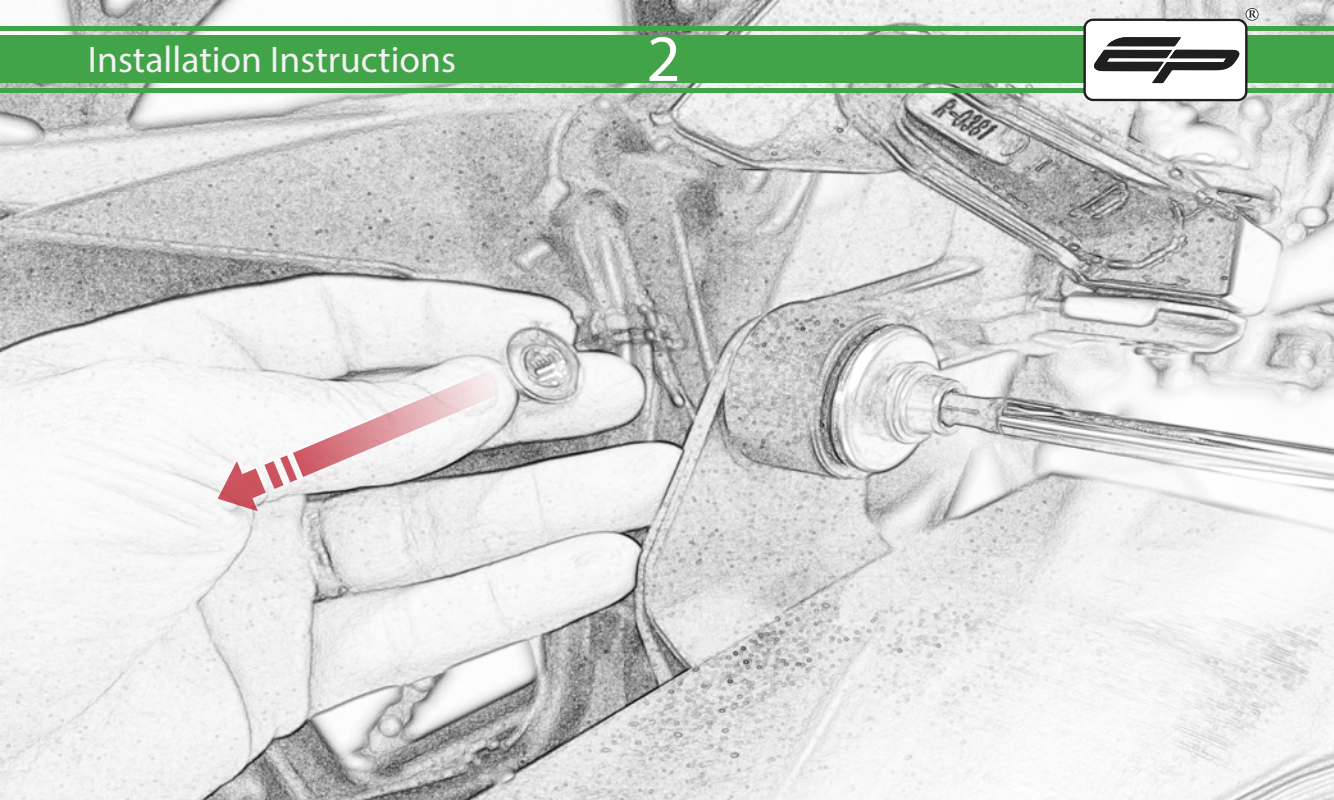

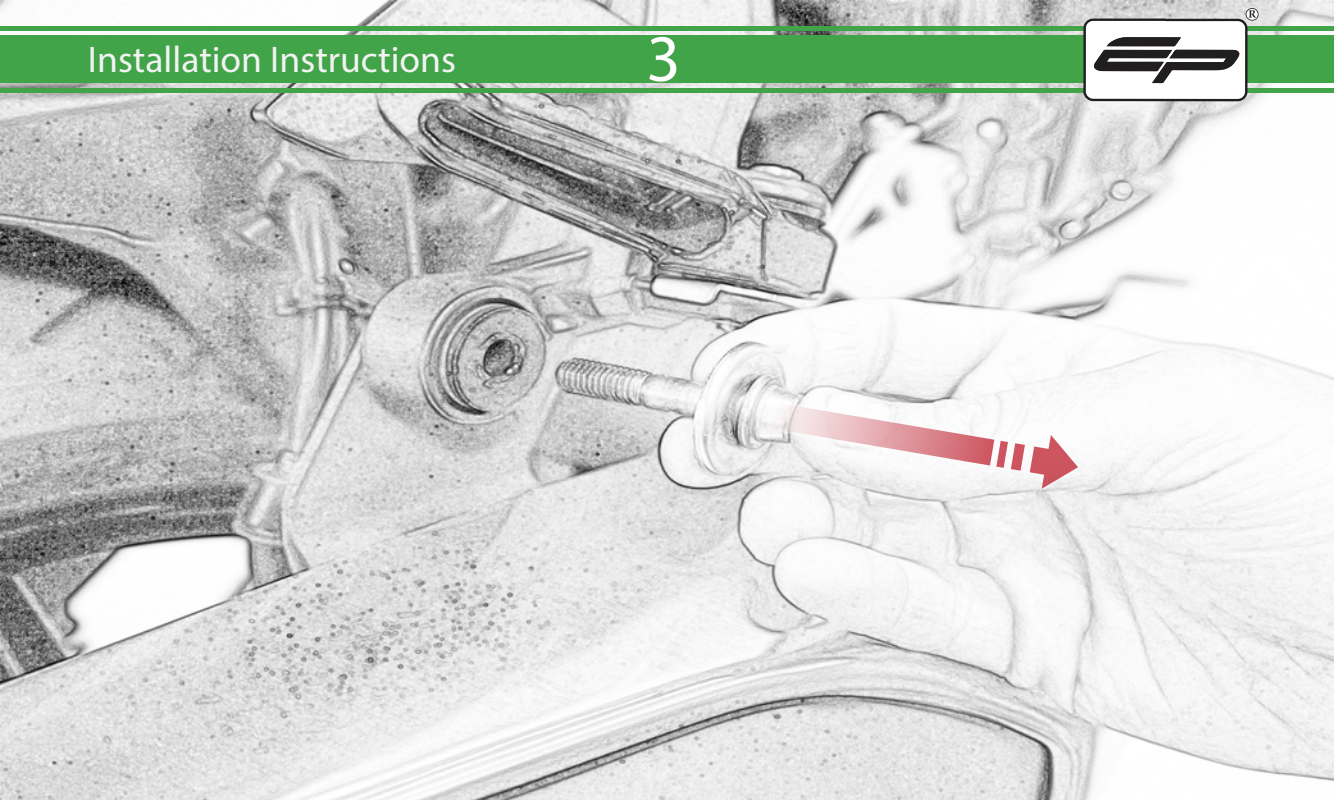

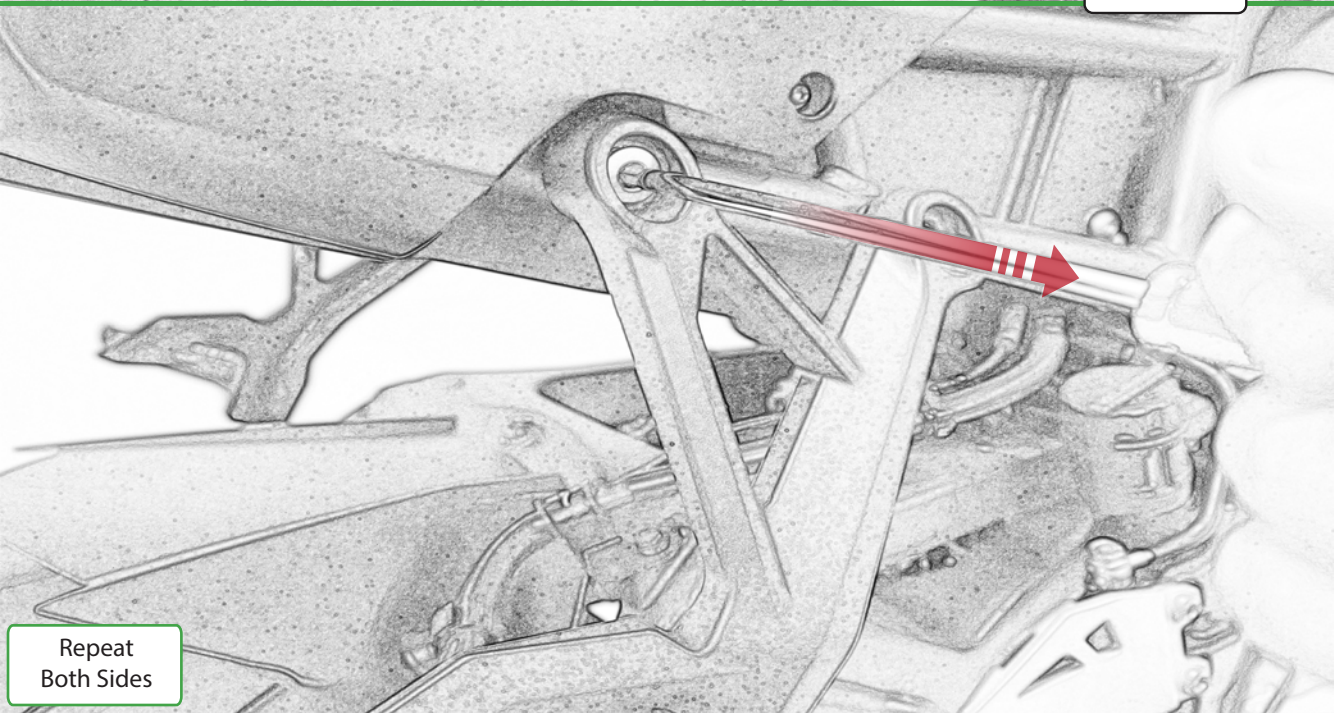

Repeat
Both Sides

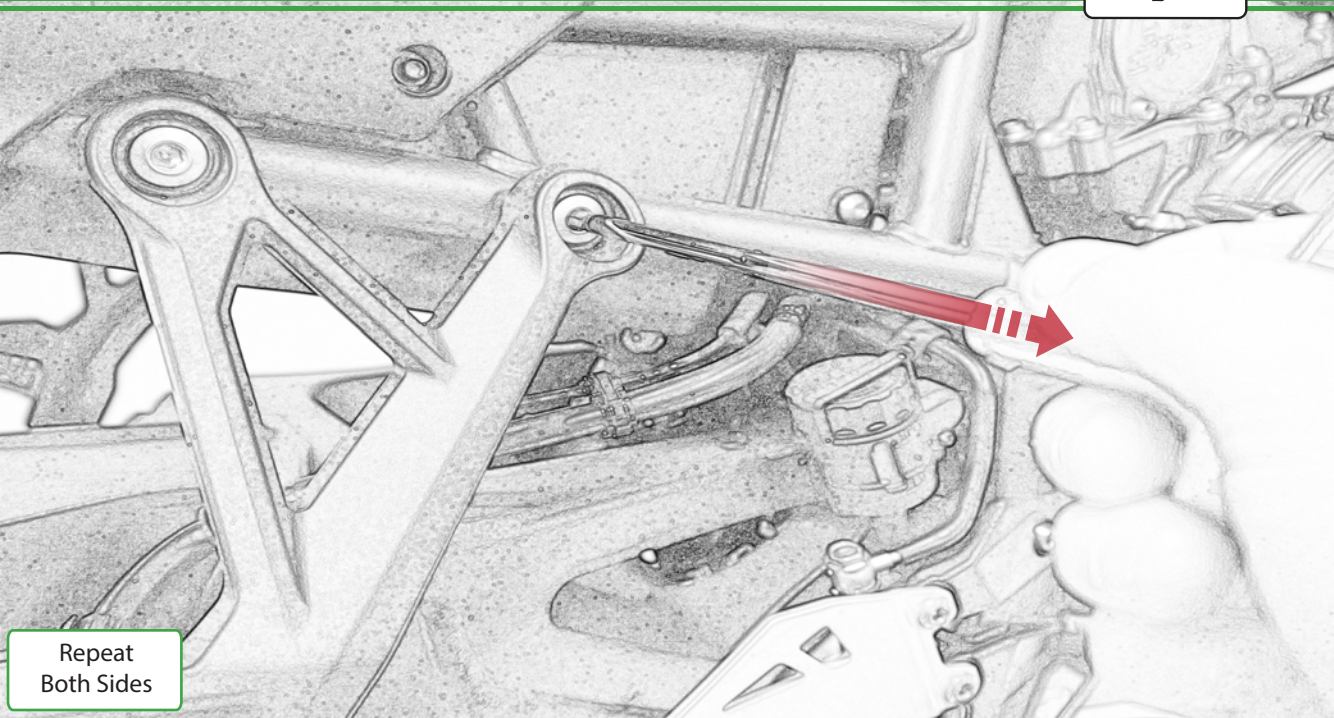

Repeat
Both Sides

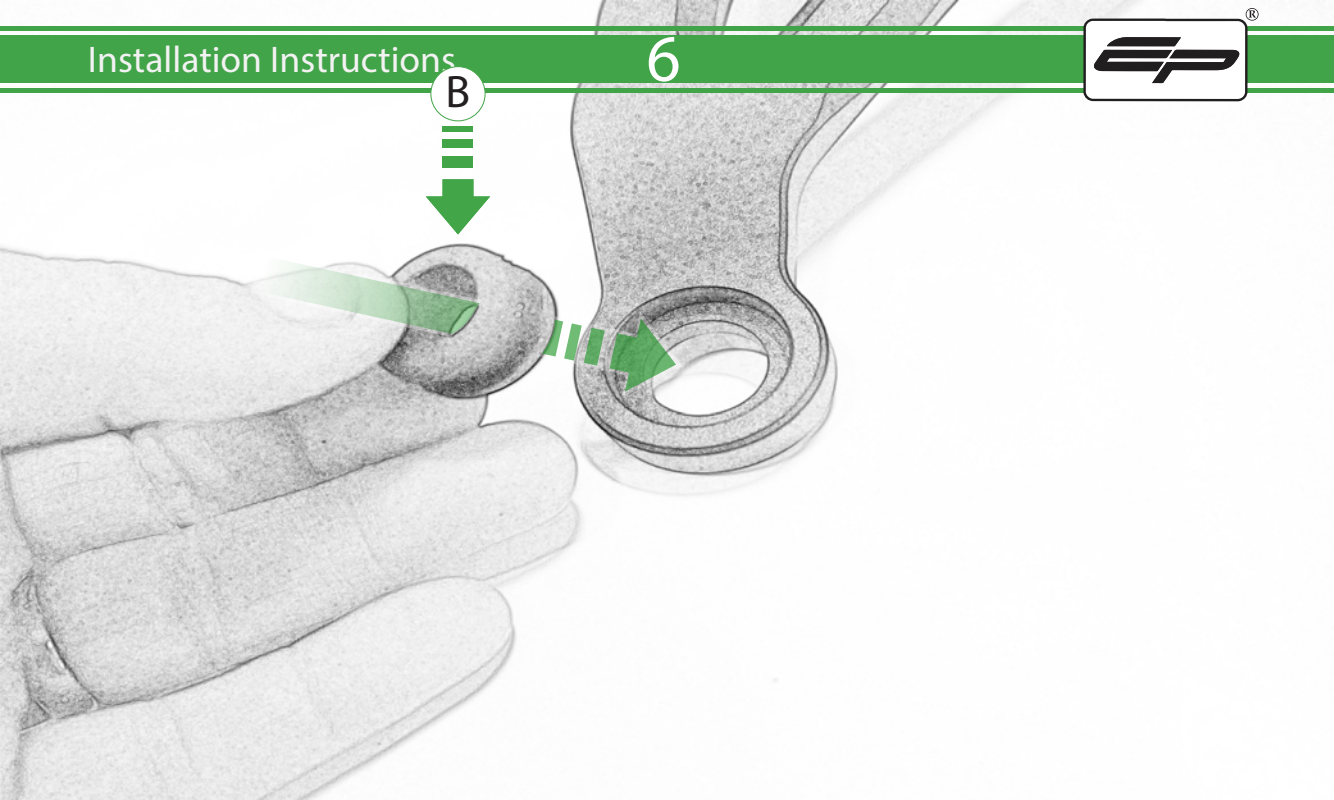



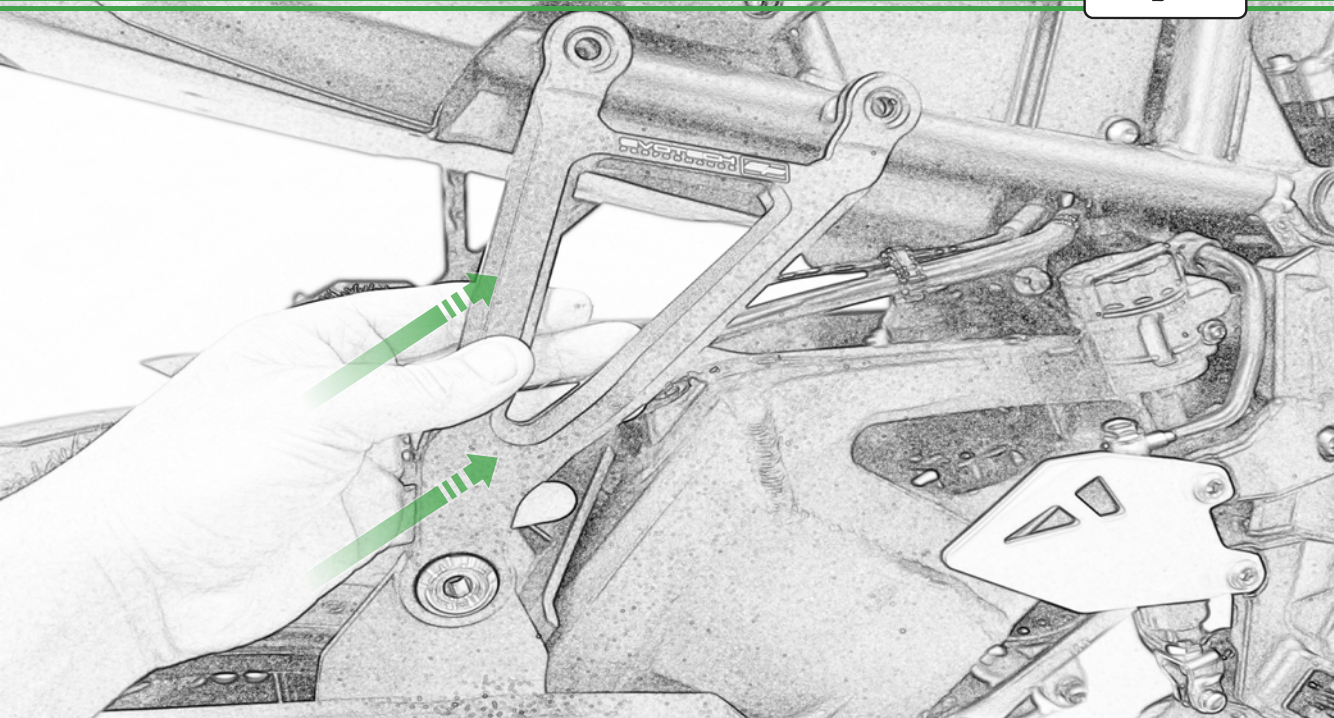

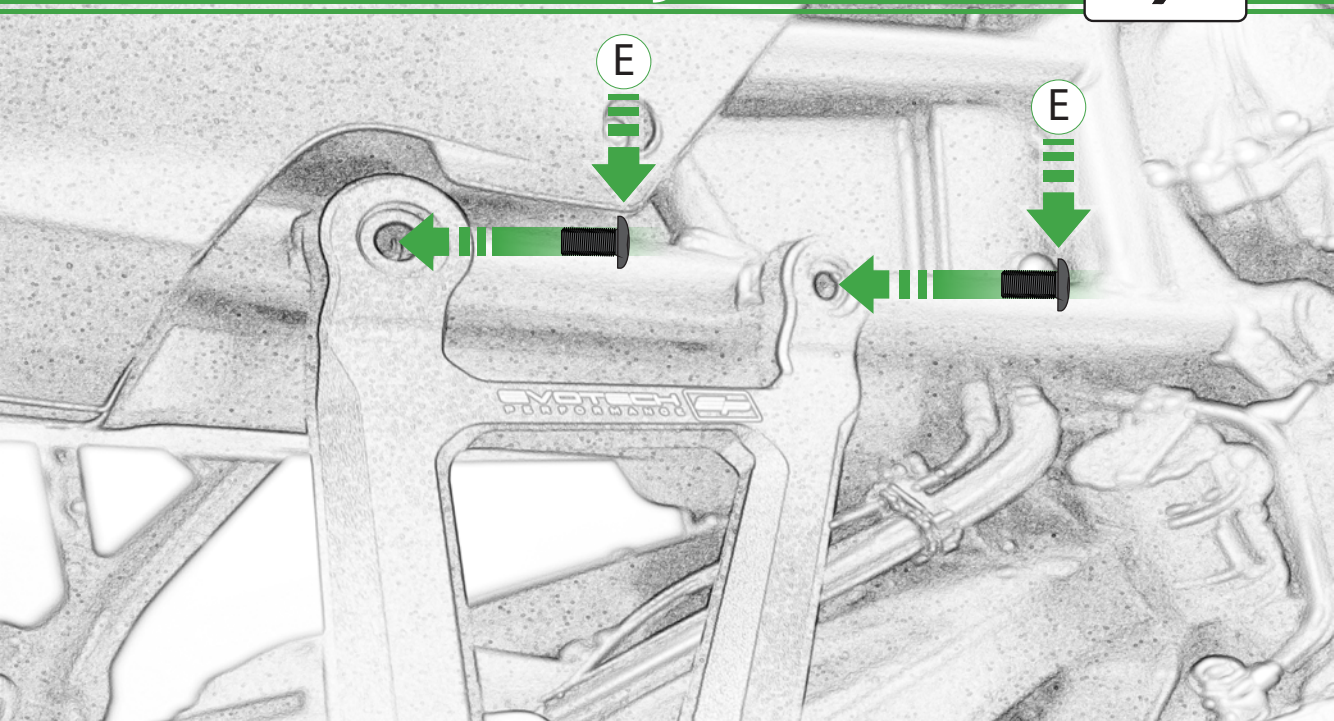

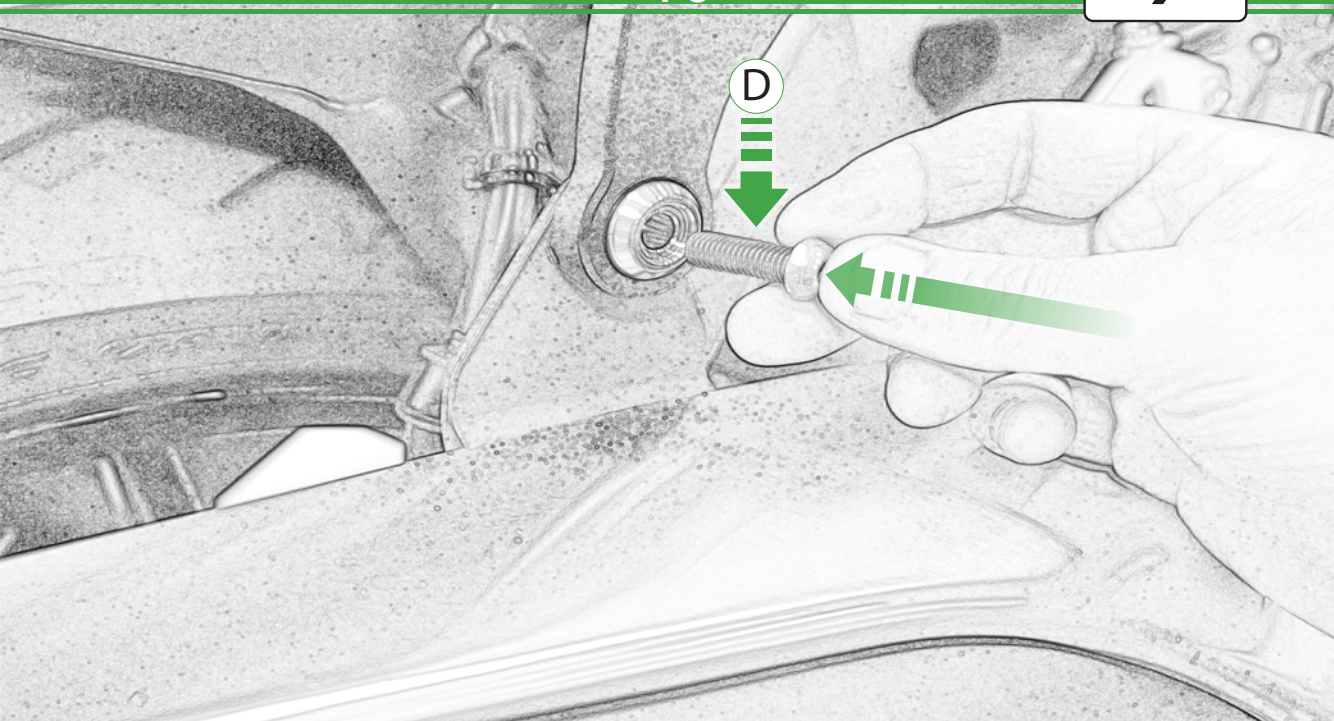



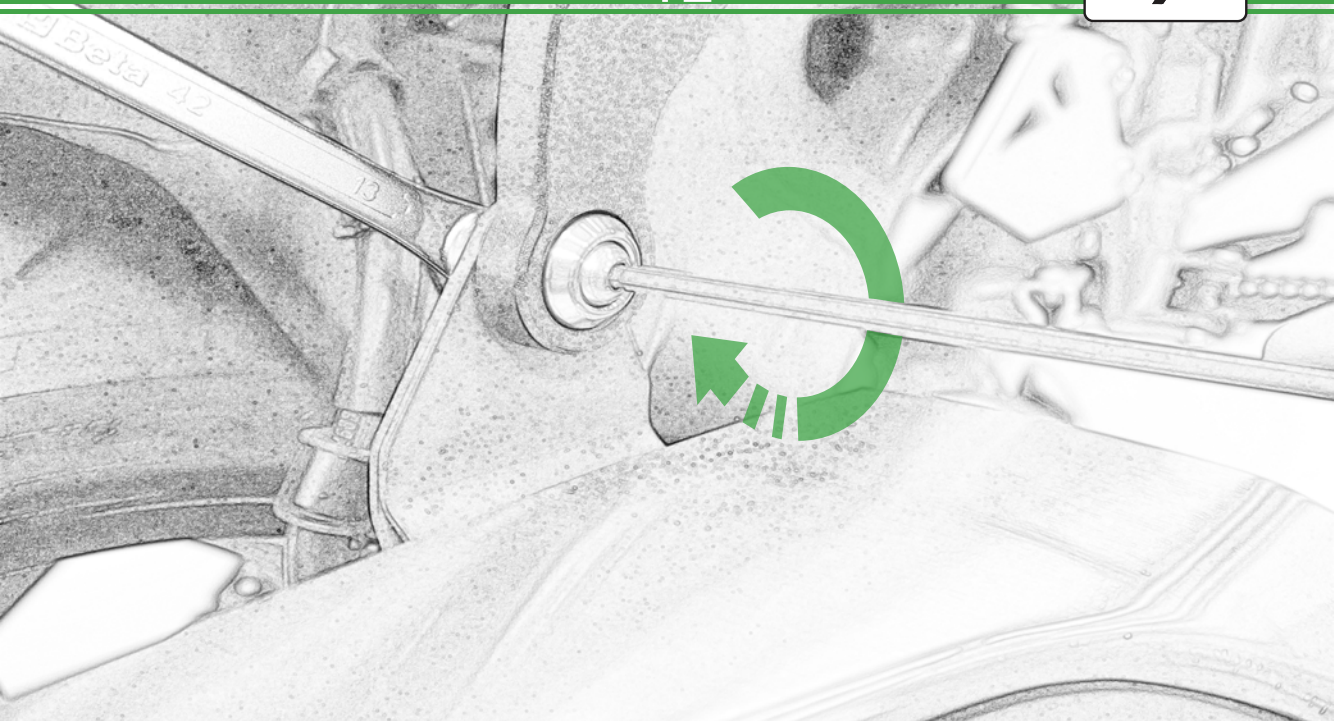



ESSENTIAL CHECKS

It is recommended that periodic inspections are made to ensure that all bolts are tightened to the specified torque settings.

Should the bike be involved in an accident a thorough inspection should be made and any components that have taken an impact, no matter how small, be replaced



EVOTECH®
P E R F O R M A N C E

www.evotech-performance.com