



EVOTECH®
P E R F O R M A N C E

Installation Instructions

KAWASAKI Z250 SL / NINJA 250 TAIL TIDY

Product Reference - 12888

Kit Contents

- | | |
|--|--|
| A 1 x Main Tail Tidy | H 2 x Male Bullet Connectors |
| B 1 x Tail Tidy Sub Bracket | I 2 x Plastic Screws |
| C 1 x Reflector Bracket | J 2 x Plastic Nuts |
| D 1 x LED Light Unit | K 4 x M6 - 25 Socket Button Heads |
| E 1 x Wiring Harness | L 4 x M6 Flange Nuts |
| F 2 x M4 - 10 Socket Button Heads | M 4 x Mounting Spacers |
| G 2 x M3 - 12 Socket Button Heads | N 5 x Cable Ties |

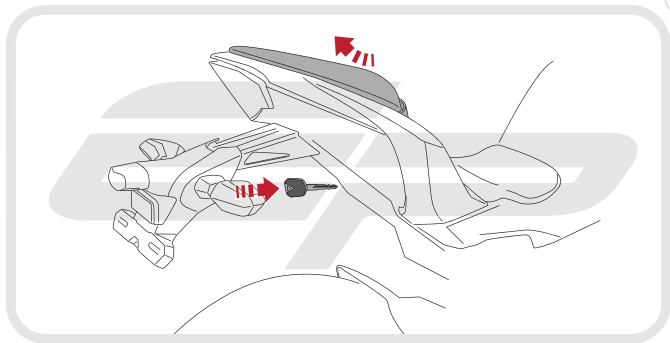

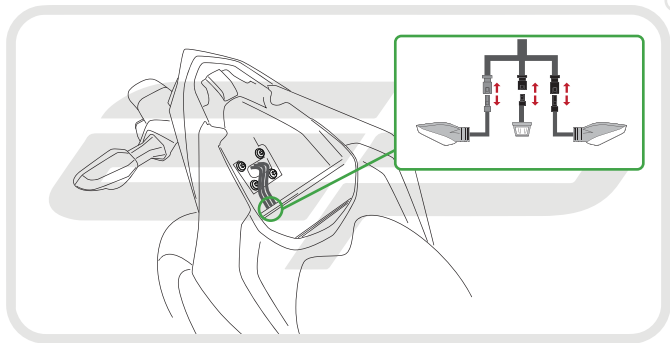

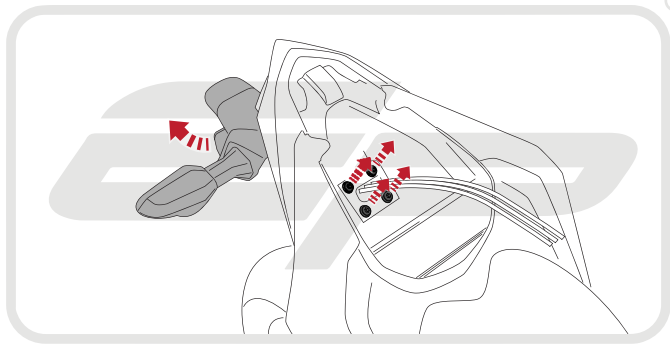

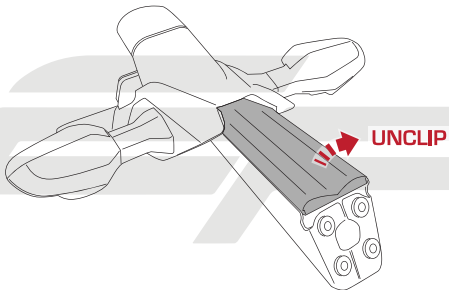

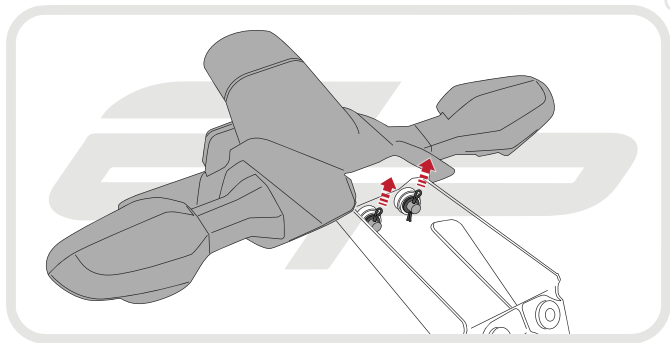

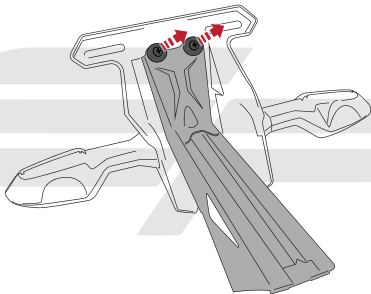

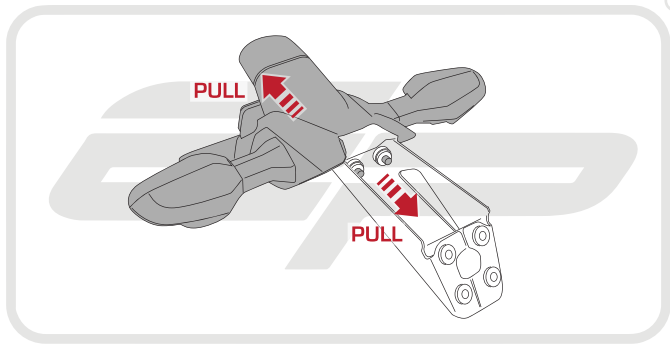

Remove Left and Right indicators
from original tail unit

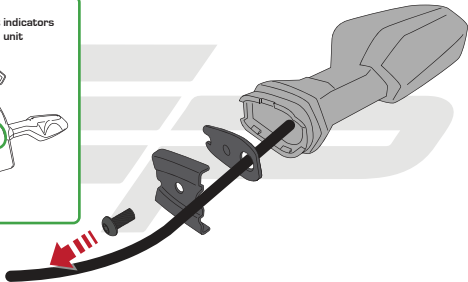



Caution

Re-fit indicators to new tail tidy.
Ensure drain holes face down
when tail tidy offered to bike

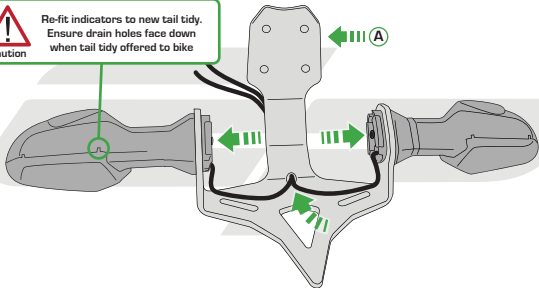

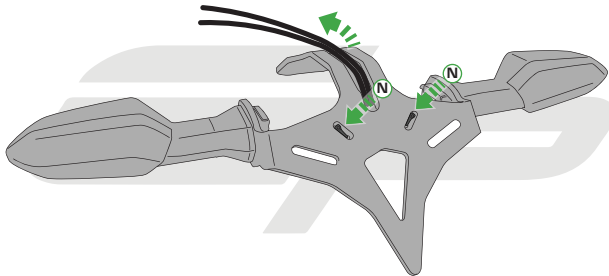

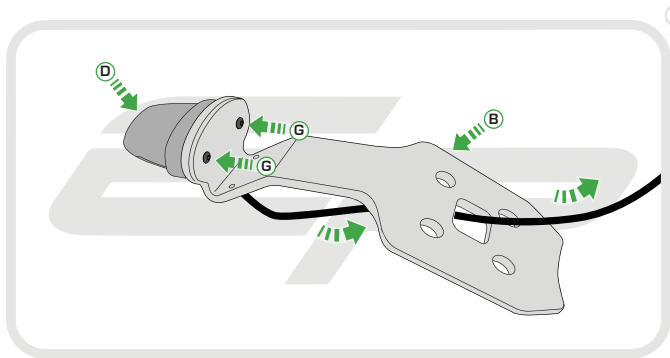



Caution

Ensure wires sit neatly in the grooves of both upper and lower parts of the Tail Tidy

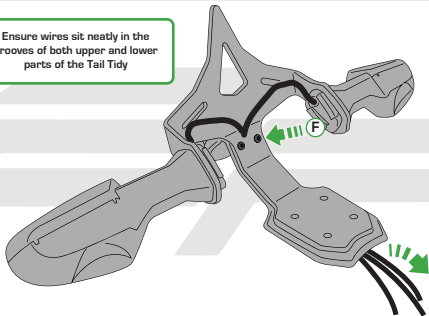

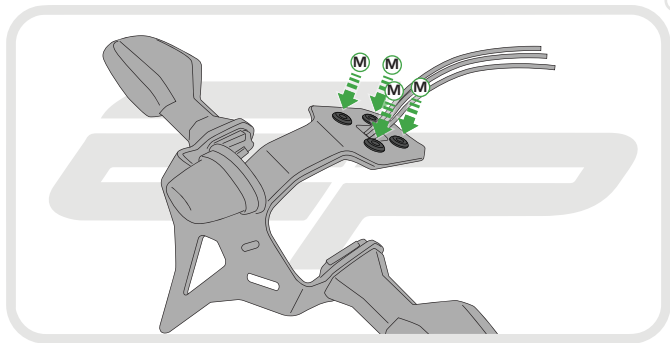

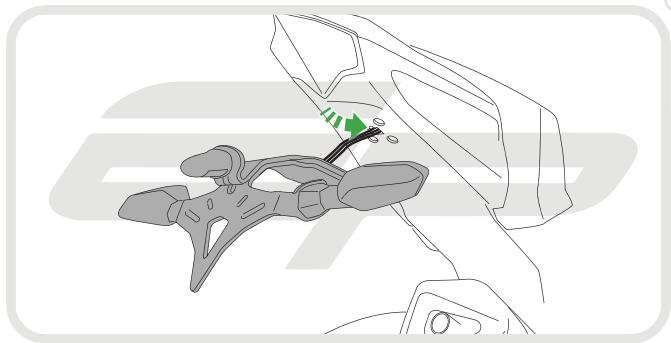

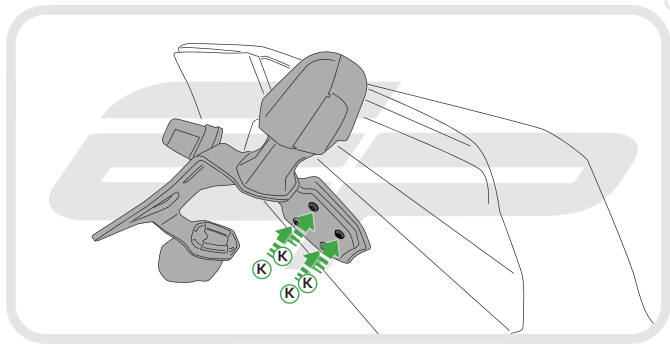

EVOTECH[®]
P E R F O R M A N C E

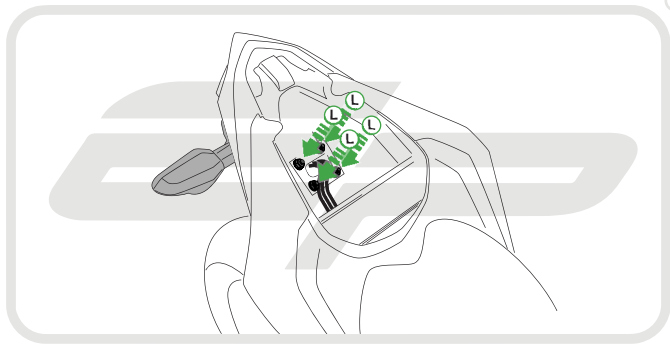

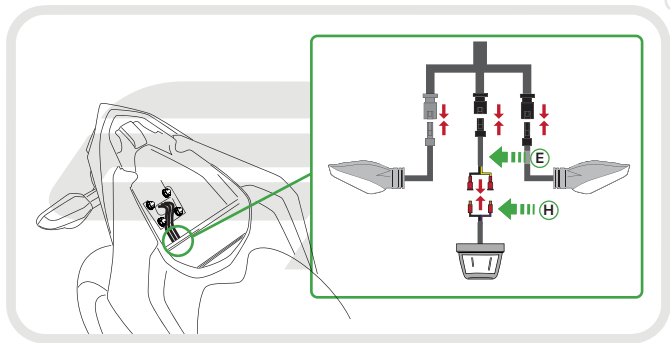



Reverse Stage 1

Reflector Bracket Installation

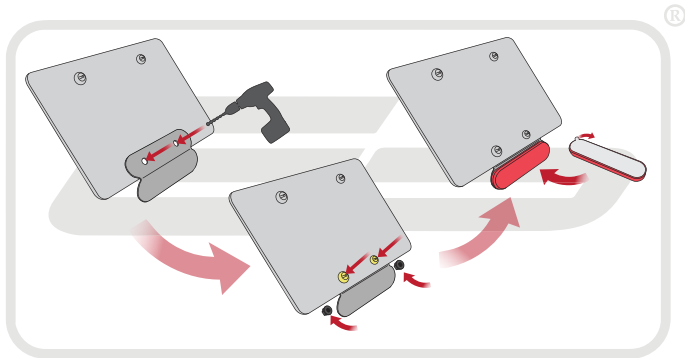

EVOTECH[®]
P E R F O R M A N C E



 **ESSENTIAL CHECKS** 

After installation of your tail tidy ensure that the licence plate does not contact the rear tyre when suspension is fully compressed.

Ensure all electrics including indicators, tail light, brake light and licence plate light lights are working correctly before riding the motorcycle.

It is recommended that periodic inspections are made to ensure that all fixings are fully tightend.



EVOTECH®
P E R F O R M A N C E

www.evotech-performance.com