

DENALI™

LAH.05.10300

HEADLIGHT MODULE ADAPTER

SUZUKI
DR-Z400
DR-Z400E
DR-Z400S
DR-Z400SM

Thank you for choosing DENALI

We know you would rather be riding your bike than wrenching on it, so we go the extra mile to make sure our instructions are clear and as easy to understand as possible. If you have any questions, comments, or suggestions don't hesitate to give our gear experts a call at 855.255.5550 or visit DenaliElectronics.com/instructions.

Please Read Before Installing

DENALI products should always be installed by a qualified motorcycle technician. If you are unsure of your ability to properly install a product, please have the product installed by your local motorcycle dealer. DENALI takes no responsibility for damages caused by improper installation. **Caution:** When installing electronics is it extremely important to pay close attention to how wires are routed, especially when mounting products to the front fender, front forks, or fairing of your motorcycle. Always be sure to turn the handlebars fully left, fully right, and fully compress the suspension to ensure the wires will not bind and have enough slack for your motorcycle to operate properly.

Installation Tips

We strongly recommend using medium strength liquid thread locker on all screws, nuts, and bolts. It is also important to ensure that all hardware is tightened to the proper torque specifications as listed in your owner's manual. For included accessory hardware please refer to the default torque specifications provided below. Inspect all hardware after the first 30 miles to ensure proper torque specifications are maintained.

| Bolt Size | in-lbs | ft-lbs | Nm |
|-----------|-------------|-------------|---------|
| M3 | 10.0 in-lbs | - | 1.0 Nm |
| M4 | 23.0 in-lbs | - | 2.5 Nm |
| M5 | 44.5 in-lbs | 3.5 ft-lbs | 5.0 Nm |
| M6 | 78.0 in-lbs | 6.5 ft-lbs | 9.0 Nm |
| M8 | - | 13.5 ft-lbs | 18.0 Nm |
| M10 | - | 30.0 ft-lbs | 41.0 Nm |
| M12 | - | 52.0 ft-lbs | 71.0 Nm |

Hardware Sizing Guide

Not sure what size bolt you have? Use this ruler to measure screws, bolts, spacers, etc. Remember, the length of a screw or bolt is measured from the start of the "mounting surface" to the end of the screw, so only include the screw head when measuring countersunk screws.

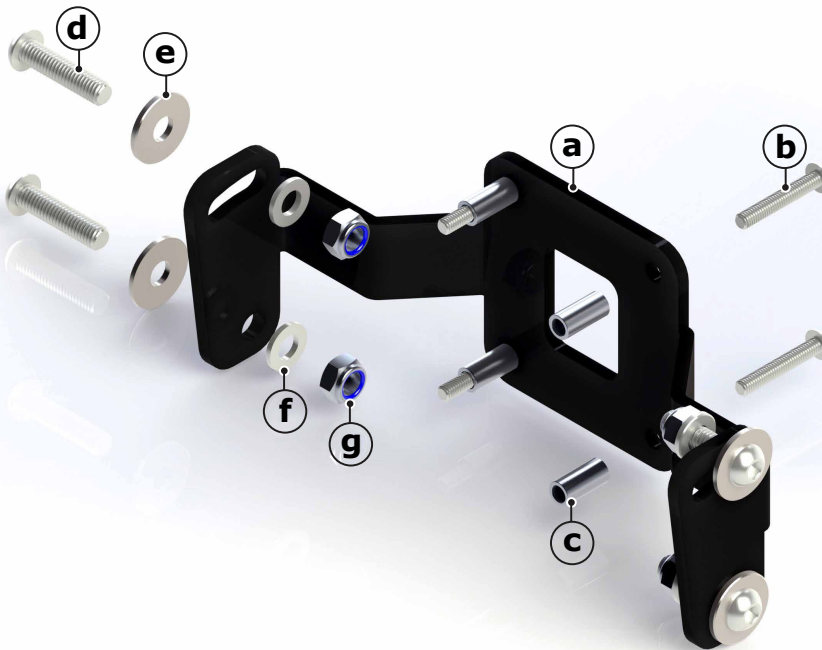
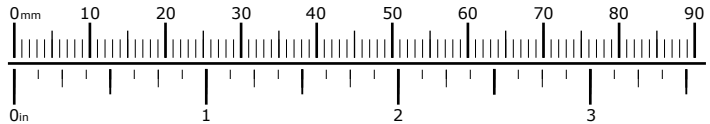

Kit Contents

- (a) Bracket (LAH.05.005).....Qty 1
- (b) M4x25 ISO 7380.....Qty 4
- (c) OD:6mm ID:4mm L:13mm.....Qty 4
- (d) M6x25 ISO 7380.....Qty 4
- (e) Large M6 Washer DIN 9021..Qty 4
- (f) Small M6 Washer DIN 125.....Qty 4
- (g) M6 Lock Nut DIN 985.....Qty 4

Tools Required

- 4mm Allen Key
- 10mm Wrench
- Phillips Screwdriver

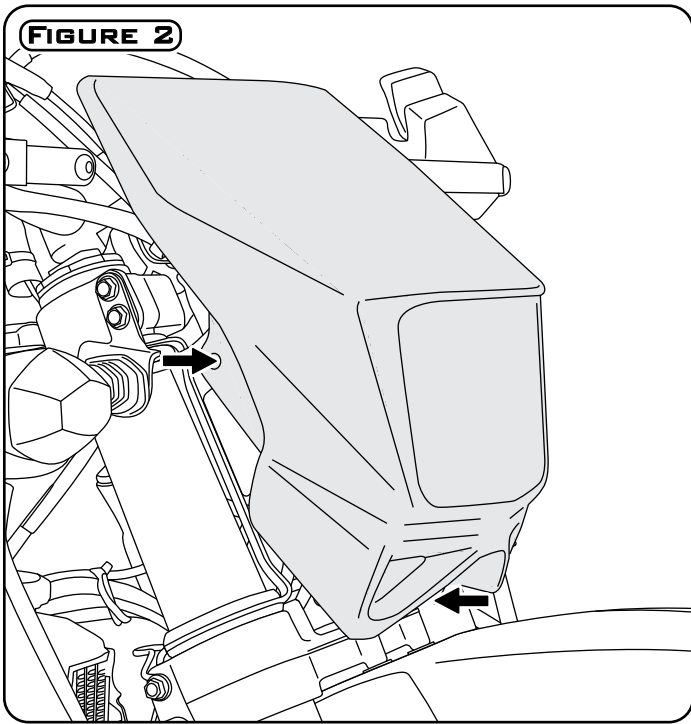

Removing The OEM Headlight

Step One: Uninstall the headlight mask by removing the three mounting screws. There will be one each side and one on the bottom center.

Step Two: Remove and unplug the OEM sealed beam by removing the four mounting screws. There will be two on each side.

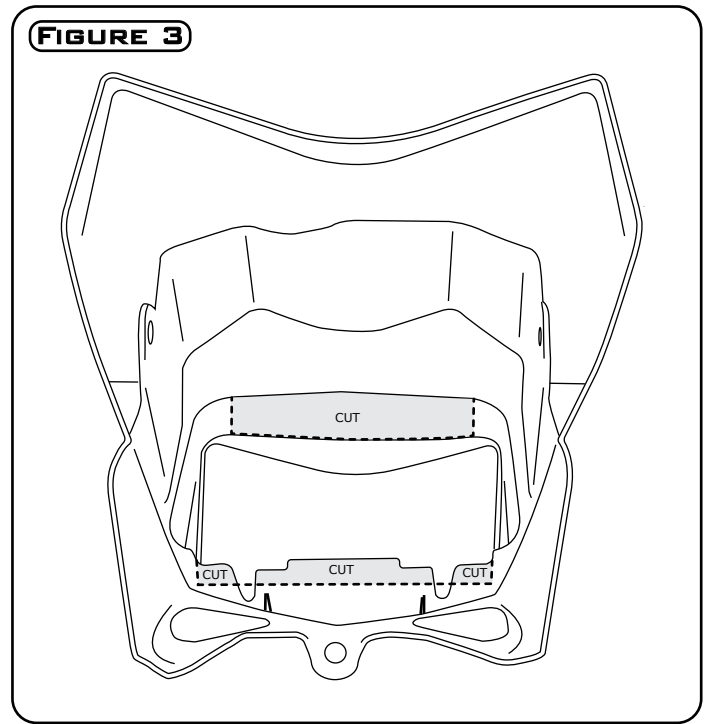

Trimming The Headlight Mask

Step Three: Use a utility knife to remove the sections of plastic illustrated above. The plastic only needs to be trimmed down to the inner lip.

Note: If you look closely you can see seams in the plastic, the cut lines are placed on these seams.

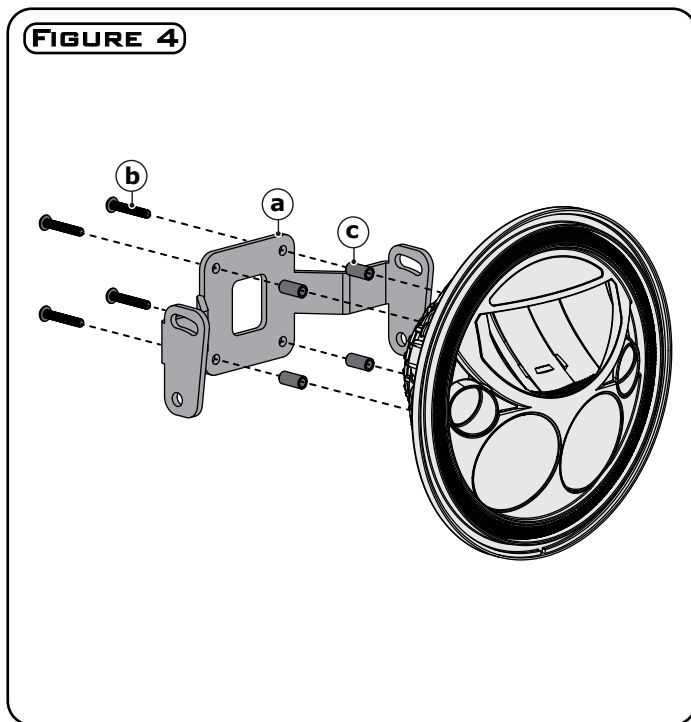

Mounting The Bracket

Step Four: Remove the four original socket head bolts from the rear of the light.

Step Five: Use the M4x25 bolts (b) and spacers (c) to bolt the bracket (a) to the rear of the LED headlight module.

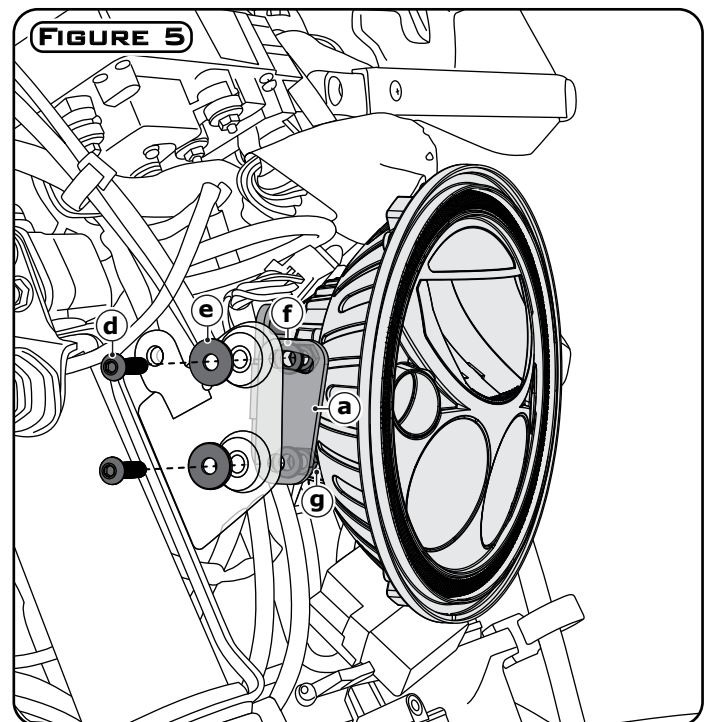

Installing The LED Headlight Module

Step Six: Use M6x25 bolts (d), large washers (e), small washers (f) and nuts (g) to attach bracket (a) to the OEM headlight mounting tabs.

Step Seven: Before fully tightening the bolts be sure to properly aim the headlight. Adjustments can be made at the top slotted mounting point

Note: Please refer to the instructions manual of the M7 LED DOT Headlight Module for

wiring instructions.

Step Eight: Reinstall the headlight mask using the OEM hardware.