

**Preparation**

1. If the handlebar grips are not open at the end they will need to be cut open for the handguard to be fitted. Use a sharp knife to cut a hole in the end of each handgrip. On the right side the hole size should be neat and no smaller than the inside diameter of the throttle tube. Loosen the throttle assembly to move it outward about 20mm. Roll back the end of the grip and use a hacksaw to carefully cut off the end cap of the plastic throttle tube. Do not remove more than 3mm and take care not to cut the underlying handlebar. Before refitting, remove any burrs that could restrict throttle movement.
2. Inside the handlebar is a fixed weight with a hole. Drill the hole out to 6.8mm then tap an M8x1.25mm thread into the hole.

**Fitting Procedure** (shown for right side, repeat for left side)

1. Loosely assemble the clamp (3) to the handlebar as per *Diagram A*.
2. Attach the handguard backbone with applicable parts to the handlebar end and the clamp (3). Do not tighten bolts yet.
3. Position backbone so it is horizontal when viewed from the side and tighten all bolts in the following order. (6), (4) then (5).

**Important:** Use the specified torque setting over page.

**Right side Clamp Location**



**Right side Clamp Assembly**

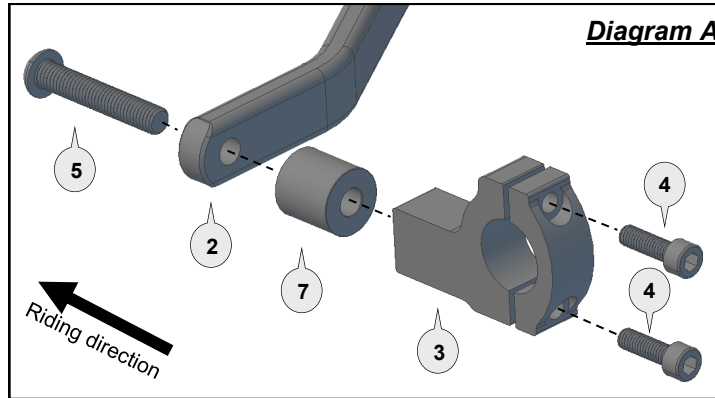

**Right side Bar End Assembly**

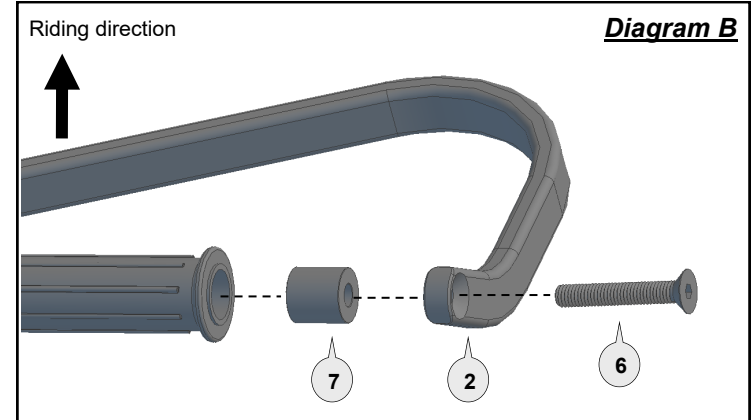

**Bar Side View**

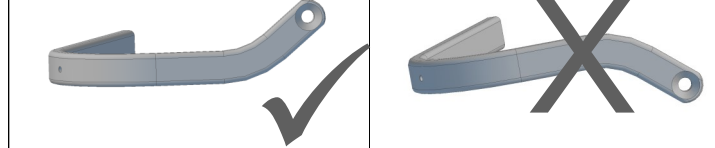

**Personalise Your Protection**

Guard options sold separately



Phone: +61 (0)2 4271 8244  
Email: info@barkbusters.net

**1** Aluminium Backbone



PN: BAR-V038-L  
Pcs. 1 Left

**2** Aluminium Backbone



PN: BAR-V038-R  
Pcs. 1 Right

**3** Clamp

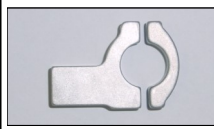

PN: CLAMP-22  
Pcs. 1 pair

**4** Socket Head Bolt 20mm



PN: M6x20SHCSZP  
Pcs. 4

**5** Button Head Bolt 45mm

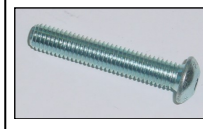

PN: M8x45BHCSZP  
Pcs. 2

**6** Flat Head Bolt 45mm



PN: M8x45FHCSZP  
Pcs. 2

**7** Spacer 20mm

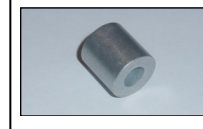

PN: BSSRT20  
Pcs. 4

Recommended Torque Settings	
M6	10 Nm (7.4 lbf ft)
M8	20 Nm (14.8 lbf ft)

**CAUTION:**

Installation of the handguard is safety-relevant work and can be complicated. We recommend the installation be performed by a motorcycle service technician. Rideworx accepts no liability for damages caused by improper mounting. All screws, bolts and nuts, including all replacement hardware provided by Rideworx, should be tightened to the torque specified in the below table. After the first 50km of riding check all screws, bolts and nuts are tightened to the correct torque. We recommend a medium strength liquid thread lock product on all fasteners.

**WARNING:**

It is important there is a working clearance (approx 3mm) between the throttle grip end and the handguard to ensure a free closing throttle. Check operation of all handlebar controls, specifically the throttle, front brake, kill switch and clutch to ensure they are operating correctly and are in accordance with the OEM specifications. Do not ride the motorcycle if any controls are not operating correctly. Check periodically that all bolts are tight.



Phone: +61 (0)2 4271 8244  
Email: [info@barkbusters.net](mailto:info@barkbusters.net)  
Web: [www.barkbusters.net](http://www.barkbusters.net)



**Disclaimer:**

A failure to follow these fitting instructions could cause serious injury, death or property damage. These handguards are intended solely for use with motorcycles/ATV/snowmobiles/scooters that have not been modified. They are not designed to prevent injury or death while riding or in an accident or crash. The user must ensure that all controls are free of the handguards every time that they ride. By installing and/or using this product you acknowledge that you accept these terms and have followed the fitting instructions.