

**Paul Yaffe's
Bagger
Nation™**



**SHARKNADO FAIRING
SPORT GLIDE
INSTALL
INSTRUCTIONS**



PAUL YAFFE ORIGINALS
DESIGN & DEVELOPMENT

Thank you for purchasing Paul Yaffe's Bagger Nation products. Please read through these installation tips completely before installing your Sharknado Fairing Kit.



1.
Removing
Outer Trim Ring

1. Unclip & Remove your stock fairing. Open headlight housing by removing outer trim ring. Remove inner headlight body trim ring (3 screws). Separate headlight body & shell at top just enough to unplug wire connector plug. (Reassemble headlight). Remove lower headlight mount block screws (under triple tree) roll headlight to left to expose opening (wire exit) on back. Clip the wire tie & remove wire harness set headlight aside. (Fig 1-1e)



1a.
Three Screws/ Trim Ring



1b.
Inner Headlight Trim Ring



1c.
Remove Harness From
Headlight



1d.
Remove Headlight Block Screws

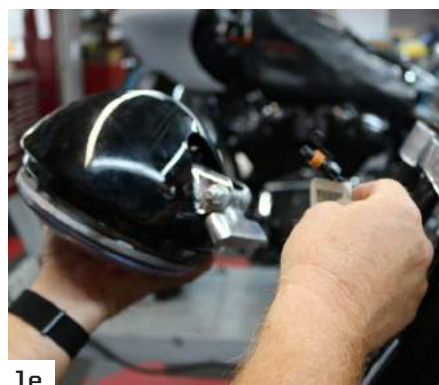

1e.
Unplug Wire Connector



1f.
Cut Zip Tie

2. Locate your Sharknado main fairing support plate. The main fairing support plate will mount underneath your upper triple tree between the handlebar riser bolts and the lower riser bushing cups. When installed correctly the main fairing support plate will be pointing towards the front of the bike with a downward angle. (Fig #2-2b)



2.
Riser Bolts

TIP: Remove one riser bolt first, install one side of the main fairing support plate then lock-tite and reinstall the first riser bolt (don't fully tighten at this time). Then remove the remaining riser bolt and rotate the main riser support plate into place. Lock-tite and replace second riser bolt. Both riser bolts can be fully tightened at this time.



2a.
Main Support Plate Installed



2b.
Downward Angle

3. Attach Part #1 of the lower fairing support bracket to the bottom of the lower triple tree and secure* using (2) 5/16 x 1 1/4" button head cap screws, (2) 5/16 nylock nuts and (2) 5/16 flat washers provided.

The slotted tab should face down and towards the front of your bike as demonstrated in (Fig #3).

* If installing your Sharknado Fairing on a model "other" than a sport glide, use the "center" hole on our lower fairing support bracket and bolt the bracket underneath your bottom triple tree reusing the bolt from your headlight & the 3/8x 24 nut & flat washer provided.



3.
Part # 1 Lower Fairing Support

TIP: Skip step #4 and completely install your Sharknado & brackets. After completing fairing install and tightening all fasteners. Remove your Sharknado by removing the (3) upper bracket mounting screws and the (2) lower #2 bracket screws that attach it to the fairing. This allows fairing removal with all brackets remaining in place. Now install your headlight per step #4. (Fig 7b)

4. Place fairing headlight opening down on a soft surface. Locate headlight mount bracket and (2) 5/16 x 1" button heads (bracket to fairing), (2) 5/16 x 3/4" hex heads (bracket to headlight) (4) 5/16 nylock nuts and (8) 5/16 flat washers.

Lay the Fatbob headlight (HD Part #67700288-A or B) face down on the light opening inside of your Sharknado fairing. (protect the headlight lens with a soft towel or similar).



Headlight & Bracket Installed

With the headlight mount bracket arching towards the front of fairing, install the bracket to fairing and headlight using provided hardware. You can tighten bracket to fairing fasteners however, only snug headlight fasteners at this time to allow headlight beam adjustment later. (Fig #4)



Part #2 Lower Fairing Support Bracket

5. Install part #2 of the lower fairing support bracket to the two holes below the headlight in fairing using (2) 1/4 x 20 x 1" button head cap screws, (4) 1/4" flat washers and (2) 1/4" nylock nuts provided. Leave these fasteners loose at this time.

The receiver tab should face away from headlight as demonstrated in (Fig #5).

NOTE: Hardware in pictures may not be the same as hardware supplied with your Sharknado Kit. (yours is better)

6. At this time your fairing should be ready to hang! Simply slide the “fairing” mount tab on top of the main support bracket installed in step #2 and align the (3) mounting holes.

NOTE: The loose #2 lower fairing support is meant to sit “behind” the tree mounted #1 lower fairing support as shown in Fig 7a & 7b.

Install (3) 5/16 x 1 x 18 button heads, (6) 5/16 flat washers and (3) nylocks provided and lightly snug them at this time (Fig #6). Torque all lower fairing support bracket hardware at this time.



6.

Sharknado installed on upper bracket

Swing your front end slowly from left fork stop to right fork stop to verify Sharknado Fin clearance to engine. Sometimes accessory choices or engine mods can cause interference. Clearance if needed.

7. Now look behind the chin of your Sharknado Fairing and you’ll see the two lower fairing support tab faces touching each other and the slots and holes in each should be close to lining up (parallel). Use the (2) ¼ x 20 x 1 “ button head cap screws, (4) ¼ “ flat washers and (2) ¼ “ nylocks provided and bolt the two brackets firmly together.



7a.



7b.

NOTE: there should be very little gap to close when tightening these fasteners! Do not stress the fairing to close a larger gap. If there is an alignment issue STOP! Check your assembly steps and make sure you’ve correctly installed your Sharknado and it’s support brackets.

Once proper alignment is achieved you can tighten all mounting fasteners except (2) headlight to bracket. Your Sharknado Fairing should now be solidly installed and ready for the next steps.

NOTE: Hardware in pictures may not be the same as hardware supplied with your Sharknado Kit. (yours is better)

8. Plug your new headlight lead in, find a wall that you can you can park your bike 25' away from. Put a mark (tape) 3' high on the wall. Measure 25' away and put your bikes front tire on that mark facing the wall.

Turn on your power (low beam) and adjust the headlight beam so that the middle of beam is hitting your 3' mark. Tighten your headlight fasteners (Fig #8).

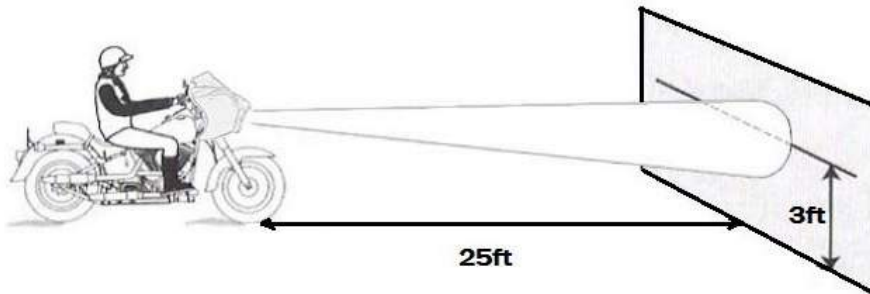

8.

9. Install your Klock Werks Flare Windshield choice using the (4) 10x32 x.75" black screws provided with (4) black nylon flat washers on outside of windshield and secure with 10/32 black nylock nuts provided. (Fig #9)



9.

That's it! You're done! Now go blow some minds at bike night! Thank you again for choosing our designs and we appreciate your support!

A stylized, handwritten signature in black ink, likely belonging to the company mentioned in the text.

1

2

3

4

ITEM NO.	Part Num	DESCRIPTION	QTY.
1	SCFB	Sharknado Glue-In Faring Bracket	1
2	SLMB-B	Black Sharknado Upper Mounting Bracket	1
3	SLMB	Sharknado's Lower Moveable Bracket	1
4	SLFB-W	Sharknado's Lower Fixed Bracket Weld Assembly	1
5	HM-MS	Mini Shark Headlight Mount	1
6	1/4-20 x 1 Zinc BH	Button Head Cap Screw	4
7	1/4 Zinc Flat Washer Type A (SAE)	Flat Washer	10
8	1/4-20 Nyloc Zinc	1/4-20 Zinc Nyloc Nut	4
9	5/16-18 x 1 Zinc BH	Button Head Cap Screw	3
10	5/16-18 Nyloc Nut	5/16-18 Zinc Nyloc Nut	9
11	5/16 Zinc Flat Washer Type A (SAE)	Flat Washer	14
12	5/16-18 x 0.75 Zinc HH Gr5	Hex Head	2
13	5/16-18 x 1.25 Zinc BH	Button Head Cap Screw	2
14	3/8-24 Zinc Nyloc Nut Gr5	Hex Nut Zinc Nyloc 3/8-24 Grade 5	1
15	5/16-18 x 1 Zinc HH Gr5	Hex Head	2

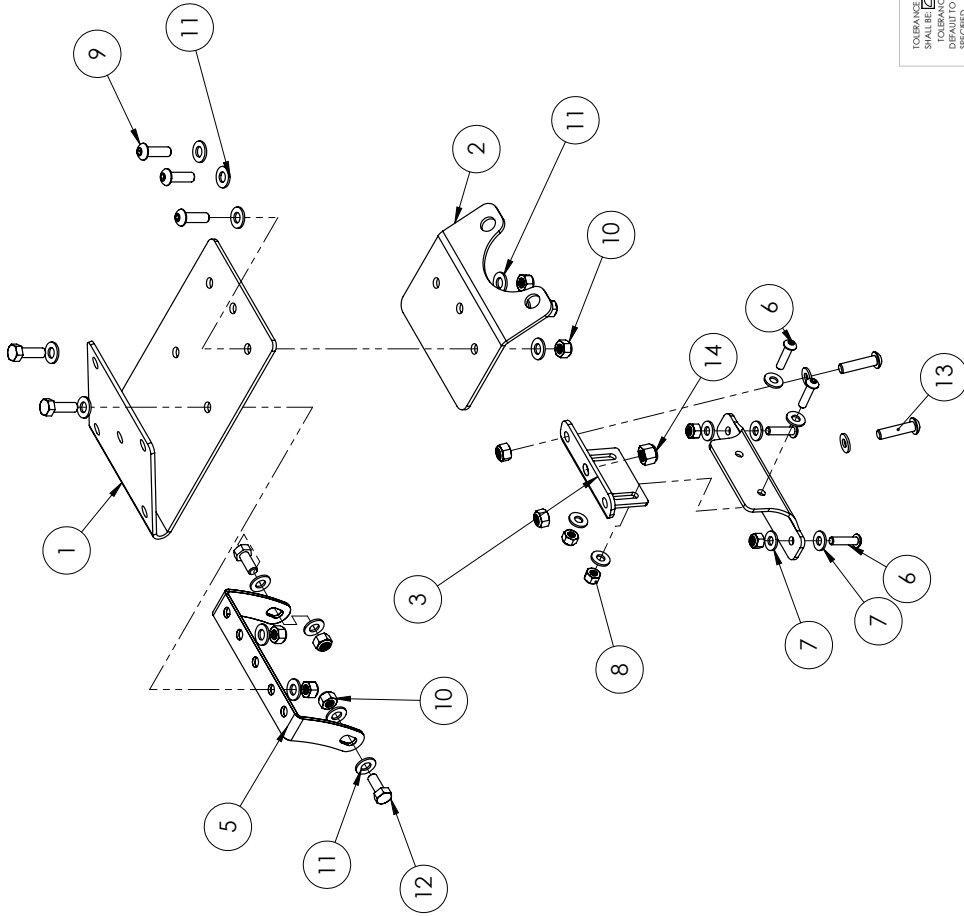

B

A

1

2

3

4

Paul Yaffe Bigger Nation

TITLE: Sharknado Sport Glide Bracket Kit

NAME	DATE
J. Eichmann	5/11/2020

DRAWN	CHECKED	ENG APPR.	MFG APPR.	Q.A.

UNLESS OTHERWISE SPECIFIED:
 DIMENSIONS ARE IN INCHES
 TOLERANCES ARE:
 FRACTIONS ±.010
 DECIMALS ±.010
 ANGULAR: MACH ±.5°
 BEND ±.5°
 TWO PLACE DECIMAL ±.010
 THREE PLACE DECIMAL ±.005

INTERPRET GEOMETRIC TOLERANCING PER: ANSI Y14.5

PROPERTY AND CONFIDENTIAL
 THIS DRAWING IS THE SOLE PROPERTY OF PAUL YAFFE ORIGINALS AND PAUL YAFFE DESIGNS INC. ANY REPRODUCTION OR DISTRIBUTION OF THIS DRAWING WITHOUT THE WRITTEN PERMISSION OF PAUL YAFFE ORIGINALS AND PAUL YAFFE DESIGNS INC. IS PROHIBITED.

COMMENTS:
 BREAK ALL SHARP EDGES .010-.020

SCALE: 1:4 **WEIGHT:** SHEET 1 OF 1

REV
 SUB-SS-GBK **B**

B

A



**SHARKNADO**
F A I R I N G

Paul Yaffé's
Bagger
Nation™

602.840.4205
BAGGERNATION.COM